

6" CDL 21W TITANIUM LED SERIES



PRO



Patent Pending

- For new construction installation
- Universal housing compatibility – IC-Rated
- Adjustable lumen output – 3 defined light levels
- Easy fit installation – Spring-action housing clips
- Universal voltage 120-277V
- Available in 2700K, 3000K, 3500K & 4000K CCT

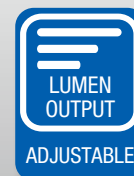

DOWNLIGHT PRODUCT FEATURES

Adjustable Lumen Output



Fluorescent Equivalence Table		
Power	Lumens	Equivalent
LOW-8.5W	700	1X18W
MED-13.5W	1000	1X26W / 2X13W
HIGH-21W	1500	1X32W / 2X18W

This downlight features adjustable lumen output for three distinct lumen levels equivalent to various CFL lamp combinations. Simply adjust the lamp power to the desired lumen output by sliding the selector switch on top of the fixture.

Easy-Fit Installation

The adjustable housing clips allow for installation in a large range of commercial and architectural housings ranging from 6.0"-7.4" (153-190mm). These spring-action clips push up easily and fit securely for both retrofit and new construction installations.

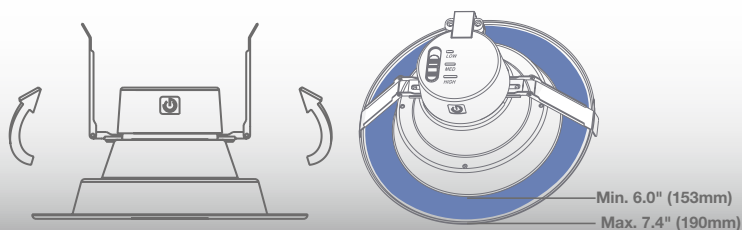

SIMPLE RETROFIT OR ECONOMICAL NEW CONSTRUCTION INSTALLATION

Retrofit Installation

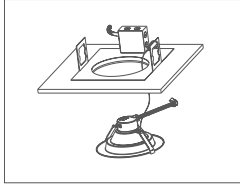

Attach safety clip

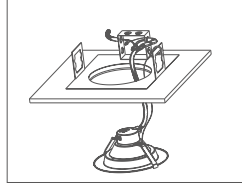

Bypass ballast & wire to j-box

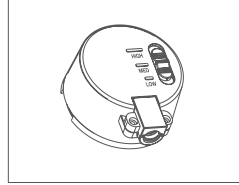

Adjust lumens to desired output

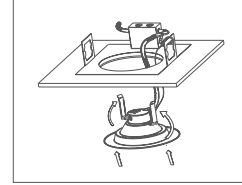

Push clips up & install into fixture

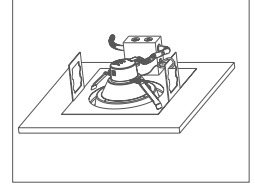

Ensure fixture is flush. Installation is complete

New Construction Installation

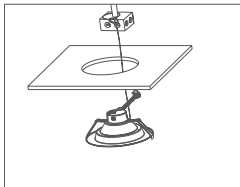

Attach safety clip

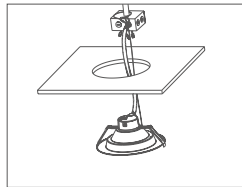

Wire to j-box

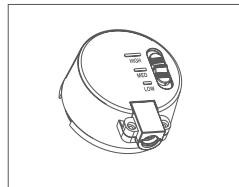

Adjust lumens to desired output

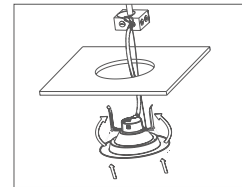

Push clips up & install into opening

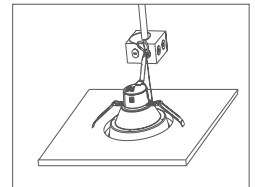

Ensure fixture is flush. Installation is complete

SPECIFICATIONS

Product Model	57868 21CDLA6/827/277V/R	57869 21CDLA6/830/277V/R	57870 21CDLA6/835/277V/R	57871 21CDLA6/840/277V/R
Type	6" Downlight	6" Downlight	6" Downlight	6" Downlight
Power (W)	8.5 / 13.5 / 21	8.5 / 13.5 / 21	8.5 / 13.5 / 21	8.5 / 13.5 / 21
Voltage - Frequency	120-277V 60Hz	120-277V 60Hz	120-277V 60Hz	120-277V 60Hz
Color Temp. (ANSI)	Soft White 2700K	Warm White 3000K	Neutral White 3500K	Cool White 4000K
CRI (Ra) (typ.)	80	80	80	80
Typical lumens (lm)	650 / 930 / 1400	700 / 1000 / 1500	700 / 1000 / 1500	700 / 1000 / 1500
Efficacy (LPW)	76 / 69 / 67	82 / 74 / 71	82 / 74 / 71	82 / 74 / 71
Beam Angle	110°	110°	110°	110°
Dimmable	No	No	No	No
Power Factor	0.9	0.9	0.9	0.9
Temperature Rating	-13°F/-25°C - 95°F/35°C	-13°F/-25°C - 95°F/35°C	-13°F/-25°C - 95°F/35°C	-13°F/-25°C - 95°F/35°C
Rated Lifetime - L70 (hrs.)	40,000	40,000	40,000	40,000
Dia. x MOL	8.27"x4.02" (210x102mm)	8.27"x4.02" (210x102mm)	8.27"x4.02" (210x102mm)	8.27"x4.02" (210x102mm)
Weight (lb. / g)	1.24lb / 562g	1.24lb / 562g	1.24lb / 562g	1.24lb / 562g

* Suitable for damp locations. Not for use where directly exposed to weather or water

** Full installation guide and more details available on website