



# Core & Coil (71A) MH < 175W

CORE & COIL HID MH BAL 100W M90/140 480V/120T C&C

The basic ballast is the open core and coil which is most often used as a component within a lighting luminaire. The core and coil also forms the nucleus of Philips Advance's five other ballast configurations.

## Product data

### • General Characteristics

Lamp Type	100 MH
Number of Lamps	1 piece
Line Voltage	480 V
Input Current (Operating)	0.3 A
Line Frequency	60 Hz
Circuit Type	HX-HPF
Ballast Type	Magnetic HID
Base Model	71A5340T
Core Size	3 X 4 (2 coil)
Suitable for Outdoor use?	Yes
Ignitor Catalog Number	LI533-H4
Ignitor Temp Rating	105°C
Capacitor value [µF]	10 MFD
Capacitor Catalog Number	7C100M30RA
Capacitor Requirements	300V
Capacitor Temp Rating	105°C
Capacitor Dia/Oval Dim	1.65 in
Capacitor Height	2.75 in
Family Name	Core & Coil MH

### • Operating Characteristics

Automatic restart	No
Input Voltage at Lamp Dropout	340 V
Nominal Open Circuit Voltage	260 V
Inp. Current (Open Circuit)	0.55 A

Input Current (Starting)	0.3 A
Input Current Short Circuit	0.24-0.36 A
Secondary ShortCircuit Current	1.35-1.65 A
Input Power Gear	132 W
Constant wattage deviation	12%
Ballast factor	1 -
Power Factor	0.90

### • Wiring Characteristics

Wire Striplength	0.5 mm
Wire Length by Color	12"
Wire Type	Stranded
Allowed Wiring Config(Remote)	Yes
Max Dist. Ball to Lamp(Remote)	25'
Recommended Fuse	2 A

### • System Chars on driver level

Rated Lamp Watts	100W
------------------	------

### • Product Dimensions

Length A1	3.9 in
Length A2	3.5 in
Width B1	2.8 in
Coil Depth C1	2.9 in
Stack Height C2	1.7 in
Width B2	2.4 in

**PHILIPS**

# Core & Coil (71A) MH < 175W

• Approval & Application Chars

Approbation Marks	CSA, RoHS
CE marking	No
VDE certificate	No
UL Listed	No
CSA certificate	No
CCC certificate	No
Chia Quality Certificate	No
Temperature marking	C
CEC Listing	No
cUL certificate	No
EISA	No
ETL Certificate	No
FIDE Certificate	No
NOM certificate	No
RoHS Compliant	Yes
SASO Certificate	No
UL Recognized	Yes
ANSI Code	M90/M140
HiPot Test (1 minute)	2000 V

HiPot Test (2 seconds)	2500 V
Open Circ Voltage Test (Volts)	234-286 V
UL Insulation Class	H(180°C)
UL Temperature Code	1029C

• Product Data

Product number	71A5340500DT
Full product name	MH BAL 100W M90/140 480V/120T C&C
Short product name	MH BAL 100W M90/140 480V/120T C&C
Pieces per Sku	1
Skus/Case	6
Bar code on pack	781087094099
Bar code on case	50781087094094
Logistics code(s)	913700532809
eop_net_weight_pp	2.627 kg

Dimensional drawing

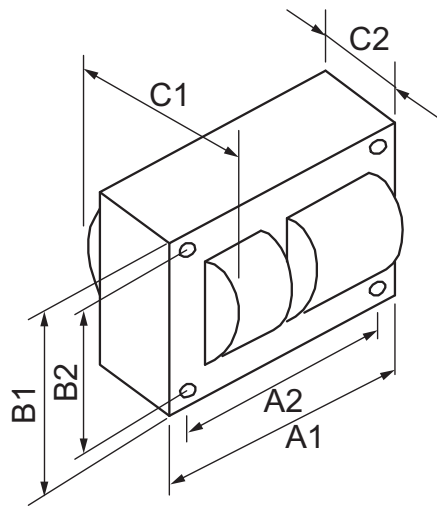

CORE & COIL HID MH BAL 100W M90/140 480V/120T C&C

Product	A1 (Norm)	A2 (Norm)	B1 (Norm)	B2 (Norm)	C1 (Norm)	C2 (Norm)
MH BAL 100W M90/140 480V/120T C&C	3.9	3.5	2.8	2.4	2.9	1.7

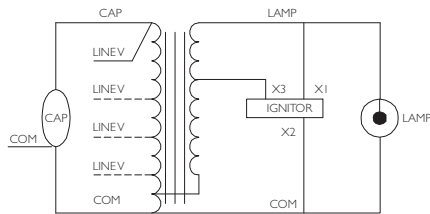



© 2014 Koninklijke Philips N.V. (Royal Philips)  
All rights reserved.

Specifications are subject to change without notice. Trademarks are the property of  
Koninklijke Philips N.V. (Royal Philips) or their respective owners.

[www.philips.com/lighting](http://www.philips.com/lighting)

2014, March 26  
data subject to change