

# Core & Coil (71A) MH 175W - 450W

CORE & COIL HID MH BAL 175W M137/152 480V/120T C&C

The basic ballast is the open core and coil which is most often used as a component within a lighting luminaire. The core and coil also forms the nucleus of Philips Advance's five other ballast configurations.

## Product data

### • General Information

ANSI Code	M137/M152
Lamp Type	175W MH
Number of Lamps	1 piece/unit
Circuit Type	SUPER-CWA
Ballast Type	Magnetic HID
Base Model	71A5543TEE
Core Size	3 X 4 (2 coil)
Suitable For Outdoor Use	Yes
Ignitor Catalog Number	LI533-H4
Ignitor Temperature Rating	105°C
Capacitor Value	11 MFD
Capacitor Catalog Number	7C110M40
Capacitor Requirements	370V
Capacitor Temperature Rating	105°C
Capacitor Diameter/ Oval Dimensions	1.65 in
Capacitor Height	3.75 in
Automatic Restart	No

### • Operating and Electrical

Input Voltage	480/120T V
Input Frequency	60 Hz
Inp. Current (Open Circuit)	0.44 A
Input Current (Starting)	0.14 A
Input Current (Short Circuit)	0.11-0.17 A

Secondary Short Circuit Current	1.6-1.95 A
Constant Wattage Deviation	10%
Ballast Factor (Nom)	1
Power Factor (Nom)	0.90
Nominal Open Circuit Voltage	275 V
Input Current (Operating) (Nom)	0.44 A A
Input Power (Nom)	198 W
Rated Lamp Watts	175W W

### • Wiring

Wire Striplength	0.5 mm
Wire Length By Color	12"
Wire Type	Stranded
Remote Wiring Configuration Allowed	Yes
Max Ballast-Lamp Distance Remote Wiring	2'
Recommended Fuse Value	2 A

### • Approval and Application

Open Circuit Voltage Test (Volts)	250-300 V
Approbation Marks	ULR CSA certificate EISA RoHS Compliant

**PHILIPS**

## Core & Coil (71A) MH 175W - 450W

Temperature Marking	A
UL Recognized	Yes
Hipot Test (1 Minute)	2000 V
Hipot Test (2 Seconds)	2500 V
UL Insulation Class	H(180°C)
UL Temperature Code	1029A

### • Product Data

Order product name	CORE & COIL HID
	71A5543500DTEE
EAN/UPC - Product	781087070277
Order code	71A5543500DTEE
Numerator - Quantity Per Pack	1
Numerator - Packs per outer box	4
Material Nr. (12NC)	913710665002
Net Weight (Piece)	4.550 kg

### Dimensional drawing

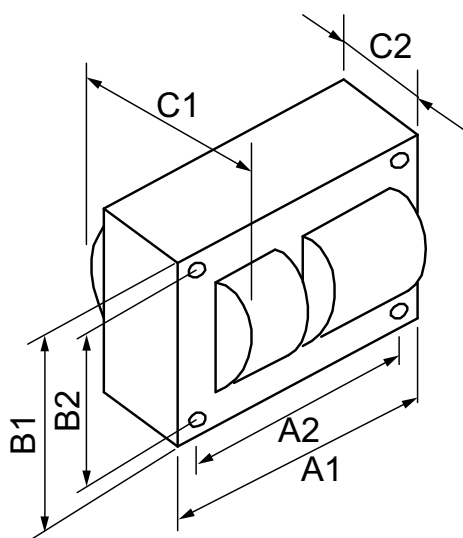

### MH BAL 175 M137/152 480V/120T C&C

Product	C1	C2	A1	A2	B1	B2
CORE & COIL HID 71A5543500DTEE	4.20 in	3.10 in	3.9 in	3.5 in	2.8 in	2.4 in

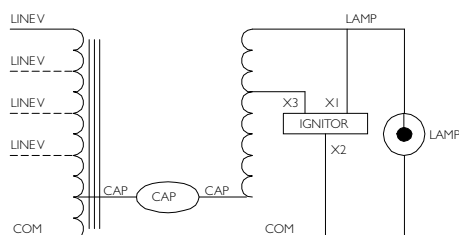

© 2016 Philips Lighting Holding B.V.  
All rights reserved.

Specifications are subject to change without notice. Trademarks are the property of Koninklijke Philips N.V. (Royal Philips) or their respective owners.

[www.philips.com/lighting](http://www.philips.com/lighting)

2016, February 1  
data subject to change