



# Transformers

## AUTO-TRANSFORMER AUTOXFMR 277:115 300VA JBOX

Stepdown transformers and autotransformers are used when you need to connect a lower voltage device to a higher voltage source.

### Product data

#### • General Information

Circuit Type	Transformer
Ballast Type	Magnetic HID
Base Model	71A9741J
Core Size	7/8" E/I
Suitable For Outdoor Use	Yes

#### • Operating and Electrical

Input Voltage	277:120 or 120:277 V
Input Frequency	60 Hz
Input Current (Operating) (Nom)	1.1 A
Rated Lamp Watts	300 VA load W

#### • Wiring

Wire Striplength	0.5 mm
Wire Length By Color	8-1/2"
Wire Type	Stranded
Remote Wiring Configuration Allowed	Yes

#### • Mechanical and Housing

Housing Material	Metal
------------------	-------

Housing	Coil cover with 1/2" nipple
Housing Dimensions	4.0" x 2.19" x 2.63"

#### • Approval and Application

Approbation Marks	ULR RoHS Compliant
Temperature Marking	Thermally protected
UL Recognized	Yes
UL Insulation Class	H(180°C)
UL Temperature Code	NA

#### • Product Data

Order product name	AUTO-TRANSFORMER 71A9741600J
EAN/UPC - Product	781087042601
Order code	71A9741600J
Numerator - Quantity Per Pack	1
Numerator - Packs per outer box	16
Material Nr. (12NC)	913710559502
Net Weight (Piece)	1.575 kg

**PHILIPS**

## Dimensional drawing

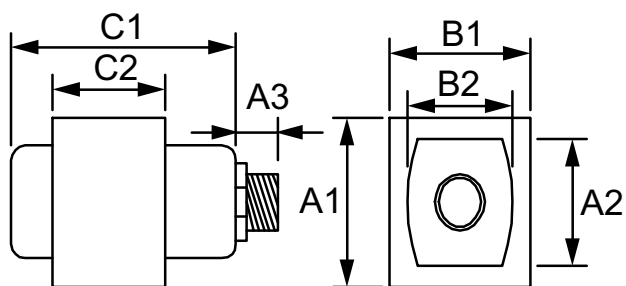

### AUTOXFMR 277:115 300VA JBOX

Product	C1	C2	A1	A2	B1	B2
AUTO-TRANSFORMER 71A9741600J	4 in	2 in	2.63 in	1.81 in	2.19 in	1.84 in

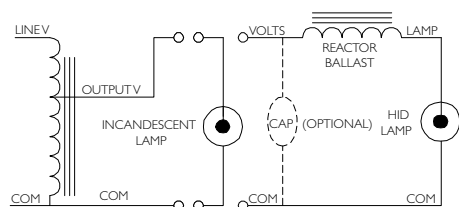

© 2016 Philips Lighting Holding B.V.  
All rights reserved.

Specifications are subject to change without notice. Trademarks are the property of Koninklijke Philips N.V. (Royal Philips) or their respective owners.

[www.philips.com/lighting](http://www.philips.com/lighting)

2016, February 1  
data subject to change