

LED DRIVER DC CC, POTTED
LED 18 DC 350mA BF Ver.1
LED 18 DC 700mA BF Ver.1
LED 36 DC 700mA BF Ver.1

LED

Features

1. Dimmable with Trailing Edge dimmers
2. Designed for IP67
3. Reinforced insulation from input to output
4. High efficiency
5. PFC: > 0.95
6. Fully protected: Short circuit, Input voltage surge, Thermal, Secondary switch Overload regulation, Over voltage protection. Self-resettable
7. AC/DC

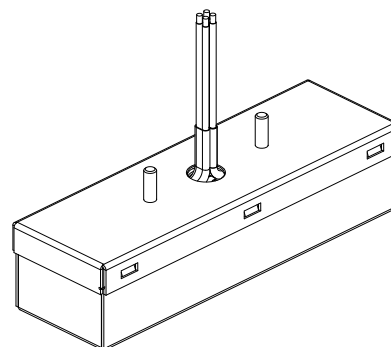

Applications

1. Led in- and outdoor lighting
2. Street lighting
3. Architectural lighting
4. Signage
5. Indication and orientation lighting
6. Ambience lighting

Class 2

Specifications

VERSION		18W 350mA Bottom Feed	18W 700mA Bottom Feed	36W 700mA Bottom Feed
SKU No.		901018350BF	901018700BF	901036700BF
INPUT	VOLTAGE RANGE (V)	120-277	120-277	120-277
	FREQUENCY RANGE (Hz)	50/60	50/60	50/60
	POWER FACTOR	0.99	0.97	0.99
	EFFICIENCY (Typ.)%	85-88	83-84	88-89
	AC CURRENT (A)	0.17-0.09	0.17-0.09	0.35-0.15
	INRUSH CURRENT (A)	-	-	-
OUTPUT	VOLTAGE (V) Note 3	4-52	4-26	4-52
	CURRENT (A) Note 3	0.35	0.7	0.7
	RATED POWER (W)	18	18	36
DIMMABLE	REVERSE PHASE CONTROL (TRAILING EDGE)	10% *	10% *	10% *
PROTECTION	INPUT VOLTAGE SURGE	YES	YES	YES
	OVER TEMPERATURE	YES	YES	YES
	SHORT CIRCUIT PROTECTION	YES	YES	YES
	REINFORCED INSULATION	YES	YES	YES
ENVIRONMENT	Ta (°C)	-25...+50	-25...+50	-25...+50
	Tc (°C)	90	90	90
	WORKING HUMIDITY	OUTDOOR	OUTDOOR	OUTDOOR
	STORAGE TEMP. (°C)	-10...+70	-10...+70	-10...+70
STANDARDS	VDE SAFETY	N/A		
	VDE EMC	N/A		
	UL	E322460	E322460	E322460
MECHANICAL	PLASTIC/ METAL CASE	METAL	METAL	METAL
	INPUT WIRES COLOR	BLK/WHT	BLK/WHT	BLK/WHT
	INPUT WIRES SIZE	18AWG	18AWG	18AWG
	OUTPUT WIRE COLOR	BLK/RED	BLK/RED	BLK/RED
	OUTPUT WIRE SIZE	18AWG	18AWG	18AWG
	WEIGHT	0.28kg		
NOTE	1. All parameters are measured at rated input, rated load and 25°C of ambient temperature.			
	2. Specifications may vary from time to time without notice.			
	3. Tolerance: includes set up tolerance, line regulation and load regulation.			
	4. Subject to standard warranty, terms and conditions as published from time to time.			
	5. * Tested with Lightech recommended dimmers. Contact your sales representative for further details.			

LED 18 DC 350mA BF Ver.1
LED 18 DC 700mA BF Ver.1
LED 36 DC 700mA BF Ver.1

Mechanical Drawing

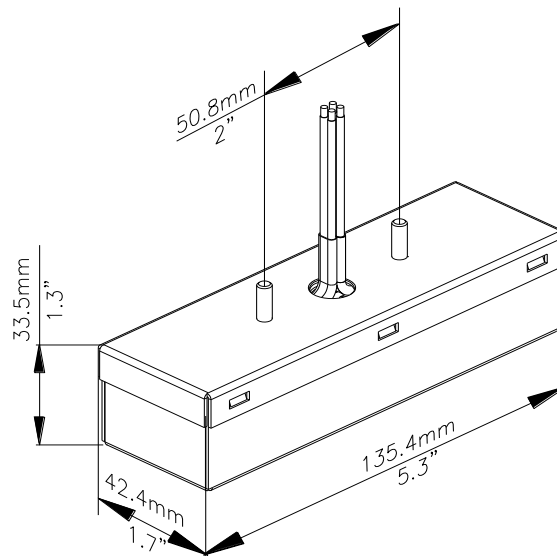

Mounting Instructions

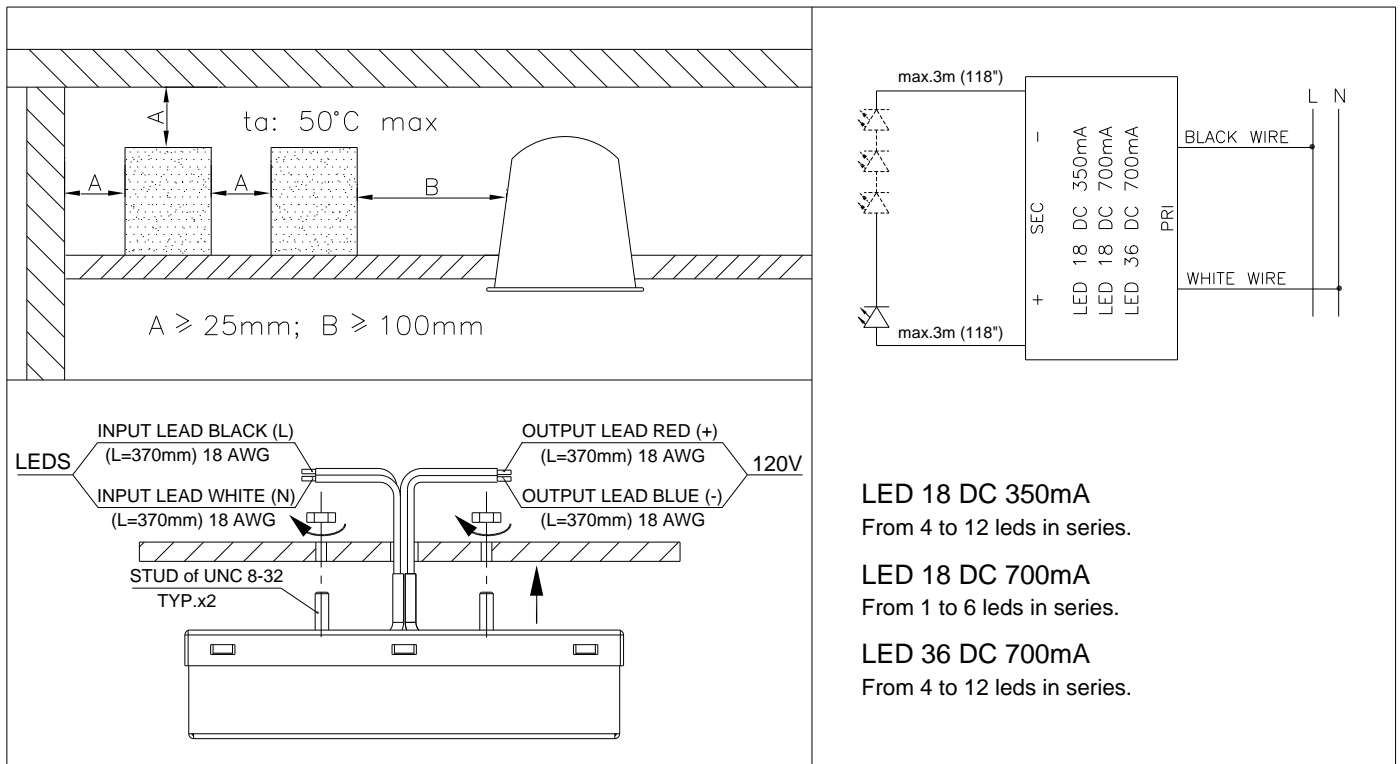

Safety Instructions

1. Always disconnect power before installation and/or removal of the unit.
2. Install in accordance with national and local electrical codes.