

Presented By: Candela Corporation
Contact Phone: 800-922-9226
Contact E-mail: sales@candelacorp.com

Customer Name:
Project Name:
Fixture Type:



GE
Lighting

26969 - 1157

GE S8 - Automotive

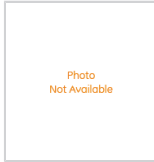
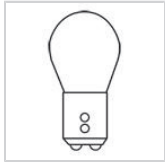
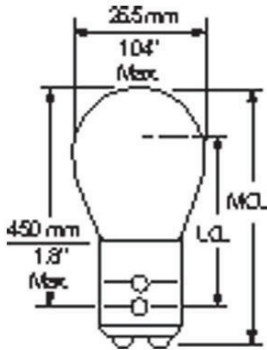

GENERAL CHARACTERISTICS

Lamp Type	Miniature - S Shape
Bulb	S8
Base	Double Contact Index (BAY15d)
Filament	C-6/C-6
Rated Life (MIN)	27.0/8.0 h
Rated Life (Vert)	1200.0 / 5000.0 h
Rated Life (NOM)	1200.0/5000.0 h
Rated Life (Hor)	27.0 / 8.0 h
Atmosphere	Gas-filled
Primary Application	Turn Signal, Rear;Back up;Cornering;High Mount Stop;License Plate;Parking;Sidemarker, Front;Sidemarker, Rear;Stop;Tail;Turn Signal, Front

PHOTOMETRIC CHARACTERISTICS

Initial Lumens (Vert)	402.0 / 38.0
Initial Lumens (NOM)	402.0 / 38.0
Initial Lumens (Hor)	14.88889 / 4.75
Nominal Initial Lumens per Watt (NOM)	14.88889 / 4.75
Center Beam Candlepower (CBCP) (NOM)	402.0 / 38.0
Mean Spherical Candlepower (MSCP) (NOM)	32.0 / 3.0

ELECTRICAL CHARACTERISTICS

Wattage (NOM)	27.0
Voltage (MIN)	1200.0
Voltage (NOM)	12.8

DIMENSIONS

Maximum Overall Length (MOL) (NOM)	2.000 in(50.8 mm)
Bulb Diameter (DIA) (NOM)	1.000 in(25.4 mm)
Light Center Length (LCL) (NOM)	1.250 in(31.8 mm)

PRODUCT INFORMATION

Product Code	26969
Description	1157
ANSI Code	1157
Standard Package	Case
Standard Package GTIN	00043168269698
Standard Package Quantity	50
Sales Unit	Unit
No Of Items Per Sales Unit	1
No Of Items Per Standard Package	50
UPC	043168960359