

**Presented By:** Candela Corporation  
Contact Phone: 800-922-9226  
Contact E-mail: sales@candelacorp.com

Customer Name:  
Project Name:  
Fixture Type:



GE  
Lighting

**44760 - 2057**

GE S8 - Automotive

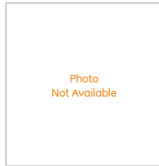
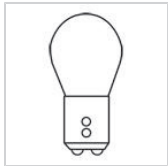
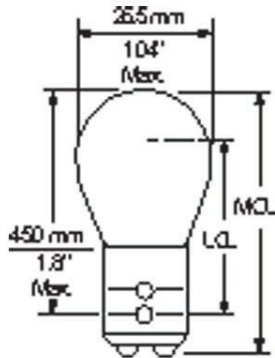

### GENERAL CHARACTERISTICS

Lamp Type	Miniature - S Shape
Bulb	S8
Base	Double Contact Index (BAY15d)
Filament	C-6/C-6
Rated Life (NOM)	1200.0/5000.0 h
Atmosphere	Gas-filled
Primary Application	Turn Signal, Rear; Back up; Cornering; Fog/Driving; High Mount Stop; License Plate; Parking; Sidemarker, Front; Sidemarker, Rear; Stop; Tail; Turn Signal, Front

### PHOTOMETRIC CHARACTERISTICS

Initial Lumens (NOM)	402.0 /25.0
Nominal Initial Lumens per Watt (NOM)	14.88889 /3.571429
Mean Spherical Candlepower (MSCP) (NOM)	32.0 /2.0

### ELECTRICAL CHARACTERISTICS

Wattage (NOM)	27.0
Voltage (NOM)	12.8

### DIMENSIONS

Maximum Overall Length (MOL) (NOM)	2.000 in(50.8 mm)
Bulb Diameter (DIA) (NOM)	1.000 in(25.4 mm)
Light Center Length (LCL) (NOM)	1.250 in(31.8 mm)

### PRODUCT INFORMATION

Product Code	44760
Description	2057
ANSI Code	2057
Standard Package	Case
Standard Package GTIN	20043168447601
Standard Package Quantity	50
Sales Unit	Unit
No Of Items Per Sales Unit	1
No Of Items Per Standard Package	50
UPC	043168447607