

| REV | ECN NO | REVISIONS | DRN | CKD | APP | DATE |
|-----|--------|--|-----|-----|-----|---------|
| A | | NEW RELEASE | AJF | KLJ | CJC | 1-21-10 |
| B | | ADDED P/MS: 507-5164-3337-500F, 507-5164-3737-500F, 507-5166-3337-500F, 507-5166-3737-500F, 507-5167-3337-500F, 507-5168-3337-500F, 507-5167-3737-500F, 507-5168-3737-500F | AJF | KLJ | CJC | 5-27-10 |

RoHS COMPLIANT 507-XXXX-3X3X-500F
 Part Numbers with the "E" suffix ending are RoHS Compliant.
 For example: 507-4756-3331-500F
 Packaging is marked with "RoHS Compliant" label or equivalent markings.

FIG. 1
(CYLINDRICAL LENS)

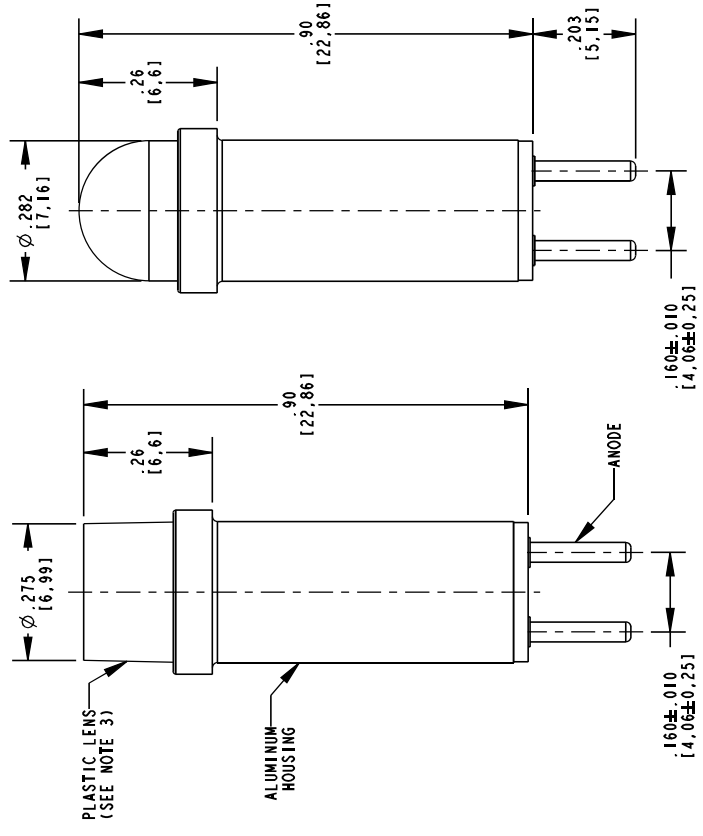
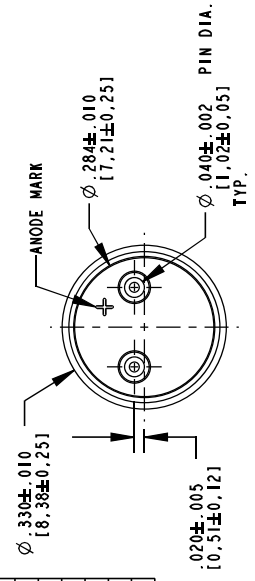
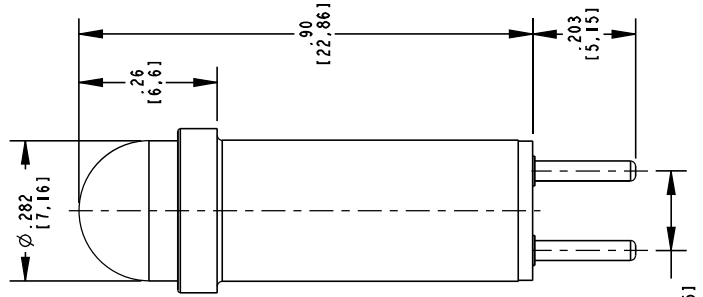

FIG. 2
(STOVEPIPE LENS)



| DIAL LIGHT PART NUMBER | COLOR | VOLTAGE | LENS |
|------------------------|--------|---------|--------|
| 507-4756-3331-500F | RED | 3.6 VDC | FIG. 1 |
| 507-4756-3731-500F | RED | 3.6 VDC | FIG. 2 |
| 507-4757-3331-500F | RED | 5 VDC | FIG. 1 |
| 507-4757-3731-500F | RED | 5 VDC | FIG. 2 |
| 507-4759-3331-500F | RED | 10 VDC | FIG. 1 |
| 507-4759-3731-500F | RED | 10 VDC | FIG. 2 |
| 507-4760-3331-500F | RED | 14 VDC | FIG. 1 |
| 507-4760-3731-500F | RED | 14 VDC | FIG. 2 |
| 507-4761-3331-500F | RED | 28 VDC | FIG. 1 |
| 507-4761-3731-500F | RED | 28 VDC | FIG. 2 |
| 507-4856-3332-500F | GREEN | 3.6 VDC | FIG. 1 |
| 507-4856-3732-500F | GREEN | 3.6 VDC | FIG. 2 |
| 507-4857-3332-500F | GREEN | 5 VDC | FIG. 1 |
| 507-4857-3732-500F | GREEN | 5 VDC | FIG. 2 |
| 507-4859-3332-500F | GREEN | 10 VDC | FIG. 1 |
| 507-4859-3732-500F | GREEN | 10 VDC | FIG. 2 |
| 507-4860-3332-500F | GREEN | 14 VDC | FIG. 1 |
| 507-4860-3732-500F | GREEN | 14 VDC | FIG. 2 |
| 507-4861-3332-500F | GREEN | 28 VDC | FIG. 1 |
| 507-4861-3732-500F | GREEN | 28 VDC | FIG. 2 |
| 507-4956-3333-500F | YELLOW | 3.6 VDC | FIG. 1 |
| 507-4956-3733-500F | YELLOW | 3.6 VDC | FIG. 2 |
| 507-4957-3333-500F | YELLOW | 5 VDC | FIG. 1 |
| 507-4957-3733-500F | YELLOW | 5 VDC | FIG. 2 |
| 507-4959-3333-500F | YELLOW | 10 VDC | FIG. 1 |
| 507-4959-3733-500F | YELLOW | 10 VDC | FIG. 2 |
| 507-4960-3333-500F | YELLOW | 14 VDC | FIG. 1 |
| 507-4960-3733-500F | YELLOW | 14 VDC | FIG. 2 |
| 507-4961-3333-500F | YELLOW | 28 VDC | FIG. 1 |
| 507-4961-3733-500F | YELLOW | 28 VDC | FIG. 2 |
| 507-5062-3734-500F | BLUE | 3 VDC | FIG. 1 |
| 507-5062-3734-500F | BLUE | 3 VDC | FIG. 2 |
| 507-5064-3334-500F | BLUE | 5 VDC | FIG. 1 |
| 507-5064-3734-500F | BLUE | 5 VDC | FIG. 2 |
| 507-5066-3334-500F | BLUE | 10 VDC | FIG. 1 |
| 507-5066-3734-500F | BLUE | 10 VDC | FIG. 2 |
| 507-5067-3334-500F | BLUE | 14 VDC | FIG. 1 |
| 507-5067-3734-500F | BLUE | 14 VDC | FIG. 2 |
| 507-5068-3334-500F | BLUE | 28 VDC | FIG. 1 |
| 507-5068-3734-500F | BLUE | 28 VDC | FIG. 2 |
| 507-5164-3337-500F | WHITE | 5 VDC | FIG. 1 |
| 507-5164-3737-500F | WHITE | 5 VDC | FIG. 2 |
| 507-5166-3337-500F | WHITE | 10 VDC | FIG. 1 |
| 507-5166-3737-500F | WHITE | 10 VDC | FIG. 2 |
| 507-5167-3337-500F | WHITE | 14 VDC | FIG. 1 |
| 507-5167-3737-500F | WHITE | 14 VDC | FIG. 2 |
| 507-5168-3337-500F | WHITE | 28 VDC | FIG. 1 |
| 507-5168-3737-500F | WHITE | 28 VDC | FIG. 2 |

NOTES:

- POLARITY OF LAMP IS CRITICAL.
- THE RATED VOLTAGE IS NOT TO BE EXCEEDED BY MORE THAN 5% IN ORDER TO AVOID DAMAGE TO LAMP.
- LENS CONTAINS AN INTERNAL FRESNEL RING PATTERN TO ASSURE MAXIMUM LIGHT OUTPUT.
- DIAL LIGHT PART NUMBER 507-XXXX-3X3X-500F.
- PART CAN BE USED WITH DIALIGHT 250 AND 508 SERIES HOLDERS FOR .375" MOUNTING HOLE OR 515 SERIES CONNECTORS FOR 9/32" MOUNTING HOLE.
- THIS ASSEMBLY CONTAINS ELECTROSTATIC DISCHARGE SENSITIVE DEVICES (ESDs). MAINTAIN ALL PRECAUTIONARY MEASURES DURING ASSEMBLY, HANDLING, AND STORAGE IN ACCORDANCE WITH IPC-A-610.



| | |
|---|-----------------------------|
| THIS DRAWING AND THE CONTENTS HEREIN ARE CONFIDENTIAL AND THE SOLE PROPERTY OF DIALIGHT. REPRODUCTION OF THIS DRAWING OR CONSTRUCTION OF ANY PARTS WITHIN THIS DRAWING ARE FORBIDDEN WITHOUT THE WRITTEN CONSENT OF DIALIGHT. | |
| SCALE: 4:000 | DRAWING NUMBER |
| ALL DIM'S IN: INCHES (UM) | C-17811 |
| TOLERANCES: UNLESS OTHERWISE SPECIFIED | REV |
| FRACTIONS: ±1/64 | B |
| DECIMALS (.XXX): ±.02 | TITLE |
| DECIMALS (.XXX): ±.015 | 507 LED DATALAMP CARTRIDGES |
| ANGLES: ±3° | MATERIAL |
| FINISH: #3 | |
| FSCM 83330 | |
| Dialight 1501 ROUTE 34 SOUTH FARMINGDALE, NJ 07127 | |
| SHEET 1 OF 1 FAMILY TABLE: | |