

T8 Medium Bi Pin

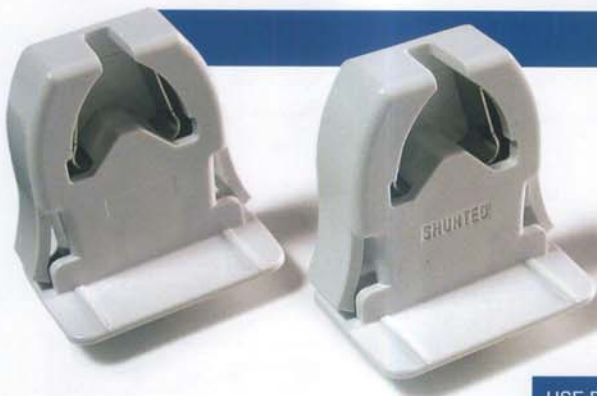

999
T8 LAMPS

APPROX. .030 - .060 PANEL THICKNESS
(CUSTOMER TO DETERMINE FIT)

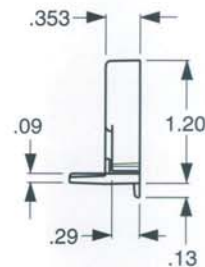
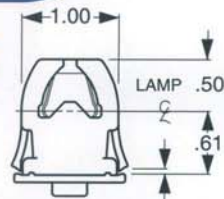

SHUNTED
VERSION

WIRE PORTS
BLOCKED OFF

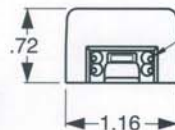

ACCEPTS 2 WIRES
PER TERMINAL

USE PANEL
CUTOUT #3

Lamp Connectors



709, 709-1, 709-3

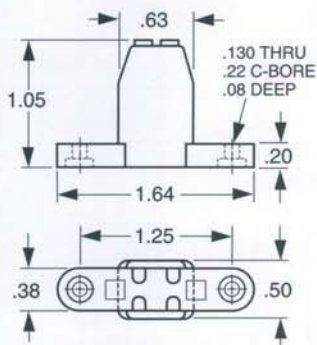

709 2-HOLE MOUNT

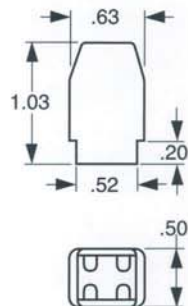

709-1 NO MOUNT

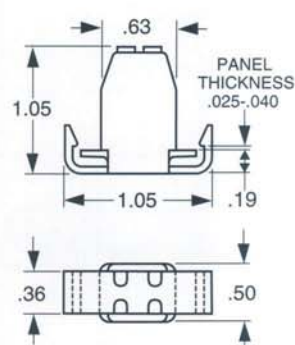

709-3 SNAP-IN MOUNT

USE PANEL
CUTOUT #9

709-2, 709-7, 709-8

ALL DIMENSIONS SAME AS 709-7 EXCEPT AS SHOWN

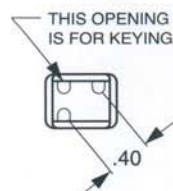

709-2 NO MOUNT

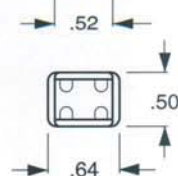
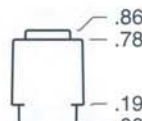

709-7 NO MOUNT

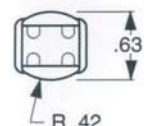

709-8 NO MOUNT