



# Core & Coil (71A) MH 175W - 450W

CORE & COIL HID MH BAL 175W M57 QUAD C&C

The basic ballast is the open core and coil which is most often used as a component within a lighting luminaire. The core and coil also forms the nucleus of Philips Advance's five other ballast configurations.

## Product data

### • General Characteristics

Lamp Type	175/150W MH
Number of Lamps	1 piece
Line Voltage	120/208/240/277 V
Input Current (Operating)	1.8/1.04/0.9/0.8 A
Line Frequency	60 Hz
Circuit Type	CWA
Ballast Type	Magnetic HID
Base Model	71A5590
Core Size	3 X 4 (2 LW)
Suitable for Outdoor use?	Yes
Ignitor Catalog Number	NA
Ignitor Temp Rating	NA
Capacitor value [ $\mu$ F]	10 MFD
Capacitor Catalog Number	7C100M40R
Capacitor Requirements	400V
Capacitor Temp Rating	105°C
Capacitor Dia/Oval Dim	1.45 in
Capacitor Height	3.75 in
Family Name	Core & Coil MH

### • Operating Characteristics

Automatic restart	No
Input Voltage at Lamp Dropout	60/104/120/138 V
Nominal Open Circuit Voltage	305 V
Inp. Current (Open Circuit)	1.78/1.08/0.93/0.81 A

Input Current (Starting)	1.26/0.7/0.61/0.53 A
Input Current Short Circuit	1.06-1.59/0.6-0.9/0.52-0.78/0.45-0.67 A
Secondary ShortCircuit Current	1.5-1.9 A
Input Power Gear	210 W
Constant wattage deviation	10%
Ballast factor	1 -
Power Factor	0.90

### • Wiring Characteristics

Wire Striplength	0.5 mm
Wire Length by Color	12"
Wire Type	Stranded
Allowed Wiring Config(Remote)	Yes
Max Dist. Ball to Lamp(Remote)	Determined by AWG used
Recommended Fuse	5/3/3/2 A

### • System Chars on driver level

Rated Lamp Watts	175/150W
------------------	----------

### • Product Dimensions

Length A1	3.9 in
Length A2	3.5 in
Width B1	2.8 in
Coil Depth C1	3.95 in
Stack Height C2	2.42 in
Width B2	2.4 in

**PHILIPS**

# Core & Coil (71A) MH 175W - 450W

## • Approval & Application Chars

Approbation Marks	ULR, CSA, RoHS
CE marking	No
VDE certificate	No
UL Listed	No
CSA certificate	Yes
CCC certificate	No
Chia Quality Certificate	No
Temperature marking	C/D/D/D
CEC Listing	No
cUL certificate	No
EISA	No
ETL Certificate	No
FIDE Certificate	No
NOM certificate	No
RoHS Compliant	Yes
SASO Certificate	No
UL Recognized	Yes
ANSI Code	M57/M107

HiPot Test (1 minute)	2000 V
HiPot Test (2 seconds)	2500 V
Open Circ Voltage Test (Volts)	275-335 V
UL Insulation Class	H(180°C)
UL Temperature Code	1029D

## • Product Data

Product number	71A5590500D
Full product name	MH BAL 175W M57 QUAD C&C
Short product name	MH BAL 175W M57 QUAD C&C
Pieces per Sku	1
Skus/Case	6
Bar code on pack	781087097892
Bar code on case	50781087097897
Logistics code(s)	913700572909
eop_net_weight_pp	3.180 kg

## Dimensional drawing

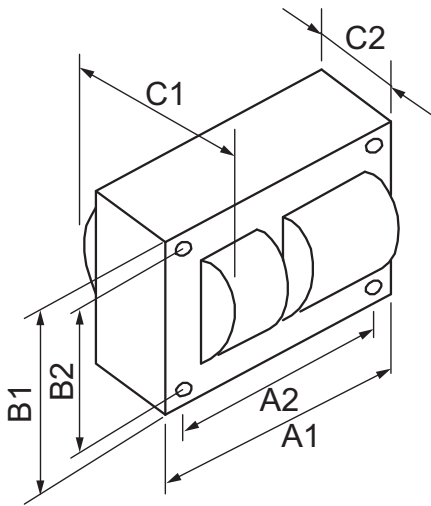

## CORE & COIL HID MH BAL 175W M57 QUAD C&C

Product	A1 (Norm)	A2 (Norm)	B1 (Norm)	B2 (Norm)	C1 (Norm)	C2 (Norm)
MH BAL 175W M57 QUAD C&C	3.9	3.5	2.8	2.4	3.95	2.42

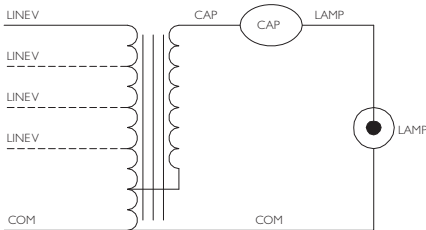



© 2014 Koninklijke Philips N.V. (Royal Philips)  
All rights reserved.

Specifications are subject to change without notice. Trademarks are the property of Koninklijke Philips N.V. (Royal Philips) or their respective owners.

[www.philips.com/lighting](http://www.philips.com/lighting)

2014, April 10  
data subject to change