



# Core & Coil (71A) MH 175W - 450W

## CORE & COIL HID 71A5593001D

The basic ballast is the open core and coil which is most often used as a component within a lighting luminaire. The core and coil also forms the nucleus of Philips Advance's five other ballast configurations.

### Product data

General Information		Operating and Electrical	
ANSI Code	M137-M152	Input Voltage	120/208/240/277 V
Lamp Type	175W MH	Input Frequency	60 Hz
Number Of Lamps	1 piece/unit	Power (Rated) (Nom)	175 W
Circuit Type	SUPER-CWA	Input Current (Open Circuit)	1.9/1.05/0.9/0.8 A
Ballast Type	Magnetic HID	Input Current (Starting)	0.7/0.75/0.65/0.55 A
Base Model	71A5593	Input Current (Short Circuit)	0.4-0.7/0.22-0.35/0.2-0.35/0.17-0.32 A
Core Size	3 X 4 (2 coil)	Secondary Short Circuit Current	1.6-1.95 A
Suitable For Outdoor Use	Yes	Constant Wattage Deviation	10%
Ignitor Catalog Number	LI533-H4	Ballast Factor (Nom)	1
Ignitor Temperature Rating	105°C	Power Factor (Nom)	0.90
Capacitor Value	11 MFD	Open Circuit Voltage	275 V
Capacitor Catalog Number	7C110M40	Input Current (Nom)	1.8/1.05/0.9/0.8 A A
Capacitor Requirements	370V	Input Power (Nom)	208 W
Capacitor Temperature Rating	105°C	Rated Lamp Power	175W W
Capacitor Diameter/Oval Dimensions	1.65 in	Wiring	
Capacitor Height	3.75 in	Wire Striplength	0.5 mm
Automatic Restart	No	Wire Length By Color	12"
		Wire Type	Stranded

Core & Coil (71A) MH 175W - 450W

Remote Wiring Configuration Allowed	Yes
Max Ballast-Lamp Distance Remote Wiring	2'
Recommended Fuse Value	5/3/3/3 A

Approval and Application

Open Circuit Voltage Test (Volts)	250-300 V
Approval Marks	ULR CSA certificate RoHS Compliant
Temperature Marking	C/C/C/C
UL Recognized	Yes
Hipot Test (1 Minute)	2000 V
Hipot Test (2 Seconds)	2500 V
UL Insulation Class	H(180°C)

UL Temperature Code	1029C
---------------------	-------

Product Data

Order product name	CORE & COIL HID 71A5593001D
EAN/UPC - Product	781087120798
Order code	913700503051
Numerator - Quantity Per Pack	1
Numerator - Packs per outer box	1
Material Nr. (12NC)	913700503051
Net Weight (Piece)	3.634 kg

Dimensional drawing

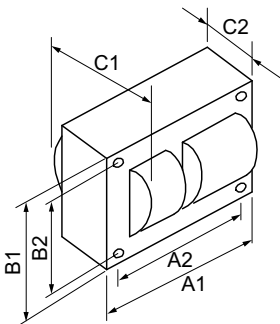

MH BAL 175W M137/M152 QUAD KIT

Product	C1	C2	A1	A2	B1	B2
CORE & COIL HID 71A5593001D	3.5 in	2.24 in	3.9 in	3.5 in	2.8 in	2.4 in

