



# Core & Coil (71A) MH > 450W

CORE & COIL HID MH BAL 1000W M141 347/480V/120T C&C

The basic ballast is the open core and coil which is most often used as a component within a lighting luminaire. The core and coil also forms the nucleus of Philips Advance's five other ballast configurations.

## Product data

### • General Information

ANSI Code	M141
Lamp Type	1000W MH
Number of Lamps	1 piece/unit
Circuit Type	SUPER-CWA
Ballast Type	Magnetic HID
Base Model	71A65F3T
Core Size	4 1/4 x 6 (2 Coil)
Suitable For Outdoor Use	Yes
Ignitor Catalog Number	LI571-H5
Ignitor Temperature Rating	105°C
Capacitor Value	24 MFD
Capacitor Catalog Number	MD2409000
Capacitor Requirements	480V
Capacitor Temperature Rating	90°C
Capacitor Diameter/Oval Dimensions	1.75 in
Capacitor Height	3.9 in
Automatic Restart	No

### • Operating and Electrical

Input Voltage	347/480/120T V
Input Frequency	60 Hz
Inp. Current (Open Circuit)	1.75/1.3 A
Input Current (Starting)	2.25/1.65 A
Input Current (Short Circuit)	1.7-2.6/1.25-1.9 V

Secondary Short Circuit Current	4.6-6.9 A
Constant Wattage Deviation	12.5%
Ballast Factor (Nom)	1
Power Factor (Nom)	0.90
Nominal Open Circuit Voltage	430 V
Input Current (Operating) (Nom)	3.2/2.35 A A
Input Power (Nom)	1075 W
Rated Lamp Watts	1000W W

### • Wiring

Wire Striplength	0.5 mm
Wire Length By Color	12"
Wire Type	Stranded
Remote Wiring Configuration	Yes
Allowed Max Ballast-Lamp Distance Remote Wiring	5'
Recommended Fuse Value	8/6 A

### • Approval and Application

Open Circuit Voltage Test (Volts)	385-470 V
Approbation Marks	ULR CSA certificate RoHS Compliant D/D
Temperature Marking	

**PHILIPS**

## Core & Coil (71A) MH > 450W

UL Recognized	Yes
Hipot Test (1 Minute)	2000 V
Hipot Test (2 Seconds)	2500 V
UL Insulation Class	H(180°C)
UL Temperature Code	1029D

EAN/UPC - Product	781087105214
Order code	71A65F3500T
Numerator - Quantity Per Pack	1
Numerator - Packs per outer box	2
Material Nr. (12NC)	913700505909
Net Weight (Piece)	9.902 kg

### • Product Data

Order product name CORE & COIL HID 71A65F3500T

### Dimensional drawing

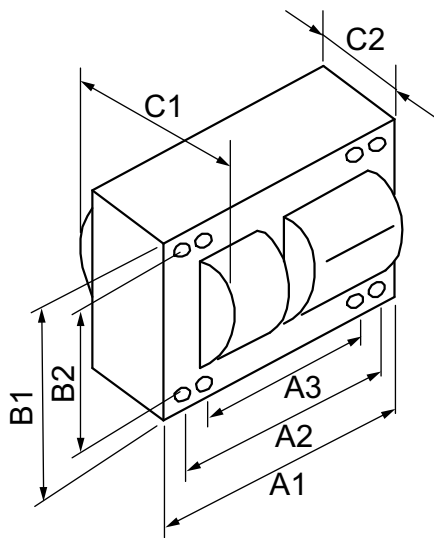

### MH BAL 1000W M141 277/347/480V/120T C&C

Product	C1	C2	A1	A2	A3	B1	B2
CORE & COIL HID 71A65F3500T	4.5 in	2.8 in	6 in	5.4 in	4.4 in	4.3 in	3.9 in

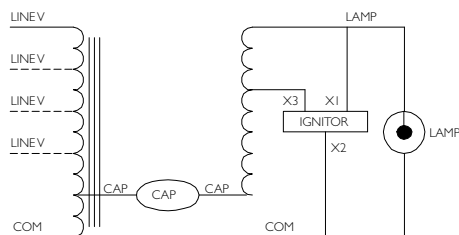

© 2016 Philips Lighting Holding B.V.  
All rights reserved.

Specifications are subject to change without notice. Trademarks are the property of Koninklijke Philips N.V. (Royal Philips) or their respective owners.

[www.philips.com/lighting](http://www.philips.com/lighting)

2016, February 1  
data subject to change