



# Core & Coil (71A) HPS > 400W

## CORE & COIL HID HPS BAL 1000W S52 QUAD KIT

The basic ballast is the open core and coil which is most often used as a component within a lighting luminaire. The core and coil also forms the nucleus of Philips Advance's five other ballast configurations.

### Product data

#### • General Characteristics

Lamp Type	1000W HPS
Number of Lamps	1 piece
Line Voltage	120/208/240/277 V
Input Current (Operating)	9.5/5.5/4.75/4.15 A
Line Frequency	60 Hz
Circuit Type	CWA
Ballast Type	Magnetic HID
Base Model	71A8773
Core Size	4 1/4 x 6
Suitable for Outdoor use?	Yes
Ignitor Catalog Number	LI571-H5
Ignitor Temp Rating	105°C
Capacitor value [µF]	26 MFD
Capacitor Catalog Number	RW1626020
Capacitor Requirements	525V
Capacitor Temp Rating	90°C
Capacitor Dia/Oval Dim	1.75 in
Capacitor Height	4.25 in
Family Name	Core & Coil HPS

#### • Operating Characteristics

Automatic restart	No
Input Voltage at Lamp Dropout	90/156/180/208 V
Nominal Open Circuit Voltage	435 V
Inp. Current (Open Circuit)	4.8/2.7/2.4/2.2 A

Input Current (Starting)	6.4/3.8/3.2/2.8 A
Input Current Short Circuit	5.2-7.8/3-4.5/2.6-3.8/2.25-3.4 A
Secondary ShortCircuit Current	6.4-7.8 A
Input Power Gear	1100 W
Constant wattage deviation	Within Trapezoid
Ballast factor	1 -
Power Factor	0.90

#### • Wiring Characteristics

Wire Striplength	0.5 mm
Wire Length by Color	12"
Wire Type	Stranded
Allowed Wiring Config(Remote)	Yes
Max Dist. Ball to Lamp(Remote)	15'
Recommended Fuse	25/15/10/10 A

#### • System Chars on driver level

Rated Lamp Watts	1000W
------------------	-------

#### • Product Dimensions

Length A1	6 in
Length A2	5.4 in
Length A3	4.4 in
Width B1	4.3 in
Coil Depth C1	5.75 in
Stack Height C2	3.75 in
Width B2	3.9 in

**PHILIPS**

# Core & Coil (71A) HPS > 400W

• Approval & Application Chars

Approbation Marks	ULR, CSA, RoHS
CE marking	No
VDE certificate	No
UL Listed	No
CSA certificate	Yes
CCC certificate	No
Chia Quality Certificate	No
Temperature marking	C/B/C/C
CEC Listing	No
cUL certificate	No
EISA	No
ETL Certificate	No
FIDE Certificate	No
NOM certificate	No
RoHS Compliant	Yes
SASO Certificate	No
UL Recognized	Yes

ANSI Code	S52
HiPot Test (1 minute)	2000 V
HiPot Test (2 seconds)	2500 V
Open Circ Voltage Test (Volts)	395-485 V
UL Insulation Class	H(180°C)
UL Temperature Code	1029C

• Product Data

Product number	71A8773001
Full product name	HPS BAL 1000W S52 QUAD KIT
Short product name	HPS BAL 1000W S52 QUAD KIT
Pieces per Sku	1
Skus/Case	1
Bar code on pack	781087877319
Bar code on case	30781087877310
Logistics code(s)	913700526809
eop_net_weight_pp	13.445 kg

Dimensional drawing

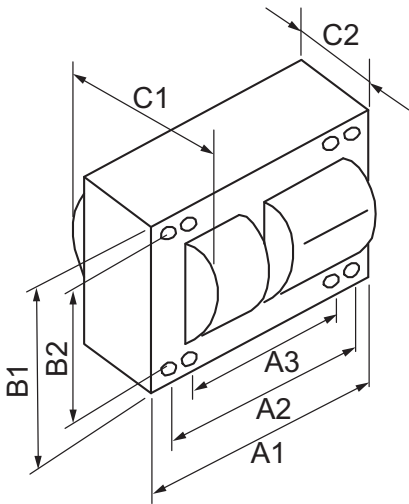

CORE & COIL HID HPS BAL 1000W S52 QUAD KIT

Product	A1 (Norm)	A2 (Norm)	A3 (Norm)	B1 (Norm)	B2 (Norm)	C1 (Norm)	C2 (Norm)
HPS BAL 1000W S52 QUAD KIT	6	5.4	4.4	4.3	3.9	5.75	3.75

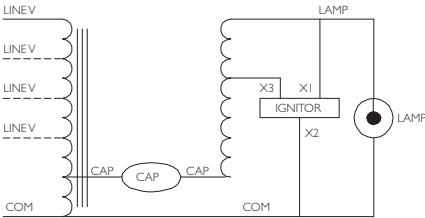



© 2014 Koninklijke Philips N.V. (Royal Philips)  
All rights reserved.

Specifications are subject to change without notice. Trademarks are the property of  
Koninklijke Philips N.V. (Royal Philips) or their respective owners.

[www.philips.com/lighting](http://www.philips.com/lighting)

2014, March 20  
data subject to change