



Since 1959

PART NO.	BASE TYPE	DESIGN VOLTS	DESIGN AMPS	MSCD	FILAMENT TYPE	AVERAGE LIFE HOURS	REVISIONS			
							REV #	DESCRIPTION	DATE	APPROVED
7683	BI PIN (G1.27)	5.0V	0.06±15%	0.05±20%	C-2R	25,000	1	ISSUED	03/18/2021	R.M.

GDIA 3.3mm MAX

0.130"

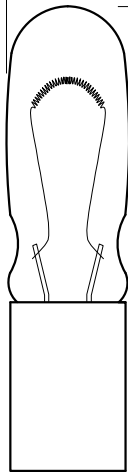

0° VIEW

9.65mm  
.380"

6.35mm±0.51  
.250"±0.02



90° VIEW

T-1 BULB SHAPE  
Clear Glass

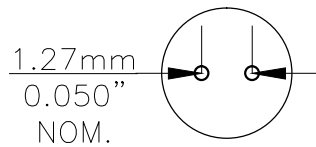

BASE BOTTOM VIEW

1.27mm  
0.050"  
NOM.



UNLESS OTHERWISE SPECIFIED: DIMENSIONS ARE IN INCHES TOLERANCES		CEC INDUSTRIES LTD			
DECIMALS	ANGULAR	599 BOND STREET		LINCOLNSHIRE, IL 60069	
.XX ± .05	± 0.5°				
.XXX ± .010					
FRACTIONAL	± 1/64				
DRAWN ROSE MEDINA	DATE 03/18/2021	TITLE LIGHT BULB NO. 7683			
CHECKED		SIZE A	FSCM NO.	DWG NO. 7683	REV 1
DESIGN		SCALE	PLOT SCALE	SHEET 1 OF 1	
MATERIAL		FILE 7683.pdf	DRAWING NOT TO SCALE		