

# HF-Matchbox Red

HF-M RED 114 SH TL/TL5/PL-C/S 230-240V

HF-Matchbox Red is an affordable, reliable, compact, lightweight and high-frequency ballast for use with system wattages below 25 W in combination with TL mini, TL-D, TL5 and TL5c, PL-T/C, and PL-L/S lamps. The HF-M Red range has a robust design, meets all relevant international safety and performance standards and has an energy efficiency index (CELMA EEI ) of A2.

## Product data

### • General Characteristics

Rated Lamptype	TL/TL5/PL-C/S
Rated Number of Lamps	1 piece
Rated Ballast-Lamp Power	14
Line Voltage	230-240 V
Line Frequency	50/60 Hz
Housing	SH
Lifetime 90% surv.@Tcaselife	45000 hr

### • Operating Characteristics

Automatic restart	Yes
Maximum ignition time	1.55 (max) s
Mains voltage safety (AC)	-10%/+10%
Mains voltage performance (AC)	-8%/+6%
Power losses gear	2.9 W
PowerFactor 100% output power	0.64 -
Battery voltage lamp ignition	190-254 V
Overvoltage protection 320Vac	48 hr
Max ballast on MCB(16A type B)	101 x

### • Wiring Characteristics

Color input terminals	Blue
Color output terminals	Grey

Conn.type input terminals	Insert
Conn.type output terminals	Insert
Max. cable length	0.75 m
Hot Wires	
Striplength	8.0-9.0 mm
Wcs Input terminals	0.50-1.50 mm2
Wcs Output terminals	0.50-1.50 mm2

### • System Chars on driver level

Rated Lamp Power on TL5	14
System Power on TL5	16
Lamp Power on TL5	13.1
Power Loss on TL5	2.9
System Power on PL-C	10.6
Rated Lamp Power on PL-C	14
Power Loss on PL-C	1.7
Lamp Power on PL-C	8.9

### • Temperature Characteristics

F-marking	No
T-case maximum	80 (max) C
T-ambient	-25 (min), 50 (max) C

### • Product Dimensions

Length A1	80.0 mm
Fixing Hole Distance	70.0 mm
Length A2	

**PHILIPS**

## HF-Matchbox Red

Width B1 40.0 mm  
 Height C1 22.0 mm  
 Fixing Hole Distance 10.0 mm  
 Height C2  
 Fixing Hole Diameter 4.2 mm  
 D1

Full product code 913700423266  
 Full product name HF-M RED 114 SH TL/TL5/PL-C/S 230-240V  
 Order product name HF-M RED 114 SH TL/TL5/PL-C/S 230-240V  
 Pieces per pack 1  
 Packing configuration 50  
 Packs per outerbox 50  
 Bar code on pack - EAN1 8711500931405  
 Bar code on outerbox - EAN3 8711500931412  
 Logistic code(s) - 12NC 913700423266  
 Net weight per piece 0.034 kg

### • Approval & Application Chars

CE marking Yes  
 ENEC certificate Yes  
 VDE certificate No  
 UL certificate No  
 CB Certificate No

### • Product Data

Order code 913700423266

### Dimensional drawing

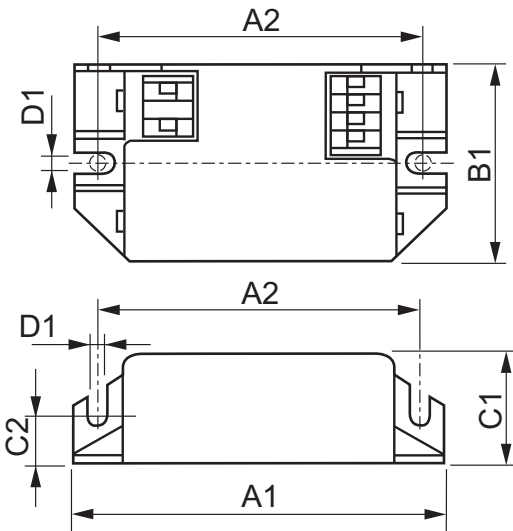

### HF-M RED 114 SH TL/TL5/PL-C/S 230-240V

Product	A1 (Norm)	A2 (Norm)	B1 (Norm)	C1 (Norm)	C2 (Norm)	D1 (Norm)
HF-M RED 114 SH TL/TL5/PL-C/S 230-240V	80.0	70.0	40.0	22.0	10.0	4.2

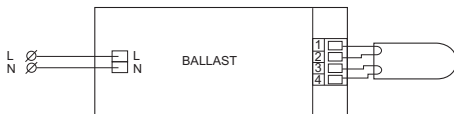

© 2014 Koninklijke Philips N.V. (Royal Philips)  
 All rights reserved.

Specifications are subject to change without notice. Trademarks are the property of Koninklijke Philips N.V. (Royal Philips) or their respective owners.

[www.philips.com/lighting](http://www.philips.com/lighting)

2014, April 11  
 data subject to change