

# Plusrite®

**CATALOG NUMBER: BALU1000-CWA/V5**

**1000W S52**

**High Pressure Sodium Lamp Ballast**

**60 Hz CWA**

**4X6 CORE - HX, CWA CWI UNITS**

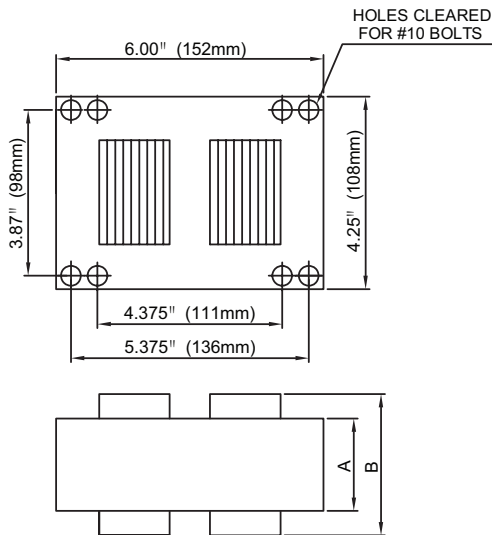

Input Volts		120	208	240	277	480
Circuit Type	CWA					
<b>REGULATION</b>						
Line Volts	±10%					
Lamp Watts	±14%					
<b>LINE CURRENT( Amps )</b>						
Operating		9.50	5.50	4.75	4.20	2.31
Open Circuit		4.80	2.75	2.40	2.05	0.96
Starting		7.20	4.15	3.60	3.10	1.90
<b>RECOMMENDED FUSE (Amps)</b>						
		25	15	12	10	6
<b>TEMPERATURE RATINGS</b>						
Insulation Class	H					
Coil Temperature Code		C	B	C	C	C
Benchtop Coil Rise		83.8	77.8	81.8	80.5	80.5
Power Factor (Min)	90%					
Input Watts	1100 W					
Efficiency						
<b>CURRENT CREST FACTOR</b>						
	1.65					
<b>NOM. OPEN CIRCUIT VOLTAGE</b>						
	425					
<b>INPUT VOLTAGE AT LAMP DROPOUT</b>						
		95	170	190	220	360
<b>MIN AMBIENT STARTING TEMP</b>						
	-40°F/-40°C					

**Capacitor:**

Microfarads: 26.0 uf  
 Volts (Max): 540 V  
 Case Temp(Max): 100°C  
 D: 1.97 in  
 L: 3.94 in  
 A: 0.79 in

**Ignitor:**

Case Temp (Max): 105°C  
 BTL Distance (Max): 15 ft

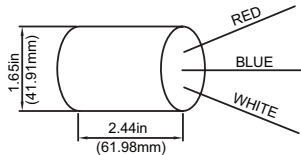
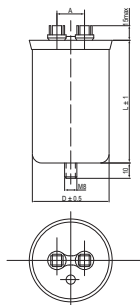

<b>60 HZ TEST PROCEDURES</b>						
<b>High Potential Test (Volts)</b>						
1 Minute		2,000 V				
1 Second		2,400 V				
Open Circuit Voltage Test (V)		380 - 470				
<b>Short Circuit Current Test (A)</b>						
Secondary Current	Min	6.20				
	Max	7.60				
Input Current	Min	5.20	3.15	2.60	2.35	1.46
	Max	8.20	4.80	4.10	3.55	2.19

<b>CORE and COIL Specifications</b>						
Dimension A (in)		4.33				
Dimension B (in)		5.91				
Weight (lbs)		27.0				
Lead Lengths (in)		12				

<b>CAPACITOR REQUIREMENT</b>						
Microfarads		26.0 uf				
Volts (Min)		525 V				

**Wiring Diagram:**

**RoHS**

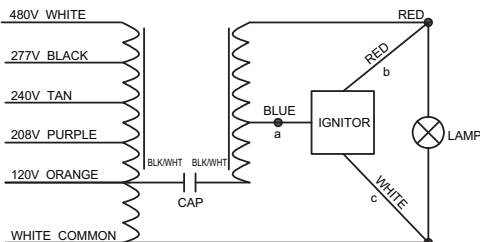

**ORDERING INFORMATION**

The ballast is prewired comes with a kit including capacitor, ignitor and bracket.

Data is based upon tests performed by Plusrite in a controlled environment and is representative of relative performance. Actual performance can vary depending on operating conditions. Specifications are subject to change without notice.

Coil material: Cu/Al