Global Lighting Induction Lamp Instructions

Compliance with standard Q/IDJW02-2003 Q/IDJW03-2003

Global Lighting Induction Lamp, is a high-tech light source with the advantages of super long life, high lumen efficacy, energy saving, environment protection. Its diversified products lines with different models, types, shapes and CCTs can be widely applied in commercial, industrial, infrastructure, and institutional lighting.

User's manual

To User:

- ◆ Thanks for buying our product.
- ◆ Please read manual carefully before using, and keep it for reference later.

Normal working condition requirements:

- ◆ Environment temperature: $\leq 50^{\circ}\text{C}$,
- ◆ The environment should be without corrosive, explosive, flammable gases or direct contacting with conductive dust.
- ◆ Ballast should be working in no-intense vibration or shock place.

Special statement:

- ◆ If severe flicker and sound of "creak" come out during the installation, please shut off the power immediately, then check if there is loosening of the line.
- ◆ Prohibited connecting input line and output line wrong, please connect according to the mark.

Technical parameter:

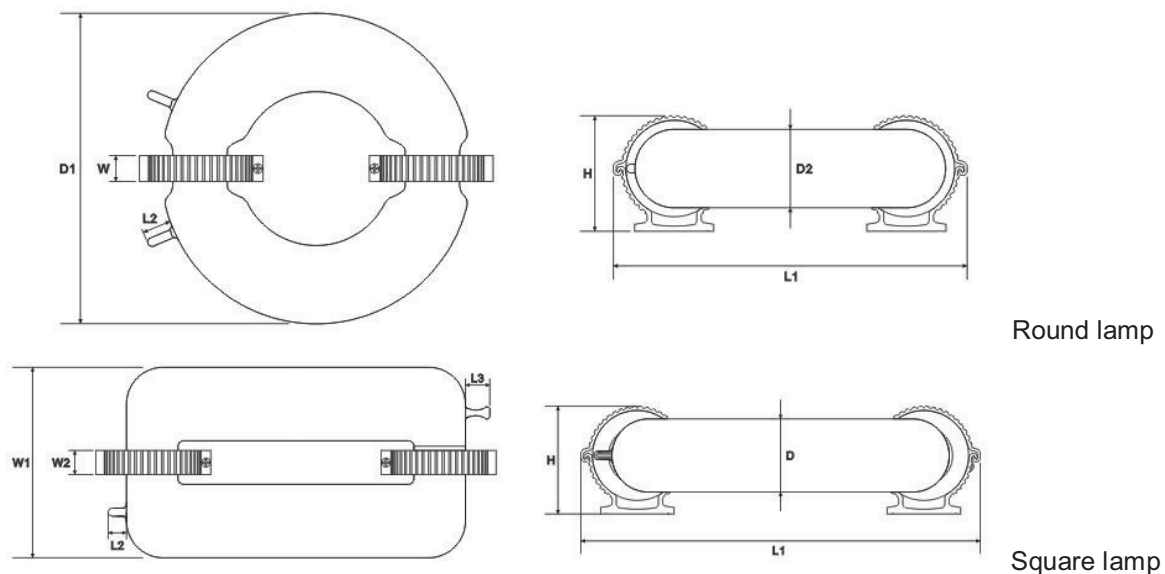

Model	Luminance (Lm)	Efficacy (Lm/W)	CRI (Ra)	Lumen maintain (%)	Lamp dimension(in)	
					Round lamp L1*D1*H	Square lamp L1*W1*H
GL-WJ40W	3200	70	80	≥90	7.20x5.98x2.76	7.64x5.31x2.76
GL-WJ60W	4800	75	80	≥90	7.20x5.98x2.76	7.64x5.31x2.76
GL-WJ80W	6500	75	80	≥90	9.65x8.50x3.15	11.73x5.59x3.15
GL-WJ100W	7500	75	80	≥90	9.65x8.50x3.15	11.73x5.59x3.15
GL-WJ120W	9600	75	80	≥90	11.97x10.83x3.15	14.41x5.59x3.15
GL-WJ150W	12000	80	80	≥90	11.97x10.83x3.15	15.59x5.59x3.15
GL-WJ200W	16500	80	80	≥90	13.82x12.4x3.54	17.56x5.91x3.54
GL-WJ250W	20500	80	80	≥90	13.82x12.4x3.54	17.56x5.91x3.54
GL-WJ300W	24500	80	80	≥90	17.17x15.75x3.54	21.50x6.06x3.54

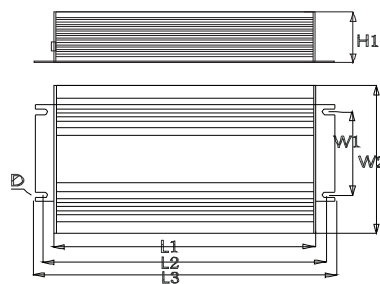

Model	Input voltage (V)	Input Current (A)	Power factor (λ)	Input wattage (W)	THD (THD) (%)	Ballast dimension (in) L3*W2*H1
GL-BA40W	120-277	0.1-0.3	≥0.98	40	≤ 10	7.87x3.58x1.97
GL-BA60W	120-277	0.2-0.5	≥0.98	60	≤ 10	7.87x3.58x1.97
GL-BA80W	120-277	0.2-0.6	≥0.98	80	≤ 10	7.87x3.58x1.97
GL-BA100W	120-277	0.3-0.8	≥0.98	100	≤ 10	7.87x3.58x1.97
GL-BA120W	120-277	0.4-1	≥0.98	120	≤ 10	7.87x3.58x1.97
GL-BA150W	120-277	0.5-1.2	≥0.98	150	≤ 10	7.87x3.58x1.97
GL-BA200W	120-277	0.7-1.6	≥0.98	200	≤ 10	7.87x3.58x1.97
GL-BA250W	120-277	0.9-2	≥0.98	250	≤ 10	7.87x3.58x1.97
GL-BA300W	165-277	1-1.8	≥0.98	300	≤ 10	7.87x3.58x1.97

Caution for connecting

- (1) Prior to connecting *L* and *N* end of ballast with the power, please do connect the tube with the ballast at first.
- (2) Both the rated wattage of tube and the rated wattage of ballast shall be the same.
- (3) To strictly connect Yellow/Green cable to a ground..It is a must.

The Ballast shall be connected with the tube correctly before switching on.