

FLAT PANEL (FXPNL)

Project
Schedule
Date
Notes

DESCRIPTION

Qualified DLC Premium and Standard Flat Panels have an integrated LED technology with a low profile design. The lightweight LED provide a smooth and uniform light distribution from edge-to-edge for an even and consistent color design. Perfect solution for your interior lighting needs for offices, schools, and meeting rooms. The Flat Panel are easily installed with maximum energy savings; comes in standard configurations of 1'x4', 2'x2', and 2'x4' for mounting in T-Bar/Grid ceilings or optional surface mount box kit.



FEATURES

- DLC Premium / DLC Standard
- UL Damp
- Lightweight and easy installation
- L70 rated chip for over 100,000 projected life hours
- Uniform and consistent color: ANSI C78.377-2015
- LED emergency drivers compatible
- Dimmable: 0-10V
- Input Voltage: 120-277V
- Operating temperature: 14°F - 104°F

APPLICATIONS

- Conference rooms
- Meeting rooms
- Offices
- Schools
- Hospitals
- Hospitalities

WARRANTY

- 5 Year Warranty

ACCESSORIES

- Surface mount kit
- Emergency LED driver + bracket
- Earthquake Hook (Pre-installed)

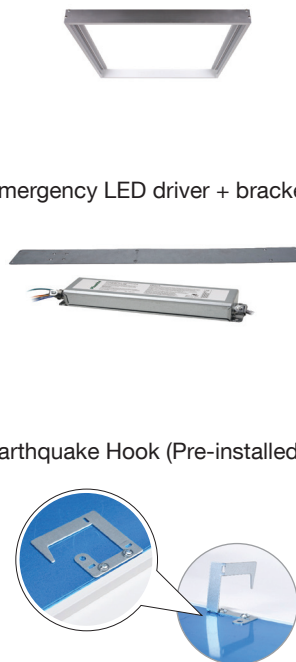

SPECIFICATIONS

2'x 2'

Front

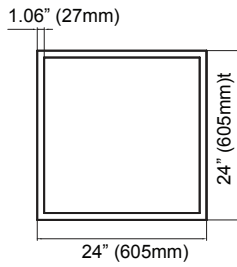

Back

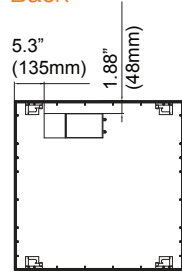

Side

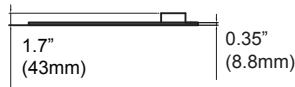

1'x 4'

Front

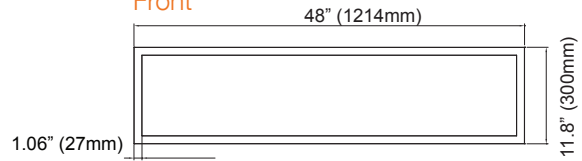

Back

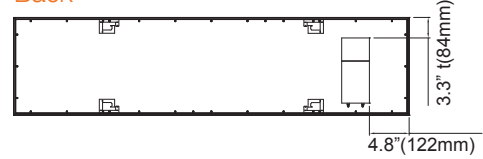

Side



2'x 4'

Front

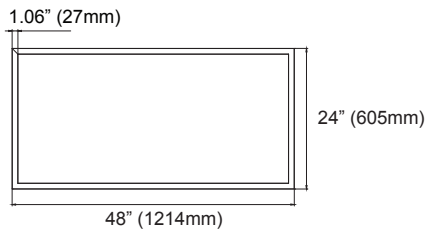

Side

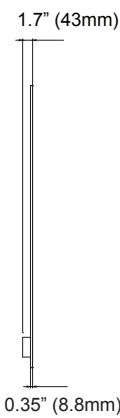

Back

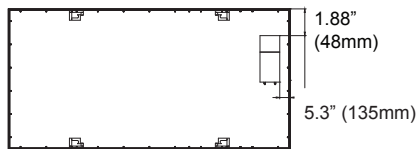

Surface Mount Kit Dimension

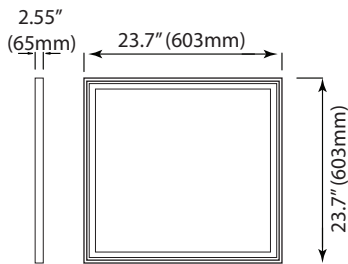

P10097 MT-2x2BOX
(2 x 2 Surface Mount Kit)

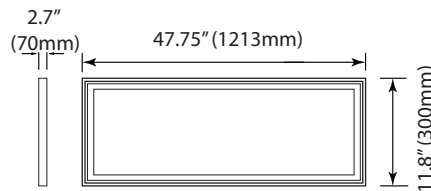

P10096 MT-1x4BOX
(1 x 4 Surface Mount Kit)

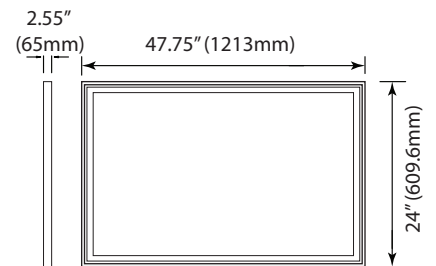

P10098 MT-2x4BOX
(2 x 4 Surface Mount Kit)

ORDERING

*P= Premium DLC / *S = Standard DLC

Watts (W)	Ordering Code	Description	Color Temp (K)	Lumens (lm)	Size	Equiv. Wattage (W)	Beam Angle	Rated Hrs	Damp Location	DLC (S/P)
26	9220	LED-FXPNL26/1X4/840	4000K	3,250	1' X 4'	90~100	110°	50,000	•	P
28	9219	LED-FXPNL28/2X2/840	4000K	3,500	2' X 2'	90~100	110°	50,000	•	P
36	9221	LED-FXPNL36/2X4/840	4000K	4,500	2' X 4'	90~100	110°	50,000	•	P
41	7721	LED-FXPNL40/1X4/835G1	3500K	4,376	1' X 4'	90~100	110°	50,000	•	S
41	7675	LED-FXPNL40/1X4/840G1	4000K	4,397	1' X 4'	90~100	110°	50,000	•	S
41	7686	LED-FXPNL40/1X4/850G1	5000K	4,459	1' X 4'	90~100	110°	50,000	•	S
40	7720	LED-FXPNL40/2X2/835G1	3500K	4,381	2' X 2'	90~100	110°	50,000	•	S
40	7674	LED-FXPNL40/2X2/840G1	4000K	4,408	2' X 2'	90~100	110°	50,000	•	S
40	7685	LED-FXPNL40/2X2/850G1	5000K	4,489	2' X 2'	90~100	110°	50,000	•	S
50	7722	LED-FXPNL50/2X4/835G1	3500K	5,135	2' X 4'	120~130	110°	50,000	•	S
50	7676	LED-FXPNL50/2X4/840G1	4000K	5,176	2' X 4'	120~130	110°	50,000	•	S
50	7687	LED-FXPNL50/2X4/850G1	5000K	5,301	2' X 4'	120~130	110°	50,000	•	S

MOUNTING / ACCESSORIES

SOLD SEPARATELY

Surface Mount Kit

- P10096 MT-1X4BOX (1'X4')
- P10097 MT-2X2BOX (2'X2')
- P10098 MT-2X4BOX (2'X4')



Cable

- P10147 MT-ACC-4FT (4-ft Earthquake Aircraft Cable)
- P10144 MT-ACC-10FT (10-ft Earthquake Aircraft Cable)



Emergency Battery

- 7333 BAEM12-60BC/MV-B (LED Emergency Backup Driver 120-277V)

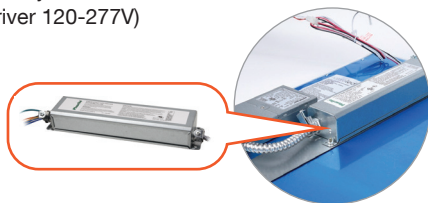

Mounting Kit

- K7333222 FXPNL-BAEM-MT1FT (Emergency Backup Driver Mount Kit for 1'x4')
- K7333221 FXPNL-BAEM-MT2FT (Emergency Backup Driver Mount Kit for 2'x2' and 2'x4')



MOUNTING / ACCESSORIES

INSTALLATION

Surface Mount Kit

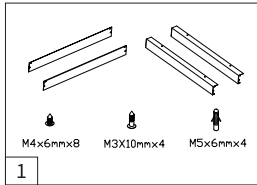

1 Check spare parts with the above list

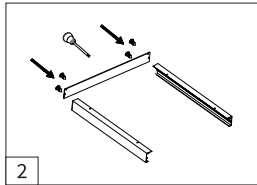

2 Connect 2 sides board & back board with screws

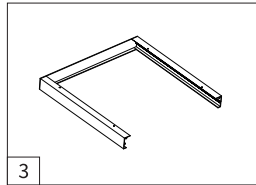

3 After the 2nd step, it should look like the above chart

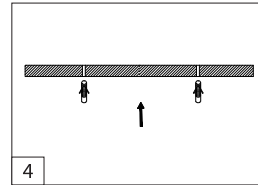

4 Put the expansion screws into the ceiling

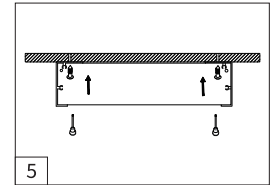

5 Put the 3rd steps fixture into ceiling by screws

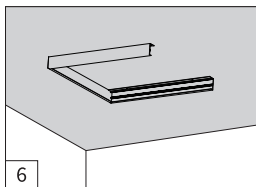

6 After the 5th step, it should look like the above chart

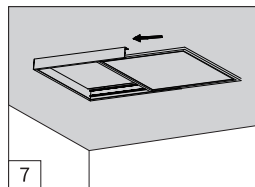

7 Insert LED Panel light

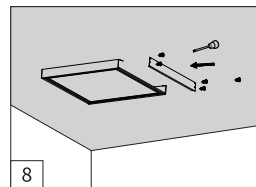

8 Lock the last mounted piece shown in the above chart

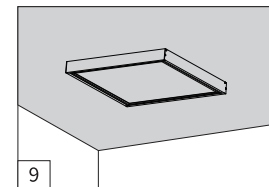

9 Finished mounting

EARTHQUAKE HOOK

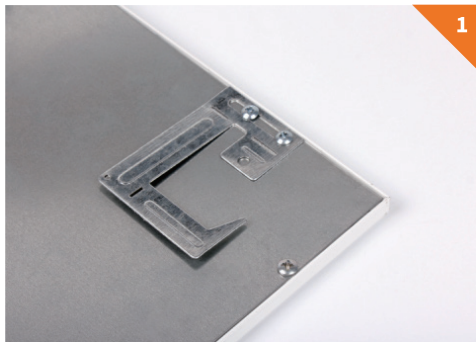

1



2



3

1. Pull earthquake hook away from panel until facing perpendicular to the panel backing (Fig. 1).
2. Bend hook arm until facing perpendicular to the hook body (Fig. 2).
3. Hook panel light onto T-bars until panel is fully supported (Fig. 3).



Earthquake Hooks



Before Installation



After Installation

PHOTOMETRICS CHART

FXPNL26 (1'x4')
DLC Premium

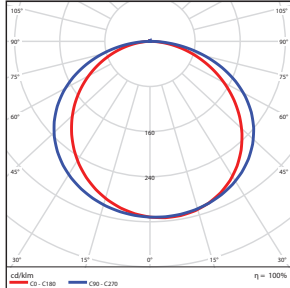

Illuminance at a Distance

Center Beam fc	Beam Width
2.5R 169 fc	7.7 ft 10.6 ft
5.0R 42.3 fc	15.4 ft 21.3 ft
7.5R 18.8 fc	23.1 ft 31.9 ft
10.0R 10.6 fc	30.7 ft 42.6 ft
12.5R 6.77 fc	38.4 ft 53.2 ft
15.0R 4.70 fc	46.1 ft 63.9 ft

■ Vert. Spread: 113.9°
■ Horiz. Spread: 129.7°

FXPNL28 (2'x2')
DLC Premium

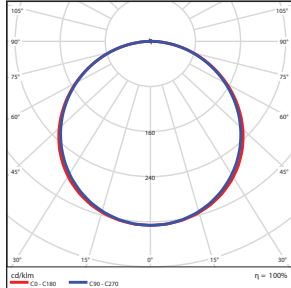

Illuminance at a Distance

Center Beam fc	Beam Width
2.5R 185 fc	8.3 ft 10.6 ft
5.0R 46.3 fc	16.7 ft 21.3 ft
7.5R 20.6 fc	25.0 ft 32.4 ft
10.0R 11.6 fc	33.3 ft 42.6 ft
12.5R 7.41 fc	41.7 ft 53.2 ft
15.0R 5.15 fc	50.0 ft 63.9 ft

■ Vert. Spread: 118.1°
■ Horiz. Spread: 116.9°

FXPNL36 (2'x4')
DLC Premium

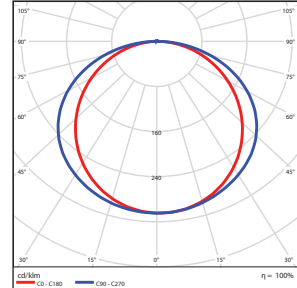

Illuminance at a Distance

Center Beam fc	Beam Width
2.5R 213 fc	8.0 ft 11.4 ft
5.0R 53.3 fc	15.9 ft 22.9 ft
7.5R 23.7 fc	23.9 ft 34.3 ft
10.0R 13.3 fc	31.9 ft 45.8 ft
12.5R 8.52 fc	39.8 ft 57.2 ft
15.0R 5.92 fc	47.8 ft 68.7 ft

■ Vert. Spread: 115.8°
■ Horiz. Spread: 132.8°

FXPNL40 (1'x4')
DLC Standard

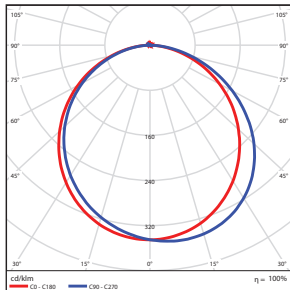

Illuminance at a Distance

Center Beam fc	Beam Width
2.5R 242 fc	7.2 ft 7.6 ft
5.0R 60.4 fc	14.4 ft 15.1 ft
7.5R 26.9 fc	21.6 ft 22.7 ft
10.0R 15.1 fc	28.8 ft 30.3 ft
12.5R 9.67 fc	35.9 ft 37.8 ft
15.0R 6.71 fc	43.1 ft 45.4 ft

■ Vert. Spread: 110.4°
■ Horiz. Spread: 113.1°

FXPNL40 (2'x2')
DLC Standard

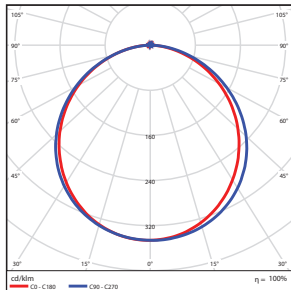

Illuminance at a Distance

Center Beam fc	Beam Width
2.5R 243 fc	7.2 ft 7.8 ft
5.0R 60.6 fc	14.4 ft 15.7 ft
7.5R 27.0 fc	21.6 ft 23.5 ft
10.0R 15.2 fc	28.8 ft 31.3 ft
12.5R 9.70 fc	36.0 ft 39.2 ft
15.0R 6.74 fc	43.2 ft 47.0 ft

■ Vert. Spread: 110.5°
■ Horiz. Spread: 114.9°

FXPNL50 (2'x4')
DLC Standard

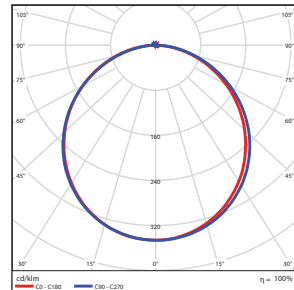

Illuminance at a Distance

Center Beam fc	Beam Width
2.5R 284 fc	7.3 ft 7.6 ft
5.0R 71.0 fc	14.7 ft 15.2 ft
7.5R 31.6 fc	22.0 ft 22.9 ft
10.0R 17.8 fc	29.4 ft 30.5 ft
12.5R 11.4 fc	36.7 ft 38.1 ft
15.0R 7.89 fc	44.1 ft 45.7 ft

■ Vert. Spread: 111.5°
■ Horiz. Spread: 113.5°

PACKAGE

Master Pack: 2 pcs

