



23105 Kashiwa Court, Torrance, CA 90505
Phone: (800) 579-4875 or (310) 534-1505 Fax: (310) 534-1424
E-mail: info@ledtronics.com
Website: http://www.ledtronics.com

LED48T8KL6-1024W-3565-101WFA

LED T8 Tube Light (Ballast Bypass & Ballast Ready)
Frosted White Lens; 2 Pin G13 Base; 4 ft.; IP20
Wattage Tunable: 10W/12W/15W/18W/24W – 120~277Vac
CCT Tunable: 3500K/4000K/5000K/5700K/6500K



DWG BY:
FKT / HF
07-11-24

R&D:
UF
07-12-24

MFG:
PP
07-12-24

QA:
GZ
07-12-24

REVISION LTR: PRELIMINARY

07-11-24

○ Electro-Optical Characteristics

Part Number	LED48T8KL6-1024W-3565-101WFA				
Input Voltage (typ)	120~277Vac				
Tested @ (Voltage)	120Vac				
Nominal Power	10 W	12 W	15 W	18 W	24 W
Medium White			CCT: 3500K		
Power Consumption	10.7 W	12.8 W	15.9 W	19.7 W	23.5 W
Current Consumption	0.093 A	0.111 A	0.137 A	0.170 A	0.203 A
Efficacy: (Lm/W)	156	151	145	137	131
Lumens	1,664 lm	1,935 lm	2,313 lm	2,704 lm	3,074 lm
Maximum Candela	407 cd	470 cd	564 cd	658 cd	744 cd
Power Factor	0.96	0.96	0.96	0.96	0.96
Natural White			CCT: 4000K		
Power Consumption	10.5 W	12.5 W	15.7 W	19.2 W	23.0 W
Current Consumption	0.092 A	0.108 A	0.135 A	0.166 A	0.198 A
Efficacy: (Lm/W)	163	160	154	149	143
Lumens	1,712 lm	2,000 lm	2,413 lm	2,855 lm	3,282 lm
Maximum Candela	422 cd	491 cd	595 cd	702 cd	802 cd
Power Factor	0.96	0.96	0.96	0.96	0.96
Pure White			CCT: 5000K		
Power Consumption	10.5 W	12.6 W	15.7 W	19.3 W	23.1 W
Current Consumption	0.091 A	0.108 A	0.136 A	0.167 A	0.198 A
Efficacy: (Lm/W)	162	157	154	147	141
Lumens	1,698 lm	1,979 lm	2,411 lm	2,844 lm	3,253 lm
Maximum Candela	422 cd	491 cd	600 cd	706 cd	807 cd
Power Factor	0.96	0.97	0.96	0.96	0.96
True White			CCT: 5700K		
Power Consumption	10.6 W	12.7 W	15.9 W	19.6 W	23.3 W
Current Consumption	0.092 A	0.109 A	0.137 A	0.169 A	0.201 A
Efficacy: (Lm/W)	157	152	147	139	134
Lumens	1,661 lm	1,933 lm	2,342 lm	2,733 lm	3,121 lm
Maximum Candela	415 cd	483 cd	587 cd	681 cd	778 cd
Power Factor	0.95	0.96	0.96	0.96	0.96
Cool White			CCT: 6500K		
Power Consumption	10.7 W	12.8 W	16.1 W	19.7 W	23.6 W
Current Consumption	0.093 A	0.110 A	0.140 A	0.170 A	0.204 A
Efficacy: (Lm/W)	151	146	139	133	125
Lumens	1,614 lm	1,867 lm	2,230 lm	2,615 lm	2,958 lm
Maximum Candela	405 cd	468 cd	561 cd	654 cd	740 cd
Power Factor	0.96	0.96	0.96	0.96	0.96
CRI (Ra)	>80				
Angle of illumination	110° x 145°				

○ **Dimensions**

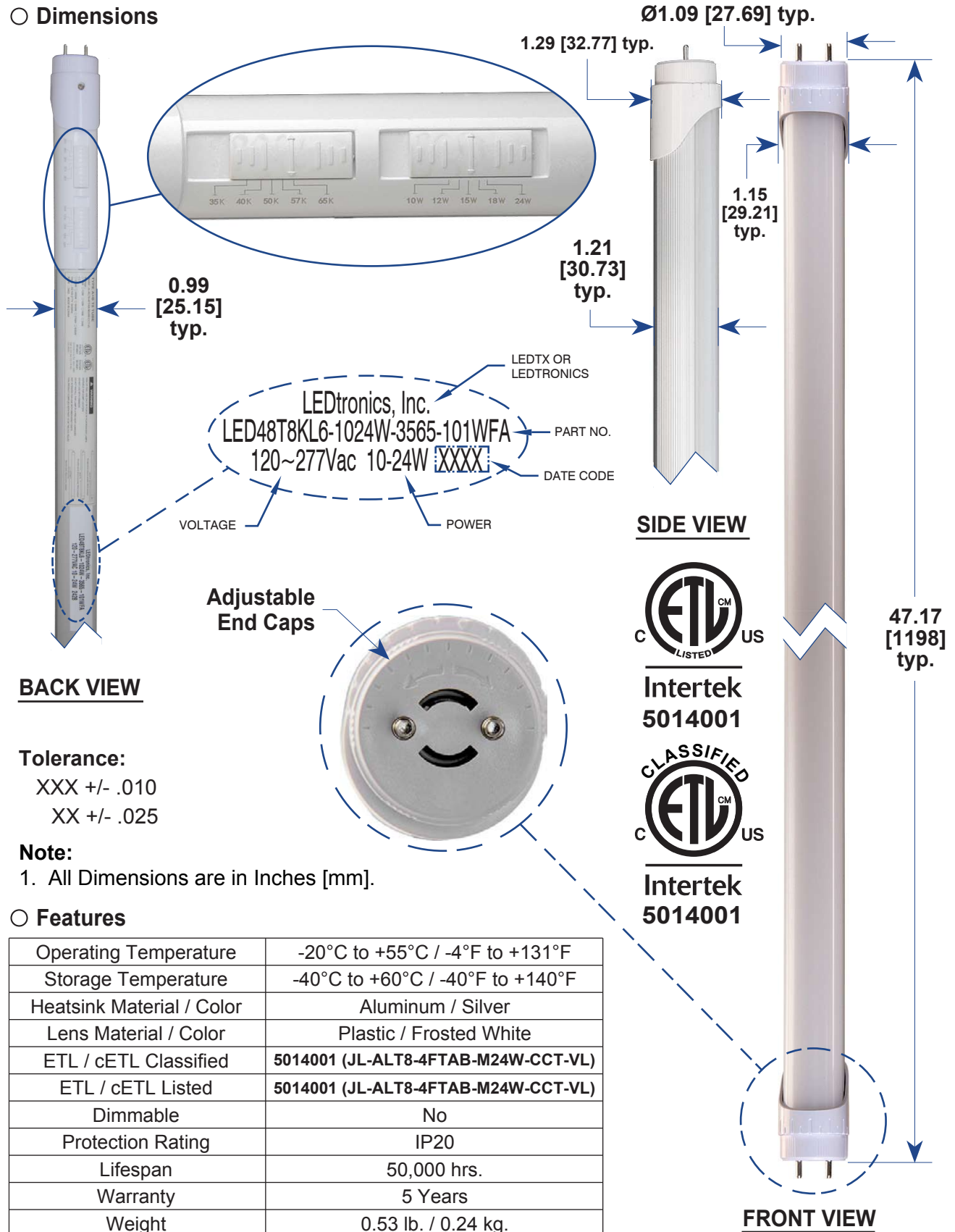

Tolerance:
 XXX +/- .010
 XX +/- .025

Note:
 1. All Dimensions are in Inches [mm].

○ **Features**

Operating Temperature	-20°C to +55°C / -4°F to +131°F
Storage Temperature	-40°C to +60°C / -40°F to +140°F
Heatsink Material / Color	Aluminum / Silver
Lens Material / Color	Plastic / Frosted White
ETL / cETL Classified	5014001 (JL-ALT8-4FTAB-M24W-CCT-VL)
ETL / cETL Listed	5014001 (JL-ALT8-4FTAB-M24W-CCT-VL)
Dimmable	No
Protection Rating	IP20
Lifespan	50,000 hrs.
Warranty	5 Years
Weight	0.53 lb. / 0.24 kg.
Caution Label	Suitable for Damp Locations

○ Ballast Compatibility List

NO.	BRAND	MODEL NO.
1	GE	GE-132MAX-H/ULTRA
2	GE	GE-132MAX-L/ULTRA
3	GE	GE132MAX-N/ULTRA
4	GE	GE-232-MAXP-H/ULTRA
5	GE	GE232MAX-H/ULTRA
6	GE	GE232RIS-1-TP-SL
7	GE	GE-232-MV-PS-L
8	GE	GE-232-MV-PS-H
9	GE	GE232MAX347-N
10	GE	GE232MAX-G-N
11	GE	B232IUNVHEL-A
12	GE	GE232MAX-G-N-DIYB
13	GE	GE232MAX-L/ULTRA
14	GE	GE332MAX-G-N
15	GE	GE332MAX-L/ULTRA
16	GE	GE332MAX-G-N
17	GE	B332IUNVHP-A
18	GE	GE332MV-N-DIY
19	GE	GE332MV-N-DIY
20	GE	GE-432-MAX-L/ULTRA
21	GE	GE432MAXP-H/ULTRA
22	GE	GE432MAX-G-N-42T
23	GE	GE-432-MAX-N/ULTRA
24	GE	GE432MAX-G-H
25	GE	GE432-120-RES
26	GE	GE432MV-N-42T
27	GE	GE432MV-N-DIY
28	GE	GE432MV-N-DIY
29	GE	GE432MAX-G-N
30	GE	GE432MVPS-H-42T
31	GE	GE432MAX-347-N
32	GE	GE432-120-RES-DIY
33	OSRAM	QTP 2X32T8/347 ISN-SC
34	OSRAM	QHE 2X32T8/347 ISN-SC

NO.	BRAND	MODEL NO.
35	OSRAM	QHE 2X32T8/UNV ISL-SC
36	OSRAM	QTP 4X32T8/UNV ISN-SC
37	OSRAM	QHE 4x32T8/UNV PSH-HT
38	OSRAM/SYLVANIA	QHE 1X32T8/347 ISN-SC
39	OSRAM/SYLVANIA	QHE 1X32T8/UNV ISL-SC
40	OSRAM/SYLVANIA	QHE 1X32T8/UNV ISL-SC
41	OSRAM/SYLVANIA	QHE 1X32T8/UNV ISN-SC
42	OSRAM/SYLVANIA	QHE 1X32T8/UNV ISH-SC
43	OSRAM/SYLVANIA	QHE 2X32T8/UNV ISN-SC
44	OSRAM/SYLVANIA	QT2X32T8/347 ISL-SC
45	OSRAM/SYLVANIA	QT2X32T8/347 ISH-SC
46	OSRAM/SYLVANIA	QHE 2X32T8/UNV ISN-SC
47	OSRAM/SYLVANIA	QHE 2X32T8/UNV ISH-SC
48	OSRAM/SYLVANIA	QHE 2X32T8/UNV ISH-SC
49	OSRAM/SYLVANIA	QHE 2X32T8/UNV ISN-SC
50	OSRAM/SYLVANIA	QTP 2X32T8/UNV ISL-SC
51	OSRAM/SYLVANIA	QHE 2X32T8/UNV ISL-SC
52	OSRAM/SYLVANIA	QHE 2X32T8/UNV PSN MC
53	OSRAM/SYLVANIA	IOPA-3P32HL-SC
54	OSRAM/SYLVANIA	QHE 3X32T8/UNV ISH-SC
55	OSRAM/SYLVANIA	QHE 3X32T8/UNV PSH-HT-SC
56	OSRAM/SYLVANIA	QHE 3X32T8/UNV ISN-SC-1
57	OSRAM/SYLVANIA	QTP 3X32T8/UNV ISN-SC
58	OSRAM/SYLVANIA	QHE 3X32T8/UNV ISL-SC
59	OSRAM/SYLVANIA	QHE 3X32T8/UNV ISH-SC-1
60	OSRAM/SYLVANIA	QHE 3X32T8/UNV ISN-SC
61	OSRAM/SYLVANIA	QHE 4X32T8/UNV ISN-SC
62	OSRAM/SYLVANIA	QTP 4X32T8/347 ISN-SC
63	OSRAM/SYLVANIA	QHE 4X32T8/UNV ISH-SC
64	OSRAM/SYLVANIA	QTP 4X32T8/UNV ISN-SC
65	PHILIPS/ADVANCE	IOPA-1P32-N
66	PHILIPS/ADVANCE	QTP1X32T8/UNV PSN-SC
67	PHILIPS/ADVANCE	ICN-1P32-N
68	PHILIPS/ADVANCE	IOPA-1P32-N

○ **Continuation of Ballast Compatibility List . . .**

NO.	BRAND	MODEL NO.
69	PHILIPS/ADVANCE	IOP-2P32-LW-SC
70	PHILIPS/ADVANCE	IOP-2P32-LW-SC
71	PHILIPS/ADVANCE	IOP-2P32-SC
72	PHILIPS/ADVANCE	IOP-2P32HL-SC
73	PHILIPS/ADVANCE	GOPA-2P32-SC
74	PHILIPS/ADVANCE	IOP-2PSP32-SC
75	PHILIPS/ADVANCE	REB-2P32-SC
76	PHILIPS/ADVANCE	IOPA-2P32-LW-N
77	PHILIPS/ADVANCE	ICN-2S40-N
78	PHILIPS/ADVANCE	IOP-3P32-LW-SC
79	PHILIPS/ADVANCE	IOPA-3P32-LW-N
80	PHILIPS/ADVANCE	IOP-3PSP32-SC
81	PHILIPS/ADVANCE	QTP3X32T8/UNV ISH-SC
82	PHILIPS/ADVANCE	ICN-3P32-N
83	PHILIPS/ADVANCE	IOPA-3P32-N
84	PHILIPS/ADVANCE	IOP-3P32-N
85	PHILIPS/ADVANCE	ICN-3P32-N
86	PHILIPS/ADVANCE	IOP-3PSP32-SC
87	PHILIPS/ADVANCE	IOP-3PSP32-LW-SC
88	PHILIPS/ADVANCE	IOP-3P32-N
89	PHILIPS/ADVANCE	ICN-3P32-N
90	PHILIPS/ADVANCE	IOP-4PSP32-SC
91	PHILIPS/ADVANCE	IOPA-4P32-N
92	PHILIPS/ADVANCE	QHE 4X32T8/UNV ISL-SC
93	PHILIPS/ADVANCE	IOP-4P32-SC
94	PHILIPS/ADVANCE	IOP-4P32-LW-N
95	PHILIPS/ADVANCE	ICN-4P32-N
96	PHILIPS/ADVANCE	IOPA-4P32-SC
97	PHILIPS/ADVANCE	ICN-4P32-N
98	PHILIPS/ADVANCE	IOP-4P32-N
99	ADVANCE	ICN-2P32-SC
100	ADVANCE	REL-2P32-SC
101	ADVANCE	ICN-2P32-SC
102	ADVANCE	IOP-2P32-N

NO.	BRAND	MODEL NO.
103	ADVANCE	ICN-4P32-SC
104	Universal	B232IUNVHE-A
105	Universal	B232PUNVHE-B
106	Universal	B232IUNVHP-N
107	Universal	B232IUNVHP-N
108	Universal	B232IUNVHE-A
109	Universal	B332IUNVHP-A
110	Universal	B332IUNVHE-A
111	Universal	B432IUNVHP-A
112	Universal	B432IUNVHP-A
113	Universal	B432IUNVHE-A
114	WORKHORSE3	WH3-120-L
115	WORKHORSE3	WH3-120-L
116	WORKHORSE3	WHCG3-120-T8-IS
117	WORKHORSE3	WH3-277-L
118	WORKHORSE3	WH3-120-C
119	HOWARD	EP2/32IS/MV/MC/HE
120	HOWARD	EP3/32IS/MV/MC/HE
121	HOWARD	EP3/32IS/MV/MC/HE
122	HOWARD	EP4/32IS/MV/MC/HE
123	HOWARD	EP4/32IS/MV/SC/HE
124	KEYSTONE	KTEB-232-UV-IS-N-P
125	KEYSTONE	KTEB-232RIS-1-TP-SL
126	KEYSTONE	KTEB-332-UV-IS-H-P
127	KEYSTONE	KTEB-432-UV-IS-N-P
128	SUNPAK	U-2/32ISE
129	SUNPAK	U-3/32ISE-LBF
130	SUNPAK	U-3/32ISE
131	SUNPAK	U-4/32ISE-HBF
132	GELICOTRON	B260I277RH
133	ST NDARD	E232T8IS/N/BULK
134	ACCUPRO	AP-RS-232IS-120
135	DAMAR	1688A
136	ROBERTSON	ISU232T8120