

# SYLVANIA Lamps

## DULUX® LED Pin Base Lamps

LED replacement for conventional Compact Fluorescent Lamps for use in ECG luminaires or directly on line voltage

### Application

DULUX LED Pin Based lamps are an energy saving alternative, designed to replace traditional compact fluorescent lamps. These LED lamps contain no mercury, and provide instant light and a uniform light distribution. These lamps are offered in SubstiTUBE® (UL Type A/ballast compatible), LEDlescent™ (UL Type B/ballast-free), or DUALescent™ (UL Type A+B), depending on which family/wattage is chosen. These lamps also minimize labor and recycling costs.

### Benefits and Features

- DLC listed lamps allow for rebates in areas where applicable, saving on overall project cost
- System LPW varies from 93 to 134
- CRI >80
- Offered in 6, 7, 8, 8.5, 9.5, 15 or 16 watts
- Available beam angle:
  - Omnidirectional lamps with 360° beam angle and light emitting angle of 360°
  - High output lamps with either 110° or 120° beam angle and light emitting angle of 260°
  - CCT Selectable lamps with either 110° or 120° beam angle and light emitting angle of 150° or 360°
- Energy savings up to 68%

### Electrical

- SubstiTUBE lamps are compatible with electronic (4-pin) or magnetic (2-pin GX23) ballast. LEDlescent lamps are operated directly wired to line voltage. DUALescent can be operated either on magnetic ballasts or directly wired to line voltage, either 2-pin or 4-pin lamp holders.
- 0-10V dimmable with select compatible 0-10V dimming ballasts
- Power Factor >0.9
- THD <20%

### Rated Life

- 50,000 hours (L<sub>70</sub>)

### Warranty

- 5 year limited lamp warranty (24/7 operation)
- NLB Trusted Warranty Program

### Ambient Operating Range

- -4°F to +104°F (-20°C to +40°C)



### Wattage Comparison

Traditional Source	Traditional System Wattage	LED System Wattage	Energy Savings
CF42DT/E w/QTP2X26/32/42CF/UNV DM	94	30	68%
CF32DT/E w/QTP2X26/32/42CF/UNV DM	69	30	57%
CF26DD/E w/QTP2X26/CF/UNV DM	54	19	65%
CF18DD/E w/QTP1/2X18CF/UNV DM	38	14	63%
CF26DD/E w/QTP2X26/CF/UNV DM	54	19	65%
CF42DT/E w/QTP2X26/32/42CF/UNV DM	94	31	67%
CF32DT/E w/QTP2X26/32/42CF/UNV DM	69	33	52%
CF26DD w/C2642UNVME	26	8.5	67%
CF18DD w/C218UNVME	18	7	61%
CF26DD w/C2642UNVME	26	9	65%

\*Energy savings over life of lamp calculated at \$0.11/kWh

### Certifications and Listings

- cULus 1993, cULus 1598c for Type B lamps
- DLC 5.1 for some lamps
- RoHS
- NSF Listed: NSF/ANSI Standard 2 – Food Equipment
- FCC Title 47 CFR, Part 15 Non-Consumer
- Mercury Free

### Installation

Please refer to the installation manual included inside the packaging for more information.



Catalog #	Type
Project	
Comments	
Prepared by	

Ordering Guide

LED	XX	PB	XXXX	X	DIM	8	XX	XXX
Product Name	Wattage	Pin Base	Base Type	Orientation	Dimmable	CRI	Color Temperature	UL Type
LED = LED Technology	6 = 6W 7 = 7W 8.5 = 8.5W 9 = 9W 9.5 = 9.5W 15 = 15W 16 = 16W		G24D = 2-pin G24Q = 4-pin GX23 = 2-pin	V = Vertical H = Horizontal O = Omnidirectional		8 = 80+	27 = 2700K 30 = 3000K 35 = 3500K 41 = 4100K SC1 = CCT Selectable 3000K/3500K/4100K	BF = Type B SUB = Type A AB = Type AB

Ordering Information

Item Number	Ordering Abbreviation	Lamp Wattage (W)	Base Type	Replaces	Input Voltage (V)	Avg. Life (hrs)	CCT	Typical Lumens (lm)	CRI	Power Factor	Bulb Finish	Case Qty.	DLC Listed*
<b>SubstiTUBE</b>													
40448	LED6PBGX23H827	6	GX23	CF13DS/ECO	Ballast dependent	50,000	2700K	625	80+	>0.9	Frosted Glass	24	N/A
40449	LED6PBGX23H835	6	GX23	CF13DS/ECO	Ballast dependent	50,000	3500K	625	80+	>0.9	Frosted Glass	24	N/A
40450	LED6PBGX23H841	6	GX23	CF13DS/ECO	Ballast dependent	50,000	4100K	625	80+	>0.9	Frosted Glass	24	N/A
<b>SubstiTUBE High Output</b>													
41705	LED15PBG24QHDIM830SUB	15	G24Q/GX24Q	CF42DT/E	Ballast dependent	50,000	3000K	1900	80+	>0.9	Plastic	24	v.5.1
41706	LED15PBG24QVDIM830SUB	15	G24Q/GX24Q	CF32DT/E	Ballast dependent	50,000	3000K	2000	80+	>0.9	Plastic	24	v.5.1
41707	LED15PBG24QHDIM835SUB	15	G24Q/GX24Q	CF42DT/E	Ballast dependent	50,000	3500K	1900	80+	>0.9	Plastic	24	v.5.1
41708	LED15PBG24QVDIM835SUB	15	G24Q/GX24Q	CF32DT/E	Ballast dependent	50,000	3500K	2000	80+	>0.9	Plastic	24	v.5.1
41709	LED15PBG24QHDIM841SUB	15	G24Q/GX24Q	CF42DT/E	Ballast dependent	50,000	4100K	1900	80+	>0.9	Plastic	24	v.5.1
41710	LED15PBG24QVDIM841SUB	15	G24Q/GX24Q	CF32DT/E	Ballast dependent	50,000	4100K	2000	80+	>0.9	Plastic	24	v.5.1
<b>SubstiTUBE CCT Selectable</b>													
41701	LED9.5PBG24QHDIM8SC1SUB	9.5	G24Q/GX24Q	CF26DD/E	Ballast dependent	50,000	3000K, 3500K, 4100K	960 1020 1050	80+	>0.9	Plastic	24	v.5.1
41702	LED9.5PBG24QVDIM8SC1SUB	9.5	G24Q/GX24Q	CF26DD/E	Ballast dependent	50,000	3000K, 3500K, 4100K	1100 1120 1150	80+	>0.9	Plastic	24	v.5.1
<b>SubstiTUBE Omnidirectional</b>													
41711	LED7PBG24QODIM827SUB	7	G24Q/GX24Q	CF18DD/E	Ballast dependent	50,000	2700K	820	80+	>0.9	Plastic	24	N/A
41712	LED7PBG24QODIM830SUB	7	G24Q/GX24Q	CF18DD/E	Ballast dependent	50,000	3000K	820	80+	>0.9	Plastic	24	N/A
41713	LED7PBG24QODIM835SUB	7	G24Q/GX24Q	CF18DD/E	Ballast dependent	50,000	3500K	820	80+	>0.9	Plastic	24	N/A
41714	LED7PBG24QODIM841SUB	7	G24Q/GX24Q	CF18DD/E	Ballast dependent	50,000	4100K	820	80+	>0.9	Plastic	24	N/A
41715	LED9.5PBG24QODIM827SUB	9.5	G24Q/GX24Q	CF26DD/E	Ballast dependent	50,000	2700K	1200	80+	>0.9	Plastic	24	N/A
41716	LED9.5PBG24QODIM830SUB	9.5	G24Q/GX24Q	CF26DD/E	Ballast dependent	50,000	3000K	1200	80+	>0.9	Plastic	24	N/A
41717	LED9.5PBG24QODIM835SUB	9.5	G24Q/GX24Q	CF26DD/E	Ballast dependent	50,000	3500K	1200	80+	>0.9	Plastic	24	N/A
41718	LED9.5PBG24QODIM841SUB	9.5	G24Q/GX24Q	CF26DD/E	Ballast dependent	50,000	4100K	1200	80+	>0.9	Plastic	24	N/A
<b>Go to Page 6 for more SubstiTUBE Lamps</b>													
<b>LEDlescent High Output</b>													
41695	LED15PBG24DH830BF	15	G24D/G24Q/GX24Q	CF42DT/E	120-277	50,000	3000K	1900	80+	>0.9	Plastic	24	N/A
41697	LED15PBG24DH835BF	15	G24D/G24Q/GX24Q	CF42DT/E	120-277	50,000	3500K	1900	80+	>0.9	Plastic	24	N/A
41699	LED15PBG24DH841BF	15	G24D/G24Q/GX24Q	CF42DT/E	120-277	50,000	4100K	1900	80+	>0.9	Plastic	24	N/A
41696	LED16PBG24DV830BF	16	G24D/G24Q/GX24Q	CF32DT/E	120-277	50,000	3000K	2000	80+	>0.9	Plastic	24	N/A
41698	LED16PBG24DV835BF	16	G24D/G24Q/GX24Q	CF32DT/E	120-277	50,000	3500K	2000	80+	>0.9	Plastic	24	N/A
41700	LED16PBG24DV841BF	16	G24D/G24Q/GX24Q	CF32DT/E	120-277	50,000	4100K	2000	80+	>0.9	Plastic	24	N/A
<b>DUALescent CCT Selectable</b>													
41691	LED8.5PBG24DH8SC1AB	8.5	G24D/G24Q/GX24Q	CF26DD	Ballast dependent or 120-277	50,000	3000K, 3500K, 4100K	960 1020 1050	80+	>0.9	Plastic	24	N/A
41692	LED8.5PBG24DV8SC1AB	8.5	G24D/G24Q/GX24Q	CF26DD	Ballast dependent or 120-277	50,000	3000K, 3500K, 4100K	1100 1120 1150	80+	>0.9	Plastic	24	N/A
<b>DUALescent Omnidirectional</b>													
41719	LED7PBG24D0827AB	7	G24D/G24Q/GX24Q	CF18DD	Ballast dependent or 120-277	50,000	2700K	830	80+	>0.9	Plastic	24	N/A
41720	LED7PBG24D0830AB	7	G24D/G24Q/GX24Q	CF18DD	Ballast dependent or 120-277	50,000	3000K	880	80+	>0.9	Plastic	24	N/A
41721	LED7PBG24D0835AB	7	G24D/G24Q/GX24Q	CF18DD	Ballast dependent or 120-277	50,000	3500K	880	80+	>0.9	Plastic	24	N/A
41722	LED7PBG24D0841AB	7	G24D/G24Q/GX24Q	CF18DD	Ballast dependent or 120-277	50,000	4100K	900	80+	>0.9	Plastic	24	N/A

\*No DLC category for lamps with N/A

## Ordering Information (continued)

Item Number	Ordering Abbreviation	Lamp Wattage (W)	Base Type	Replaces	Input Voltage (V)	Avg. Life (hrs)	CCT	Typical Lumens (lm)	CRI	Power Factor	Bulb Finish	Case Qty.	DLC Listed*
41723	LED9PBG24D0827AB	9	G24D/G24Q/GX24Q	CF26DD	Ballast dependent or 120-277	50,000	2700K	1150	80+	>0.9	Plastic	24	N/A
41724	LED9PBG24D0830AB	9	G24D/G24Q/GX24Q	CF26DD	Ballast dependent or 120-277	50,000	3000K	1200	80+	>0.9	Plastic	24	N/A
41725	LED9PBG24D0835AB	9	G24D/G24Q/GX24Q	CF26DD	Ballast dependent or 120-277	50,000	3500K	1250	80+	>0.9	Plastic	24	N/A
41726	LED9PBG24D0841AB	9	G24D/G24Q/GX24Q	CF26DD	Ballast dependent or 120-277	50,000	4100K	1250	80+	>0.9	Plastic	24	N/A

\*No DLC category for lamps with N/A

## Specifications & Lighting Data

Lamp	Ballast	Current (AMPS) (120V/277V)	System Power (W)	System Lumens (lm)*	System Efficacy (lm/W)	No of Lamps
LED15PBG24QHDIM8XXSUB	QTP2X26/32/42CF/UNV DM	0.25/0.11	30	3800	127	2
LED15PBG24QVDIM8XXSUB	QTP2X26/32/42CF/UNV DM	0.25/0.11	30	4100	137	2
LED15PBG24DH8XXBF	N/A	0.25/0.16	30	3800	127	2
LED16PBG24DV8XXBF	N/A	0.27/0.11	32	4100	128	2
LED9.5PBG24QHDIM8SC1SUB	QTP2X26/CF/UNV DM	0.08/0.03	9.5	1020	107	1
LED9.5PBG24QVDIM8SC1SUB	QTP2X26/CF/UNV DM	0.08/0.03	9.5	1120	118	1
LED8.5PBG24DH8SC1AB	QTP2X26/CF/UNV DM	0.07/0.03	8.5	1020	120	1
LED8.5PBG24DV8SC1AB	QTP2X26/CF/UNV DM	0.07/0.03	8.5	1120	132	1
LED7PBG24QODIM8XXSUB	QTP1/2X18CF/UNV DM	0.06/0.03	7	830	119	1
LED9.5PBG24QODIM8XXSUB	QTP2X26/CF/UNV DM	0.08/0.03	9.5	1200	126	1
LED7PBG24D08XXAB	C218UNVME	0.06/0.03	7	880	126	1
LED9PBG24D08XXAB	C2642UNVME	0.08/0.03	9	1250	139	1

\*NOTE: System lumens are represented by values for 3500K.

## Physical Information

Lamp Description	Max. Overall Length (mm)	Base Face to Top of Lamp (mm)	Max. Base Width (Side) (mm)	Guide Post Length (mm)
LED15PBG24QHDIM8XXSUB LED15PBG24DHF	169	153.5	45.0	15.5
LED15PBG24QVDIM8XXSUB LED16PBG24DVBF	162.5	147.0	88	15.5
LED8.5PBG24DHSC1AB	130.0	114.5	70	15.5
LED9.5PBG24QVDIM8SC1SUB LED8.5PBG24DV8SC1AB	161.4	145.9	33.2	15.5
LED7PBG24QODIM8XXSUB LED7PBG24D08XXAB	144.5	129.0	34.5	15.5
LED9PBG24D08XXAB	174.5	159.0	34.5	15.5
LED6PBGX238XX	172.0	157.0	27	15

### 7W Omnidirectional SubstiTUBE® and DUALescent™

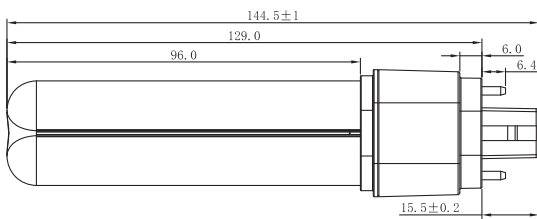

### 9W Omnidirectional SubstiTUBE and DUALescent

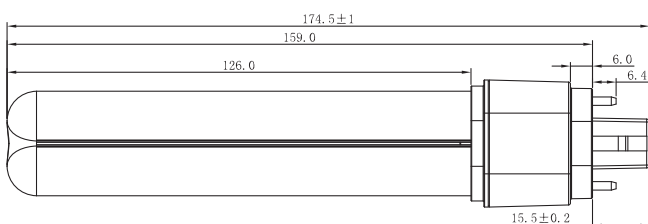

### DUALescent UL Type A+B Base – G24d

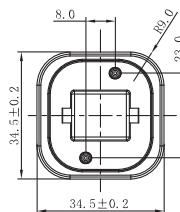

### SubstiTUBE UL Type A Base – G24q

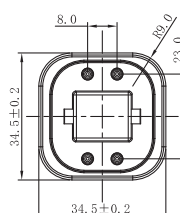

### 6W SubstiTUBE Base – GX23

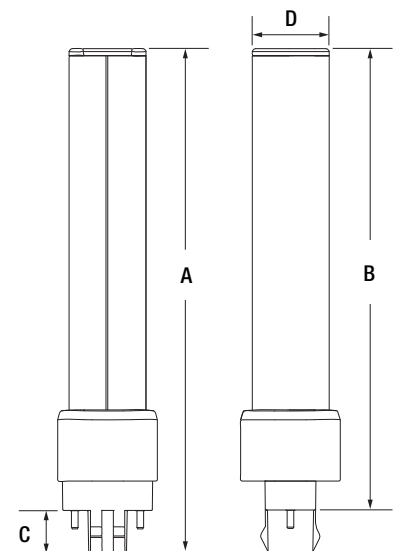

**Physical Information (continued)**

**CCT Selectable UL Type A SubstiTUBE® and UL Type A+B DUALescent™ Horizontal**

**Front View**

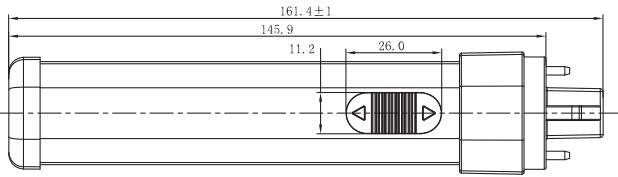

**Side View**

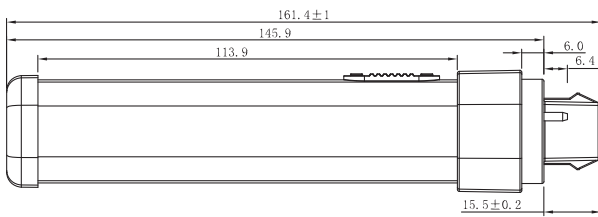

**DUALescent UL Type A+B Base – G24d**

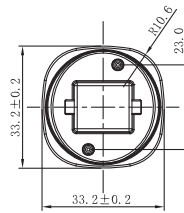

**SubstiTUBE UL Type A Base – G24q**

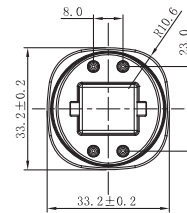

**CCT Selectable UL Type A SubstiTUBE Horizontal**

**Side View**

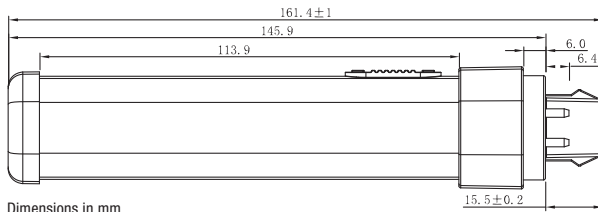

Dimensions in mm

**CCT Selectable UL Type A SubstiTUBE and UL Type A+B DUALescent Vertical**

**Front View**

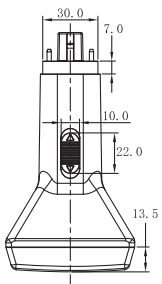

**Side View**

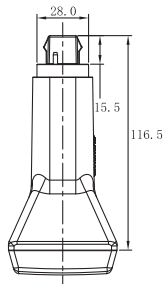

**CCT Selectable UL Type A SubstiTUBE Vertical**

**Side View**

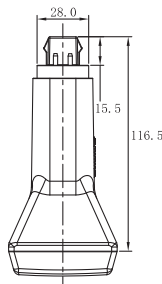

**DUALescent UL Type A+B Base – G24d**

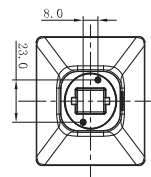

**SubstiTUBE UL Type A Base – G24q**

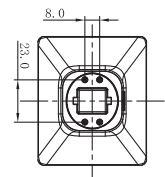

**Physical Information (continued)**

**High Output UL Type A SubstiTUBE® and  
UL Type B LEDlescent™ Horizontal**

**Front View**

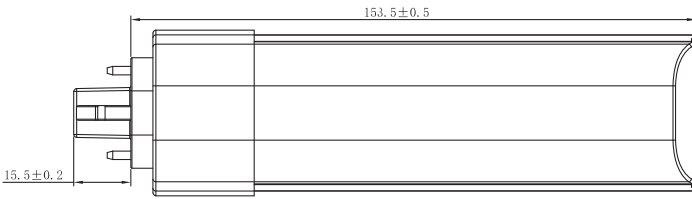

**High Output UL Type A SubstiTUBE Horizontal**

**Side View**

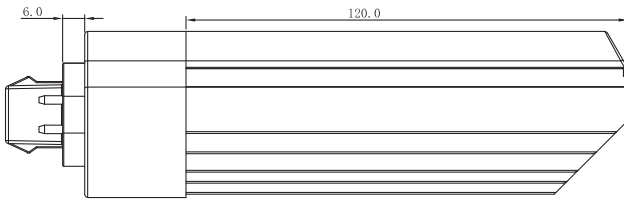

**LEDlescent UL Type B  
Base – G24d**

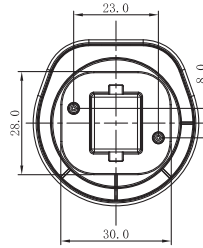

**SubstiTUBE UL Type A  
Base – G24q**

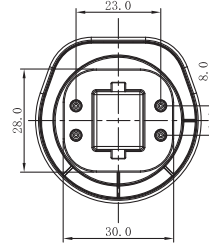

**High Output UL Type B LEDlescent Horizontal**

**Side View**

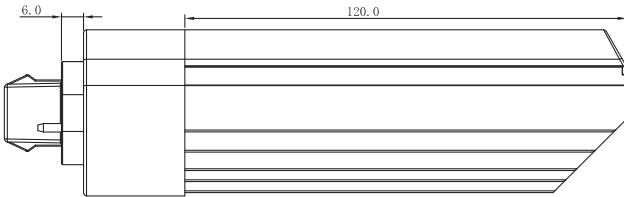

**High Output UL Type A SubstiTUBE Vertical**

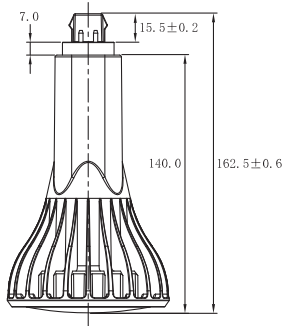

**LEDlescent UL Type B  
Base – G24d**

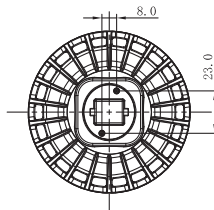

**SubstiTUBE UL Type A  
Base – G24q**

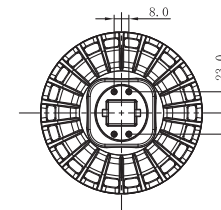

**High Output UL Type B LEDlescent Vertical**

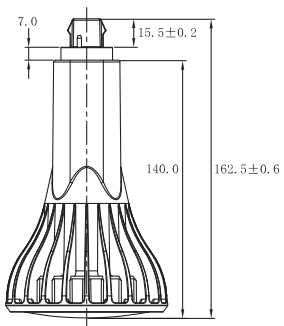

Dimensions in mm

## Specifications

**EMI/RFI:** FCC Title 47 CFR, Part 18, Non-Consumer (GX24q) and Part 15, Class B (GX23)

## Ordering Guide

<b>LED</b>	<b>9</b>	<b>/</b>	<b>PB</b>	<b>/</b>	<b>GX24</b>	<b>/</b>	<b>H</b>	<b>/</b>	<b>8</b>	<b>35</b>	<b>G2</b>
LED Lamp	Wattage		Pin Base		Base Type		Orientation		CRI= 80+	Color Temperature	Generation

## Ordering Information

Item Number	Ordering Abbreviation	Configuration	Wattage	Lumens (lm)	CCT	CRI	DIM	DLC (Y/N)
40018*	LED9PBGX24QV830G2	Vertical	9W	950	3000K	80	No	N
40407*	LED16/PB/GX24Q/H/830	Horizontal	16W	1750	3000K	80	No	Y
40412*	LED16/PB/GX24Q/V/835	Vertical	16W	1750	3500K	80	No	Y
40413*	LED16/PB/GX24Q/V/841	Vertical	16W	1850	4100K	80	No	Y

\*The above lamps will be phasing out with the introduction of our new portfolio. Upon depletion of inventory, the lamps will be obsolete.

## Lamp Dimensions

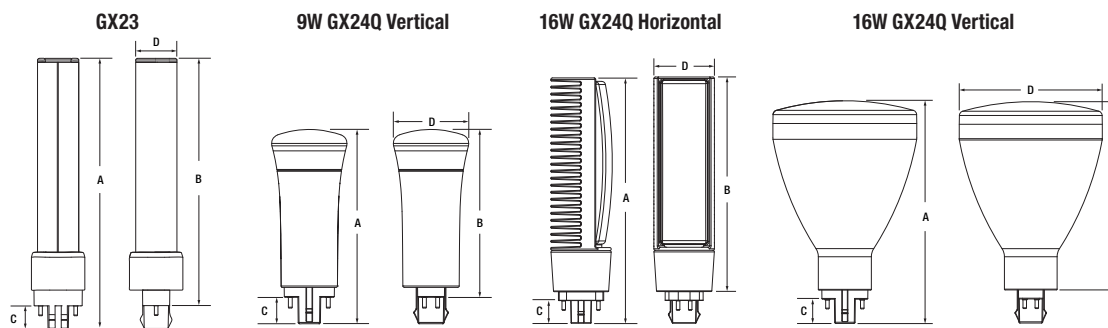

Ordering Abbreviation	(A) Max. Overall Length	(B) Base Face to Top of Lamp	(C) Guide Post Length	(D) Max. Base Width (Front)	(E) Max. Base Width (Side)
GX23	6.77" (172mm)	6.18" (157mm)	.59" (15mm)	1.06" (27mm)	
9W GX24Q Vertical	4.63" (117.5mm)	4.0" (101.5mm)	.63" (16mm)	1.81" (46mm)	
16W GX24Q Horizontal	6.40" (162.6mm)	5.82" (147.7mm)	.59" (15mm)	1.59" (40mm)	1.61" (41mm)
16W GX24Q Vertical	5.81" (147.5mm)	5.18" (131.5mm)	.63" (16mm)	3.74" (95mm)	N/A

LEDVANCE LLC  
 181 Ballardvale Street  
 Wilmington, MA 01887 USA  
 Phone 1-800-LIGHTBULB (1-800-544-4828)  
 www.ledvanceUS.com

SYLVANIA and LEDVANCE are registered trademarks.  
 All other trademarks are those of their respective owners.  
 Licensee of product trademark SYLVANIA in general lighting.  
 Specifications subject to change without notice.

[/sylvania](#) [/sylvania](#)

