

# SYLVANIA Lamps

## DULUX® LED Pin Base Lamps

LED replacement for conventional Compact Fluorescent Lamps for use with existing ballast or directly on line voltage

### Application

DULUX LED Pin Based lamps are an energy saving alternative, designed to replace traditional compact fluorescent lamps. These LED lamps contain no mercury, and provide instant light and a uniform light distribution. These lamps are offered in SubstiTUBE® (UL Type A/ballast compatible), LEDlescent™ (UL Type B/ballast-free), or DUALescent™ (UL Type A+B), depending on which family/wattage is chosen. These lamps also minimize labor and recycling costs.

### Benefits and Features

- DLC listed lamps allow for rebates in areas where applicable, saving on overall project cost
- System LPW varies from 93 to 134
- Frosted Plastic finish; CRI >80
- Offered in 3.5, 5.5, 6, 7, 8, 8.5, 9.5, 15, 16 or 17 watts
- Available beam angle:
  - Omnidirectional lamps with 360° beam angle and light emitting angle of 360°
  - High output lamps with either 110° or 120° beam angle and light emitting angle of 260°
  - CCT Selectable lamps with either 110° or 120° beam angle and light emitting angle of 150° or 360°
  - Ultra thin beam angle 160°, and light emitting area 320°
- Energy savings up to 68%
- Can be used in enclosed (lens or diffuser) luminaire. Not approved for use in vapor tight or sealed luminaire.
- Check Pin Based Socket Guide for CFL to LED cross information



Pin Based Socket Guide

### Electrical

- SubstiTUBE lamps are compatible with electronic (4-pin) or magnetic (2-pin GX23) ballast; LEDlescent lamps are operated directly wired to line voltage. In Type A mode, DUALescent lamps with 2-pins operate on magnetic ballasts, lamps with 4-pins operate on electronic ballasts and all can be wired directly to line voltage in Type B mode.
- Lamps with “DIM” in the description are 0-10V dimmable with select compatible 0-10V dimming ballasts
- Power Factor >0.9
- THD <20%
- When operating in UL Type B mode, lamps are compatible with LEDVANCE Emergency Battery Backup (75740)



Emergency Battery Backup Information



### Wattage Comparison

Traditional Source	Traditional System Wattage	LED System Wattage	Energy Savings
CF42DT/E w/QTP2X26/32/42CF/UNV DM	94	30	68%
CF32DT/E w/QTP2X26/32/42CF/UNV DM	69	30	57%
CF26DD/E w/QTP2X26/CF/UNV DM	54	19	65%
CF18DD/E w/QTP1/2X18CF/UNV DM	38	14	63%
CF26DD/E w/QTP2X26/CF/UNV DM	54	19	65%
CF42DT/E w/QTP2X26/32/42CF/UNV DM	94	31	67%
CF32DT/E w/QTP2X26/32/42CF/UNV DM	69	33	52%
CF26DD w/C2642UNVME	26	8.5	67%
CF18DD w/C218UNVME	18	7	61%
CF26DD w/C2642UNVME	26	9	65%
CF7DS/8XX or CF9DS/8XX	7	3.5	50%
CF13DS/8XX	13	5.5	58%
CF7DS/E/8XX or CF9DS/E/8XX	7	3.5	50%
CF13DS/E/8XX	13	5.5	58%

\*Energy savings over life of lamp calculated at \$0.11/kWh

### Rated Life

- 50,000 hours (L<sub>70</sub>)

### Warranty

- 5 year limited lamp warranty (24/7 operation)
- NLB Trusted Warranty Program

### Ambient Operating Range

- -4°F to +104°F (-20°C to +40°C)



LED581R13 9-25



Catalog #	Type
Project	
Comments	
Prepared by	

**Certifications and Listings**

- cULus (UL1598c, UL1993, & CSA 22.2 for UL Type B & Type A+B; UL1993 & CSA 22.2 for Type A)
- DLC 5.1 for some lamps
- RoHS
- NSF Listed: NSF/ANSI Standard 2 – Food Equipment
- FCC Title 47 CFR, Part 15 Non-Consumer (UL Type B & UL Type A+B) or Part 18 Non-Consumer (UL Type A), ICES
- Mercury Free

**Installation**

- Please refer to the installation manual included inside the packaging for more information.
- For proper use and warranty coverage, installer must consult the ballast compatibility list to ensure that the lamp and ballast combination is deemed compatible and will operate as intended.
- Base types can be used to replace more lamps than the traditional lamp indicated in the table below due to the keys being omitted on the base. To ensure the product can be used in the application, check size and lumen output for best results.



**Ballast Compatibility Guide**

**Ordering Guide**

LED	XX	PB	XXXX	X	DIM	8	XXX	XXX
Product Name	Wattage	Pin Base	Base Type	Orientation	Dimmable	CRI	Color Temperature	UL Type
LED = LED Technology	3,5 = 3,5W 5,5 = 5,5W 6 = 6W 7 = 7W 8,5 = 8,5W 9 = 9W 9,5 = 9,5W 15 = 15W 16 = 16W 17 = 17W		2G7 = 4-pin 2GX7 = 4-pin G23 = 2-pin GX23 = 2-pin G24D = 2-pin GX24D = 2-pin G24Q = 4-pin	V = Vertical H = Horizontal O = Omnidirectional		8 = 80+	27 = 2700K 30 = 3000K 35 = 3500K 41 = 4100K SC1 = CCT Selectable 3000K/3500K/4100K SC8 = CCT Selectable 3000K/3500K/4100K/5000K SC16 = CCT Selectable 2700K/3000K/3500K/4100K	SUB = Type A BF = Type B AB = Type A+B

**Ordering Information**

Item Number	Ordering Abbreviation	Lamp Wattage (W)	Base Type	UL Type	Orientation	Replaces	Input Voltage (V)	Avg. Life (hrs)	CCT	Typical Lumens (lm)	Case Qty.	DLC Listed*
<b>SubstiTUBE® High Output</b>												
41705**‡	LED15PBG24QHDIM830SUB	15	G24Q/GX24Q	A	Horizontal	CF42DT/E	Ballast dependent	50,000	3000K	1900	24	5.1
41706**	LED15PBG24QVDIM830SUB	15	G24Q/GX24Q	A	Vertical	CF42DT/E	Ballast dependent	50,000	3000K	2000	24	5.1
41707**‡	LED15PBG24QHDIM835SUB	15	G24Q/GX24Q	A	Horizontal	CF42DT/E	Ballast dependent	50,000	3500K	1900	24	5.1
41708**	LED15PBG24QVDIM835SUB	15	G24Q/GX24Q	A	Vertical	CF42DT/E	Ballast dependent	50,000	3500K	2000	24	5.1
41709**‡	LED15PBG24QHDIM841SUB	15	G24Q/GX24Q	A	Horizontal	CF42DT/E	Ballast dependent	50,000	4100K	1900	24	5.1
41710**	LED15PBG24QVDIM841SUB	15	G24Q/GX24Q	A	Vertical	CF42DT/E	Ballast dependent	50,000	4100K	2000	24	5.1
<b>SubstiTUBE CCT Selectable</b>												
41701**‡	LED9.5PBG24QHDIM8SC1SUB	9.5	G24Q/GX24Q	A	Horizontal	CF26DD/E	Ballast dependent	50,000	3000K/3500K/4100K	960 1020 1050	24	5.1
41702**	LED9.5PBG24QVDIM8SC1SUB	9.5	G24Q/GX24Q	A	Vertical	CF26DD/E	Ballast dependent	50,000	3000K/3500K/4100K	1100 1120 1150	24	5.1
<b>SubstiTUBE Omnidirectional</b>												
41711 <sup>†</sup>	LED7PBG24QODIM827SUB	7	G24Q/GX24Q	A	Omnidirectional	CF18DD/E	Ballast dependent	50,000	2700K	820	24	N/A
41712 <sup>†</sup>	LED7PBG24QODIM830SUB	7	G24Q/GX24Q	A	Omnidirectional	CF18DD/E	Ballast dependent	50,000	3000K	820	24	N/A
41713 <sup>†</sup>	LED7PBG24QODIM835SUB	7	G24Q/GX24Q	A	Omnidirectional	CF18DD/E	Ballast dependent	50,000	3500K	820	24	N/A
41714 <sup>†</sup>	LED7PBG24QODIM841SUB	7	G24Q/GX24Q	A	Omnidirectional	CF18DD/E	Ballast dependent	50,000	4100K	820	24	N/A
41715 <sup>†</sup>	LED9.5PBG24QODIM827SUB	9.5	G24Q/GX24Q	A	Omnidirectional	CF26DD/E	Ballast dependent	50,000	2700K	1200	24	N/A
41716 <sup>†</sup>	LED9.5PBG24QODIM830SUB	9.5	G24Q/GX24Q	A	Omnidirectional	CF26DD/E	Ballast dependent	50,000	3000K	1200	24	N/A
41717 <sup>†</sup>	LED9.5PBG24QODIM835SUB	9.5	G24Q/GX24Q	A	Omnidirectional	CF26DD/E	Ballast dependent	50,000	3500K	1200	24	N/A
41718 <sup>†</sup>	LED9.5PBG24QODIM841SUB	9.5	G24Q/GX24Q	A	Omnidirectional	CF26DD/E	Ballast dependent	50,000	4100K	1200	24	N/A
<b>LEDlescent™ High Output</b>												
41695 <sup>†‡</sup>	LED15PBG24DH830BF	15	G24D/G24Q/GX24Q	B	Horizontal	CF42DT/E	120-277	50,000	3000K	1900	24	N/A
41697 <sup>†‡</sup>	LED15PBG24DH835BF	15	G24D/G24Q/GX24Q	B	Horizontal	CF42DT/E	120-277	50,000	3500K	1900	24	N/A
41699 <sup>†‡</sup>	LED15PBG24DH841BF	15	G24D/G24Q/GX24Q	B	Horizontal	CF42DT/E	120-277	50,000	4100K	1900	24	N/A
41696 <sup>†</sup>	LED16PBG24DV830BF	16	G24D/G24Q/GX24Q	B	Vertical	CF42DT/E	120-277	50,000	3000K	2000	24	N/A
41698 <sup>†</sup>	LED16PBG24DV835BF	16	G24D/G24Q/GX24Q	B	Vertical	CF42DT/E	120-277	50,000	3500K	2000	24	N/A
41700 <sup>†</sup>	LED16PBG24DV841BF	16	G24D/G24Q/GX24Q	B	Vertical	CF42DT/E	120-277	50,000	4100K	2000	24	N/A

\*No DLC category for lamps with N/A  
 \*\*Can be used in enclosed (lens or diffuser) luminaire. Not approved for use in vapor tight or sealed luminaire.  
 †Not suitable for use in enclosed (lens or diffuser) luminaire. Not approved for use in vapor tight or sealed luminaire.  
 ‡Products indicated have rotatable bases for adjusting direction of light output

## Ordering Information (continued)

Item Number	Ordering Abbreviation	Lamp Wattage (W)	Base Type	UL Type	Orientation	Replaces	Input Voltage (V)	Avg. Life (hrs)	CCT	Typical Lumens (lm)	Case Qty.	DLC Listed*
<b>LEDlescent High Output Omnidirectional</b>												
42505†	LED15PBGX24D08SC8BF	15	GX24D	B	Omnidirectional	CF32DT/E	120-277	50,000	3000/3500/4100/5000K	1900/2000/2100/2200	24	N/A
42506†	LED17PBGX24D08SC8BF	17	GX24D	B	Omnidirectional	CF42DT/E	120-277	50,000	3000/3500/4100/5000K	2200/2300/2400/2500	24	N/A
<b>LEDlescent™ Ultra Thin</b>												
42068**	LED3,5PB2G7H827BF	3.5	2G7	B	Horizontal	CF7DS/E or CF9DS/E	120-277	50,000	2700K	330	24	N/A
42069**	LED3,5PB2G7H830BF	3.5	2G7	B	Horizontal	CF7DS/E or CF9DS/E	120-277	50,000	3000K	340	24	N/A
42070**	LED3,5PB2G7H835BF	3.5	2G7	B	Horizontal	CF7DS/E or CF9DS/E	120-277	50,000	3500K	350	24	N/A
42071**	LED3,5PB2G7H841BF	3.5	2G7	B	Horizontal	CF7DS/E or CF9DS/E	120-277	50,000	4100K	360	24	N/A
42072**	LED5,5PB2GX7H827BF	5.5	2GX7	B	Horizontal	CF13DS/E	120-277	50,000	2700K	550	24	N/A
42073**	LED5,5PB2GX7H830BF	5.5	2GX7	B	Horizontal	CF13DS/E	120-277	50,000	3000K	550	24	N/A
42074**	LED5,5PB2GX7H835BF	5.5	2GX7	B	Horizontal	CF13DS/E	120-277	50,000	3500K	570	24	N/A
42075**	LED5,5PB2GX7H841BF	5.5	2GX7	B	Horizontal	CF13DS/E	120-277	50,000	4100K	590	24	N/A
<b>DUALescent™ CCT Selectable</b>												
41691***	LED8,5PBG24DH8SC1AB	8.5	G24D/G24Q/GX24Q	A+B	Horizontal	CF26DD	Ballast or 120-277	50,000	3000K/3500K/4100K	960/1020/1050	24	N/A
41692**	LED8,5PBG24DV8SC1AB	8.5	G24D/G24Q/GX24Q	A+B	Horizontal	CF26DD	Ballast or 120-277	50,000	3000K/3500K/4100K	1100/1120/1150	24	N/A
<b>DUALescent Omnidirectional</b>												
42503**	LED5,5PBGX2308SC16AB	5.5	GX23	A+B	Omnidirectional	CF13DD	Ballast or 120-277	50,000	2700/3000/3500/4100K	720/750/800/800	24	N/A
42504**	LED5,5PBG24D08SC16AB	5.5	G24D	A+B	Omnidirectional	CF13DD/E	Ballast or 120-277	50,000	2700/3000/3500/4100K	720/750/800/800	24	N/A
41719**	LED7PBG24D0827AB	7	G24D/G24Q/GX24Q	A+B	Omnidirectional	CF18DD	Ballast or 120-277	50,000	2700K	830	24	N/A
41720**	LED7PBG24D0830AB	7	G24D/G24Q/GX24Q	A+B	Omnidirectional	CF18DD	Ballast or 120-277	50,000	3000K	880	24	N/A
41721**	LED7PBG24D0835AB	7	G24D/G24Q/GX24Q	A+B	Omnidirectional	CF18DD	Ballast or 120-277	50,000	3500K	880	24	N/A
41722**	LED7PBG24D0841AB	7	G24D/G24Q/GX24Q	A+B	Omnidirectional	CF18DD	Ballast or 120-277	50,000	4100K	900	24	N/A
41723**	LED9PBG24D0827AB	9	G24D/G24Q/GX24Q	A+B	Omnidirectional	CF26DD	Ballast or 120-277	50,000	2700K	1150	24	N/A
41724**	LED9PBG24D0830AB	9	G24D/G24Q/GX24Q	A+B	Omnidirectional	CF26DD	Ballast or 120-277	50,000	3000K	1200	24	N/A
41725**	LED9PBG24D0835AB	9	G24D/G24Q/GX24Q	A+B	Omnidirectional	CF26DD	Ballast or 120-277	50,000	3500K	1250	24	N/A
41726**	LED9PBG24D0841AB	9	G24D/G24Q/GX24Q	A+B	Omnidirectional	CF26DD	Ballast or 120-277	50,000	4100K	1250	24	N/A
42508**	LED9PBG24D08SC16AB	9	G24D	A+B	Omnidirectional	CF26DD	Ballast or 120-277	50,000	2700/3000/3500/4100K	1050/1100/1200/1200	24	N/A
42507**	LED9PBG24Q0DIM8SC1AB	9.5	G24Q	A+B	Omnidirectional	CF26DD/E	Electronic Ballast or 120-277	50,000	3000/3500/4100K	1100/1200/1200	24	N/A
<b>DUALescent Ultra Thin</b>												
42060**	LED3,5PBG23H827AB	3.5	G23	A+B	Horizontal	CF7DS or CF9DS	Ballast or 120-277	50,000	2700K	330	24	N/A
42061**	LED3,5PBG23H830AB	3.5	G23	A+B	Horizontal	CF7DS or CF9DS	Ballast or 120-277	50,000	3000K	340	24	N/A
42062**	LED3,5PBG23H835AB	3.5	G23	A+B	Horizontal	CF7DS or CF9DS	Ballast or 120-277	50,000	3500K	350	24	N/A
42063**	LED3,5PBG23H841AB	3.5	G23	A+B	Horizontal	CF7DS or CF9DS	Ballast or 120-277	50,000	4100K	360	24	N/A
42509**	LED3,5PBG23H8SC16AB	3.5	G23	A+B	Horizontal	CF7DS	Ballast or 120-277	50,000	2700/3000/3500/4100K	360/370/380/400	24	N/A
42064**	LED5,5PBGX23H827AB	5.5	GX23	A+B	Horizontal	CF13DS	Ballast or 120-277	50,000	2700K	550	24	N/A
42065**	LED5,5PBGX23H830AB	5.5	GX23	A+B	Horizontal	CF13DS	Ballast or 120-277	50,000	3000K	550	24	N/A
42066**	LED5,5PBGX23H835AB	5.5	GX23	A+B	Horizontal	CF13DS	Ballast or 120-277	50,000	3500K	570	24	N/A
42067**	LED5,5PBGX23H841AB	5.5	GX23	A+B	Horizontal	CF13DS	Ballast or 120-277	50,000	4100K	590	24	N/A
42510**	LED5,5PBGX23H8SC16AB	5.5	GX23	A+B	Horizontal	CF13DS	Ballast or 120-277	50,000	2700/3000/3500/4100K	580/590/600/620	24	N/A

\*No DLC category for lamps with N/A

\*\*Can be used in enclosed (lens or diffuser) luminaire. Not approved for use in vapor tight or sealed luminaire.

†Not suitable for use in enclosed (lens or diffuser) luminaire. Not approved to use in vapor tight or sealed luminaire.

‡Products indicated have rotatable bases for adjusting direction of light output

## Specifications & Lighting Data

Lamp	UL Type	Current (AMPS) (120V/277V)	System Power (W)	System Lumens (lm)*	System Efficacy (lm/W)	No of Lamps
LED15PBG24Q(HDIM8XXSUB	Type A	0.25/0.11	30	3800	127	2
LED15PBG24QVDIM8XXSUB	Type A	0.25/0.11	30	4000	133	2
LED15PBG24DH8XXBF	Type B	0.25/0.16	30	3800	137	2
LED16PBG24DV8XXBF	Type B	0.27/0.11	32	4000	125	2
LED9.5PBG24QHDIM8SC1SUB	Type A	0.08/0.03	9.5	1150	121	1
LED9.5PBG24QVDIM8SC1SUB	Type A	0.08/0.03	9.5	1200	126	1
LED8.5PBG24DH8SC1AB	Type AB	0.07/0.03	8.5	1050	124	1
LED8.5PBG24DV8SC1AB	Type AB	0.07/0.03	8.5	1150	135	1
LED7PBG24QODIM8XXSUB	Type A	0.06/0.03	7	820	117	1
LED9.5PBG24QODIM8XXSUB	Type A	0.08/0.03	9.5	1200	126	1
LED7PBG24D08XXAB	Type AB	0.06/0.03	7	820	117	1
LED9PBG24D08XXAB	Type AB	0.08/0.03	9	1200	133	1
LED3.5PBG23H8XXAB	Type AB	0.03/0.01	3.5	340	97	1
LED5.5PBGX23H8XXAB	Type AB	0.05/0.02	5.5	550	100	1
LED3.5PB2G7H8XXBF	Type B	0.03/0.01	3.5	340	97	1
LED5.5PB2GX7H8XXBF	Type B	0.05/0.02	5.5	550	100	1
LED5.5PBGX2308SC16AB	Type AB	0.05/0.02	5.5	800	145	1
LED5.5PBG2408SC16AB	Type AB	0.05/0.02	5.5	800	145	1
LED9PBG24QODIM8SC1AB	Type AB	0.09/0.03	9.5	1200	126	1
LED9PBG24D08SC16AB	Type AB	0.09/0.03	9	1200	126	1
LED3.5PBG23H8SC16AB	Type AB	0.03/0.01	3.5	380	109	1
LED5.5PBGX23H8SC16AB	Type AB	0.05/0.02	5.5	600	109	1
LED15PBGX24D08SC8BF	Type B	0.14/0.05	15	2100	140	1
LED17PBGX24D08SC8BF	Type B	0.16/0.06	17	2400	141	1

\*Lumen at 4100K CCT.

## Physical Information

Lamp Description	Max. Overall Length inch (mm)	Base Face to Top of Lamp inch (mm)	Nominal Lamp Diameter/Width inch (mm)	Guide Post Length inch (mm)
LED15PBG24QHDIM8XXSUB	6.65 (169)	6.04 (153.5)	1.77 (45)	0.61 (15.5)
LED15PBG24QVDIM8XXSUB	6.40 (162.5)	5.79 (147)	3.46 (88)	0.61 (15.5)
LED15PBG24DH8XXBF	6.65 (169)	6.04 (153.5)	1.77 (45)	0.61 (15.5)
LED16PBG24DV8XXBF	6.40 (162.5)	5.79 (147)	3.46 (88)	0.61 (15.5)
LED9.5PBG24QHDIM8SC1SUB	6.35 (161.4)	5.74 (145.9)	1.31 (33.2)	0.61 (15.5)
LED9.5PBG24QVDIM8SC1SUB	5.11 (130)	4.51 (114.5)	2.76 (70)	0.61 (15.5)
LED8.5PBG24DH8SC1AB	6.35 (161.4)	5.74 (145.9)	1.31 (33.2)	0.61 (15.5)
LED8.5PBG24DV8SC1AB	5.11 (130)	4.51 (114.5)	2.76 (70)	0.61 (15.5)
LED7PBG24QODIM8XXSUB	5.69 (144.5)	5.09 (129)	1.36 (34.5)	0.61 (15.5)
LED9.5PBG24QODIM8XXSUB	6.87 (174.5)	6.26 (159)	1.36 (34.5)	0.61 (15.5)
LED7PBG24D08XXAB	5.69 (144.5)	5.09 (129)	1.36 (34.5)	0.61 (15.5)
LED9PBG24D08XXAB	6.87 (174.5)	6.26 (159)	1.36 (34.5)	0.61 (15.5)
LED3.5PBG23H8XXAB	5.28 (134)	4.49 (114)	1.26 (32)	0.79 (20)
LED5.5PBGX23H8XXAB	7.05 (179)	6.26 (159)	1.26 (32)	0.79 (20)
LED3.5PB2G7H8XXBF	4.74 (120.4)	4.49 (114)	1.46 (37)	N/A
LED5.5PB2GX7H8XXBF	6.51 (165.4)	6.26 (159)	1.46 (37)	N/A
LED5.5PBGX2308SC16AB	4.96 (126)	4.35 (110.5)	1.36 (34.5)	0.61 (15.5)
LED5.5PBG24D08SC16AB	5.06 (128.5)	4.45 (113)	1.36 (34.5)	0.61 (15.5)
LED9PBG24QODIM8SC1AB	6.87 (174.5)	6.26 (159)	1.36 (34.5)	0.61 (15.5)
LED9PBG24D08SC16AB	6.87 (174.5)	6.26 (159)	1.36 (34.5)	0.61 (15.5)
LED3.5PBG23H8SC16AB	5.28 (134)	4.49 (114)	1.26 (32)	0.79 (20)
LED5.5PBGX23H8SC16AB	7.05 (179)	6.26 (159)	1.26 (32)	0.79 (20)
LED15PBGX24D08SC8BF	6.29 (159.9)	5.68 (144.4)	2.01 (51.1)	0.61 (15.5)
LED17PBGX24D08SC8BF	6.69 (169.9)	6.08 (154.4)	2.01 (51.1)	0.61 (15.5)

## Physical Information

### 7W Omnidirectional SubstiTUBE® and DUALescent™

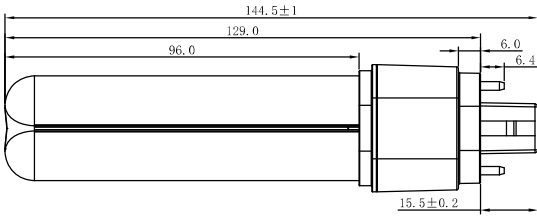

### DUALescent UL Type A+B Base – G24d

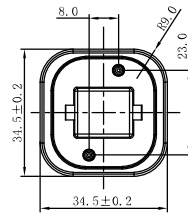

### 9W Omnidirectional SubstiTUBE and DUALescent

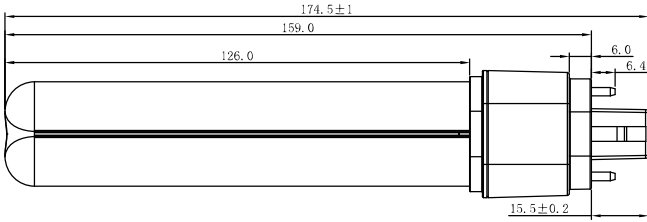

### SubstiTUBE UL Type A Base – G24q

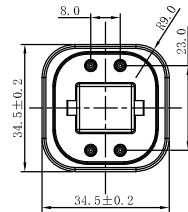

G24Q (41711-41714) or G24D (41719-41722)



G24Q (41715-41718) or G24D (41723-41726)

### CCT Selectable UL Type A SubstiTUBE and UL Type A+B DUALescent Horizontal

#### Front View

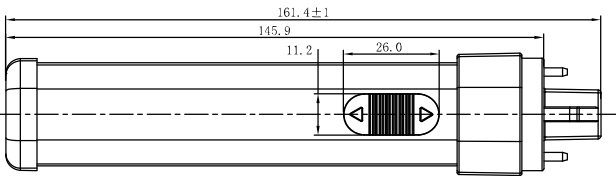

#### Side View

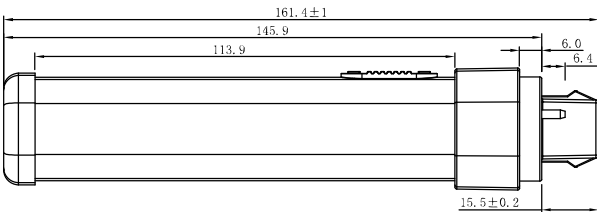

Dimensions in mm

### DUALescent UL Type A+B Base – G24d

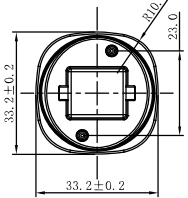

#### Rotatable Base

### SubstiTUBE UL Type A Base – G24q

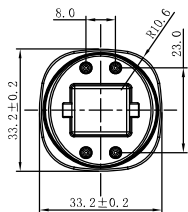

#### Rotatable Base



G24D (41691)



G24Q (41701)

Dimensions in mm

**Physical Information (continued)**

**CCT Selectable UL Type A SubstiTUBE® and UL Type A+B DUALescent™ Vertical**

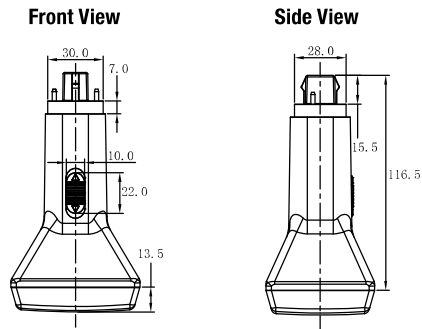

**DUALescent UL Type A+B Base – G24d**

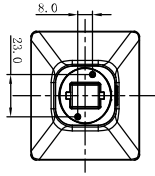

**SubstiTUBE UL Type A Base – G24q**

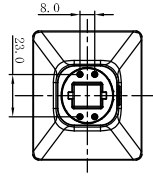

**G24Q (41702) or G24D (41692)**

**High Output UL Type A SubstiTUBE and UL Type B LEDlescent™ Horizontal**

**Front View**

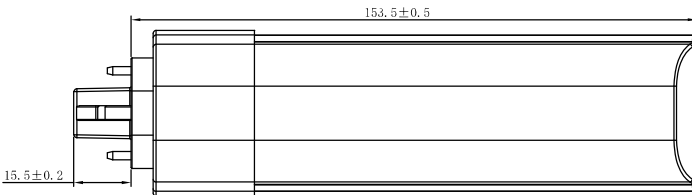

**High Output SubstiTUBE UL Type A and LEDlescent UL Type B Horizontal**

**Side View**

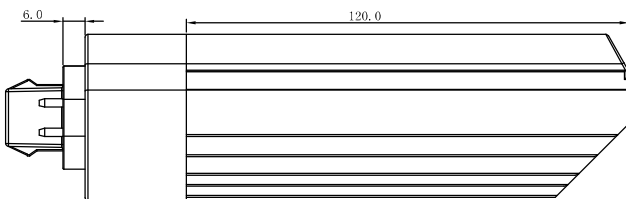

**LEDlescent UL Type B Base – G24d**

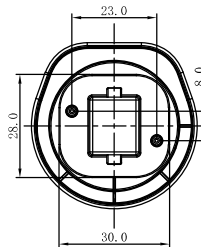

**Rotatable Base**

**SubstiTUBE UL Type A Base – G24q**

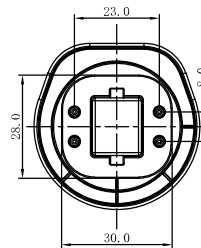

**Rotatable Base**



**G24Q (41705, 41707, 41709) or G24D (41695, 41697, 41699)**

**High Output SubstiTUBE UL Type A and LEDlescent UL Type B Vertical**

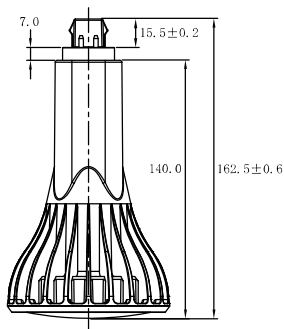

**LEDlescent UL Type B Base – G24d**

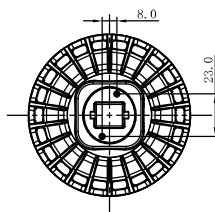

**SubstiTUBE UL Type A Base – G24q**

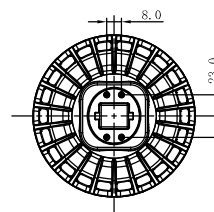

**G24Q (41706, 41708, 417010) or G24D (41696, 41698, 41700)**

Dimensions in mm

**Physical Information (continued)**

**LEDlescent™ Ultra Thin for 2G7**

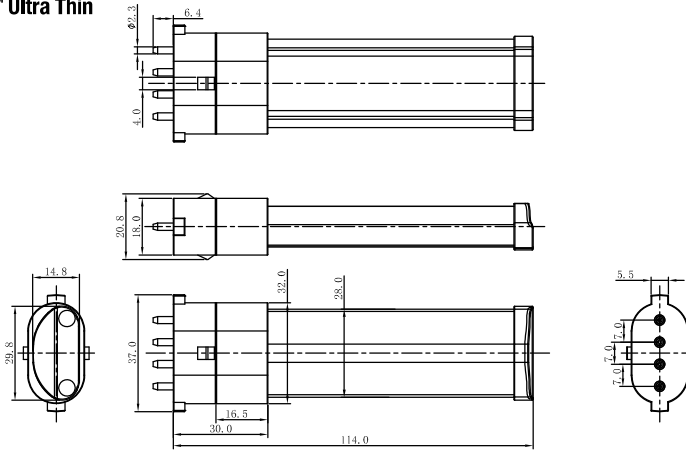

**LEDlescent UL Type B Base – 2G7**



**LEDlescent Ultra Thin for 2GX7**

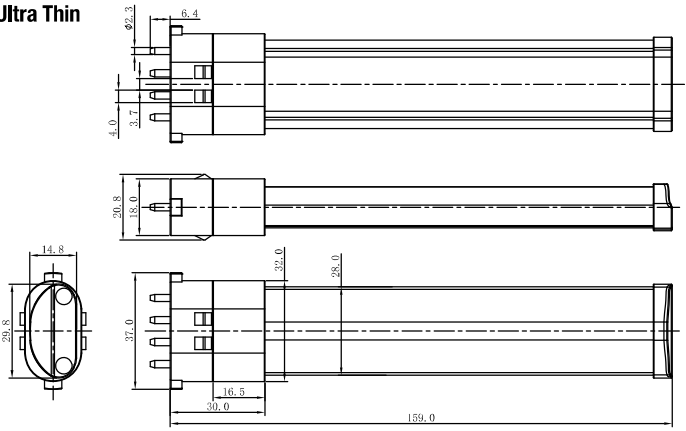

**LEDlescent UL Type B Base – 2GX7**



**DUALescent™ Ultra Thin for G23**

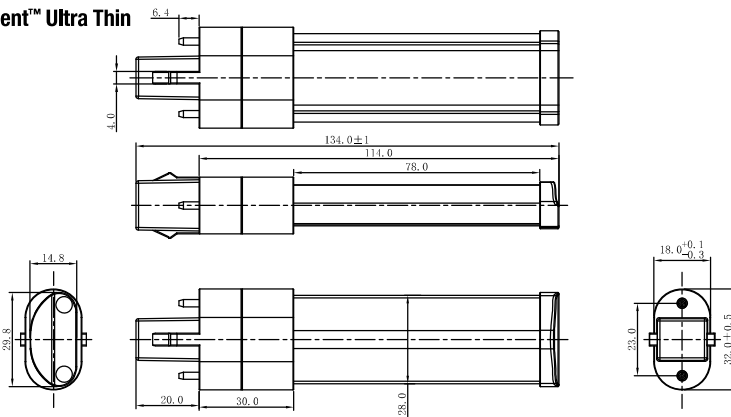

**DUALescent UL Type A+B Base – G23**



**DUALescent Ultra Thin for GX23**

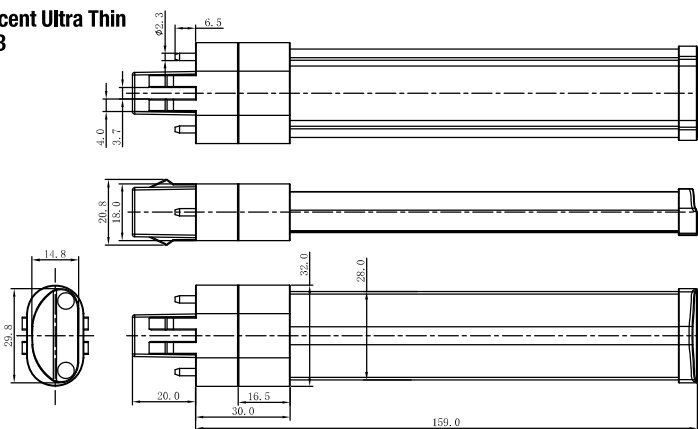

**DUALescent UL Type A+B Base – GX23**

Dimensions in mm

**Physical Information (continued)**

**DUALescent™ CCT Select Omnidirectional 5.5W**

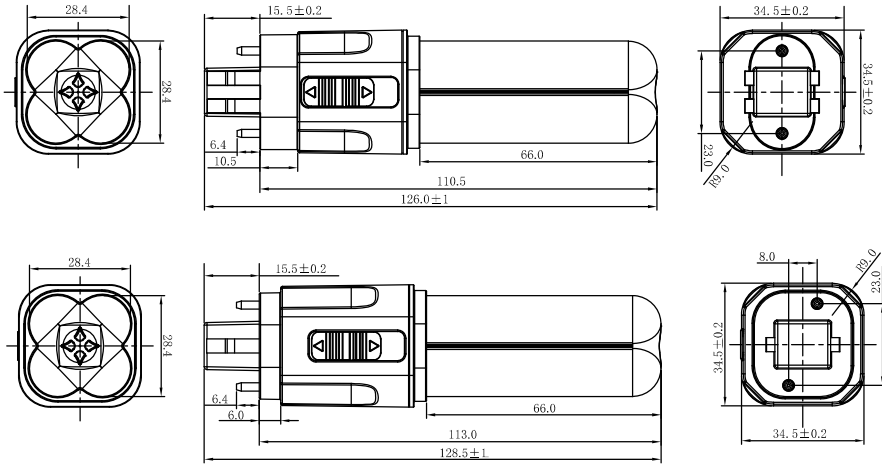

**GX23 (42503) or  
G24D (42504)**

**DUALescent CCT Select Omnidirectional 9.5W**

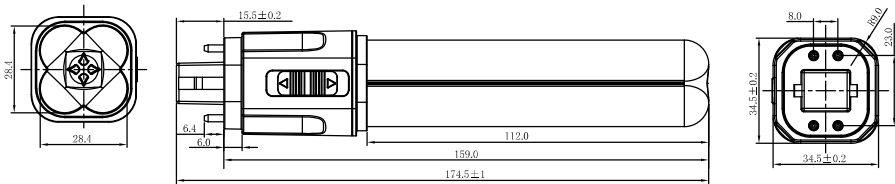

**G24Q (42507) or  
G24D (42508)**

**DUALescent CCT Select Ultra Thin 3.5W**

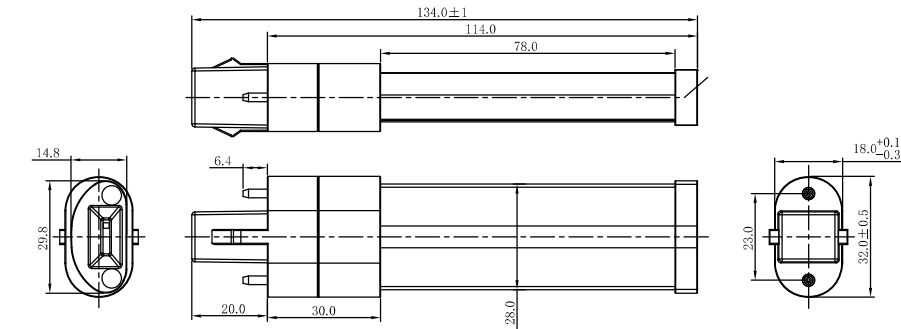

**G23 (42509)**

**GX23 (42510)**

**DUALescent CCT Select Ultra Thin 5.5W**

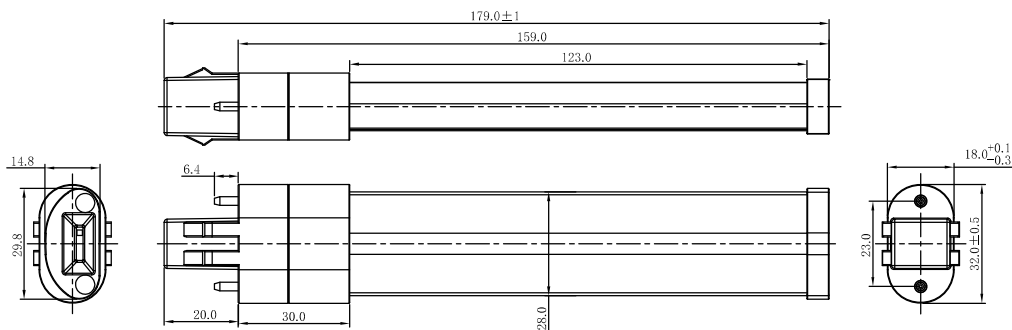

**CCT Selector  
Switch  
(42509-42510)**

Dimensions in mm

**Physical Information (continued)**

**LEDlescent™ CCT Select Omnidirectional 15W**

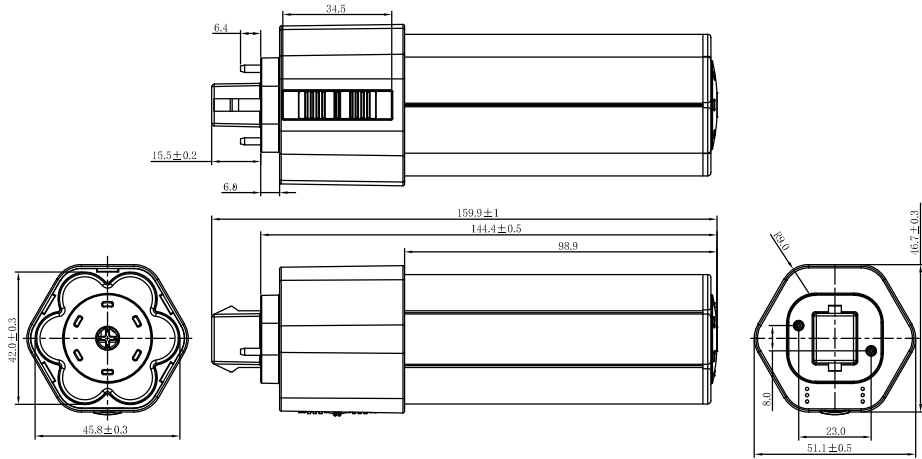

**GX24D (42505)**

**LEDlescent CCT Select Omnidirectional 17W**

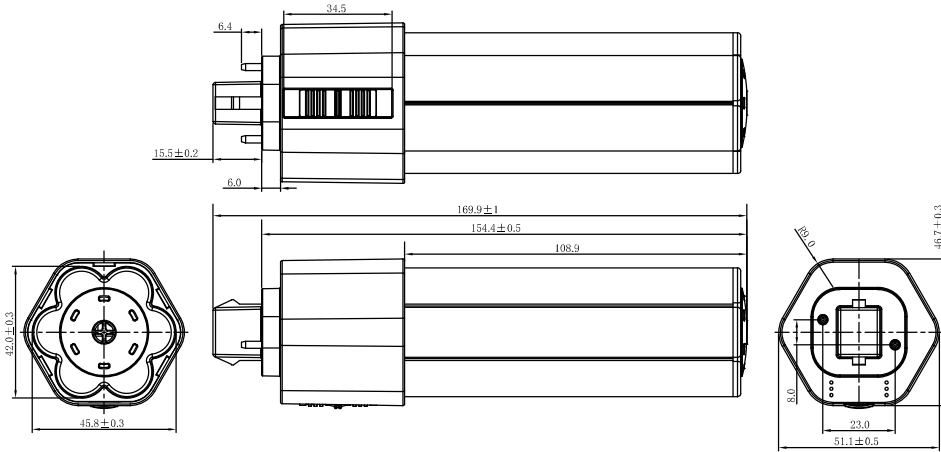

**GX24D (42506)**

Dimensions in mm

LEDVANCE LLC  
 181 Ballardvale Street, Suite 203  
 Wilmington, MA 01887 USA  
 Phone 1-800-LIGHTBULB (1-800-544-4828)  
[www.ledvanceUS.com](http://www.ledvanceUS.com)

SYLVANIA and LEDVANCE are registered trademarks.  
 All other trademarks are those of their respective owners.  
 Licensee of product trademark SYLVANIA in general lighting.  
 Specifications subject to change without notice.



SCAN TO FOLLOW US  
 ON SOCIAL MEDIA

