

PRODUCT SPECIFICATIONS / INFO



13353-N

UPC Code: 07847708480

Country of Origin: Please Contact Customer Service

Description

Medium Base, Bi-Pin, Standard Fluorescent Lampholder, Low Profile, Slide-On, Turn-Type, Captive Nut Screws Packed Bulk, Quickwire 18AWG Solid or Str Tinned - White Captive Nut Screws Packed Bulk

Color: White



Product Features

Lamp Base: Medium
 Lamp Contacts: Bi-Pin
 Style Name: Low Profile
 Mounting Type: Slide-On
 Panel Thickness: 18-20 Ga. Panel
 Contact Type: Turn-Type
 Termination: Quickwire 18AWG Solid or Str Tinned
 Feature: Captive Nut Screws Packed Bulk
 Rated Wattage: 660W
 Color: White
 Standards and Certifications: UL/CSA/NOM
 Warranty: 1 Year Limited
 Notes: Captive Nut Screws Packed Bulk
 Availability: Distribution

Electrical Specifications	
Voltage	600 Volt
Rated Wattage	660W
Mechanical Specifications	
Mounting Type	Slide-On
Panel Thickness	18-20 Ga. Panel
Contact Type	Turn-Type
Termination	Quickwire 18AWG Solid or Str Tinned
Wire Strip Length	3/8 Inch

Material Specifications	
Body Material	Thermoplastic
Contact Material	Copper-Alloy
Nut	6-32 Zinc-Plated
Screw	6-32 X 3/8 Zinc-Plated
Color	White
Availability	Distribution
Standards and Certifications	
UL Listed	File E5833
CSA Certified	File LR-5863
NOM Certified	057

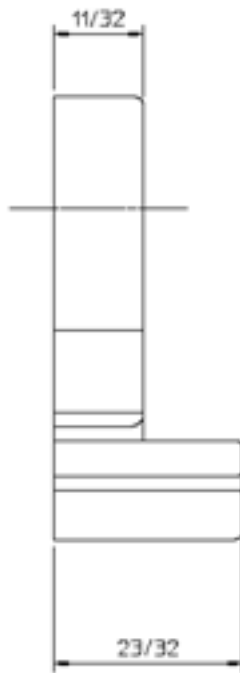

0.062 MARKING
(TO IDENTIFY
BODY WITH
#18 GA. SLOTS)

CAPTIVE NUT
TAPPED 6-32

