



# MASTER MHN-LA

MASTER MHN-LA 2000W/842 400V XWH

Compact quartz metal halide lamps with double-pin

## Product data

### • General Information

Cap base	X528 [ X528]
Bulb shape	TD40 [ TD 40mm]
Operating position	P5 [ Parallel +/-5D or Horizontal(HOR)]
Life to 5% failures (nom.)	4500 h
Life to 10% failures (nom.)	6000 h
Life to 20% failures (nom.)	8500 h
Life to 50% failures (nom.)	13000 h

### • Light Technical

Luminous flux (rated) (min.)	200000 lm
Luminous flux (rated) (nom.)	220000 lm
Colour designation	Cool White (CW)
Lumen maintenance 1,000 hours (nom.)	94 %
Lumen maintenance 10,000 hours (nom.)	63 %
Lumen maintenance 2,000 hours (nom.)	89 %
Lumen maintenance 5,000 hours (nom.)	76 %
Chromaticity coordinate X (nom.)	370
Chromaticity coordinate Y (nom.)	370
Correlated colour temperature (nom.)	4200 K
Luminous efficacy (rated) (nom.)	108 lm/W

Color rendering index (nom.) 72

### • Operating and Electrical

Lamp supply voltage	400 V [ 400]
Power (Rated) (Nom)	2000 W
Lamp current run-up (max.)	15 A
Lamp current (EM) (nom.)	9.6 A
Ignition supply voltage (min.)	342 V
Voltage (Max)	245 V
Voltage (Min)	220 V
Voltage (Nom)	235 V

### • Controls and Dimming

Dimmable no

### • Mechanical and Housing

Bulb finish	Clear (CL)
Cap base information	Cable (C)

### • Approval and Application

Energy efficiency label (EEL)	A+
Mercury (Hg) content (nom.)	185 mg
Energy Consumption kWh/1000 h	2244 kWh

# PHILIPS

# MASTER MHN-LA

## • UV

Specific eff. radiant power 280 mW/klm

## • Luminaire Design Requirements

Bulb temperature (max.) 920 °C  
Pinch temperature (max.) 350 °C

## • Product Data

Full product code 871150020074700

Order product name MASTER MHN-LA 2000W/842 400V XWH  
EAN/UPC – product 8718291548201  
Order code 20074700  
Local Code 2000MHNLA842  
Numerator – quantity per pack 1  
Numerator – packs per outer box 1  
Material no. (12NC) 928071305130  
Net weight (piece) 172.000 g  
ILCOS Code MN-2000-E-K-/H

## Warnings and Safety

- Use only in totally enclosed luminaire, even during testing (IEC61167, IEC 62035, IEC60598)
- The luminaire must be able to contain hot lamp parts if the lamp ruptures

- A lamp breaking is extremely unlikely to have any impact on your health. If a lamp breaks, ventilate the room for 30 minutes and remove the parts, preferably with gloves. Put them in a sealed plastic bag and take it to your local waste facilities for recycling. Do not use a vacuum cleaner.

## Dimensional drawing

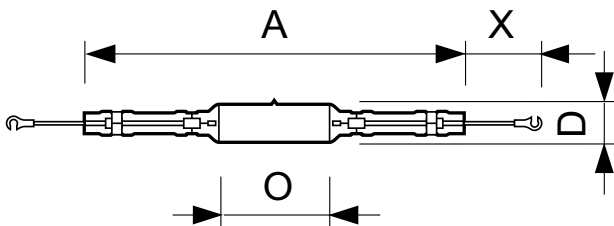

MHN-LA, 1000W/2000W

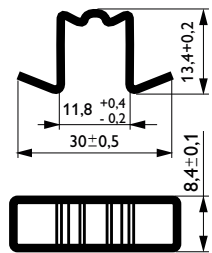

## MHN-LA 2000W/842 400V XWH

Product	D	O	X	A
MASTER MHN-LA 2000W/842 400V XWH	40 mm	108 mm	58 mm	353 mm

## Photometric data

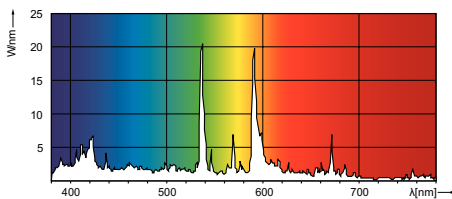



© 2016 Philips Lighting Holding B.V.  
All rights reserved.

Specifications are subject to change without notice. Trademarks are the property of Koninklijke Philips N.V. (Royal Philips) or their respective owners.

[www.philips.com/lighting](http://www.philips.com/lighting)

2016, March 7  
data subject to change