

LTR	REVISION	DATE	APPD
-	RELEASED	06-25-13	

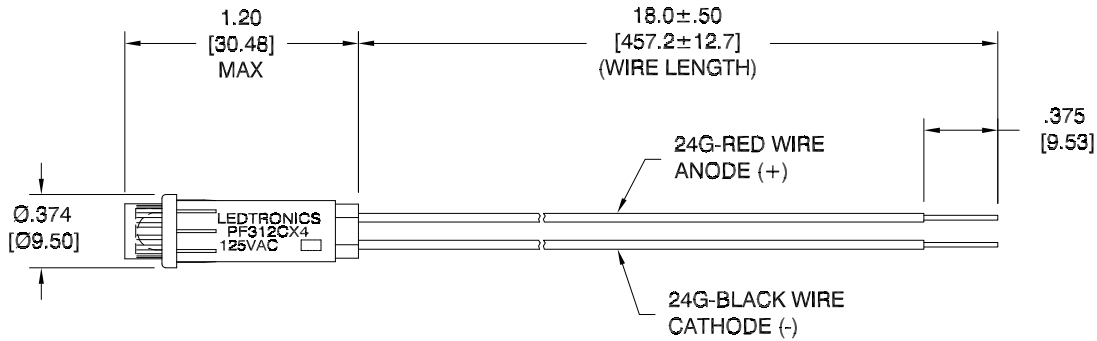

SN312 MOUNTING CLIP

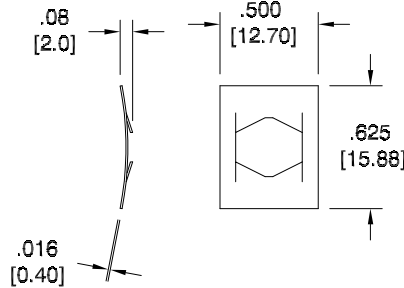

NOTES:

1. ALL DIMENSIONS ARE IN INCHES [MILLIMETERS].
2. MOUNTING DIAMETER: Ø5/16" [8mm]
3. LENS MATERIAL: LEXAN 101-112
4. SLEEVE MATERIAL: NYLON 66 (UL94V-1 MINIMUM, UL94V-0 PREFERRED)
5. MOUNTING CLIP MATERIAL: STEEL



REVISION NOTIFICATION	
<input type="checkbox"/>	PMA
<input type="checkbox"/>	UL/ETL
<input type="checkbox"/>	MADE IN USA
<input type="checkbox"/>	CUSTOMER _____
<input type="checkbox"/>	OTHER

ELECTRO-OPTICAL CHARACTERISTICS

PF312CG4-0001	PF312CG4-125VAC/5-B/W18	HI-EFF GREEN	125VAC	0.005-0.006 A	563
PF312CO4-0001	PF312CO4-125VAC/5-B/W18	ORANGE	125VAC	0.005-0.006 A	600
PF312CR4-0001	PF312CR4-125VAC/5-B/W18	HI-EFF RED	125VAC	0.005-0.006 A	643
LEDTRONICS PART NO.	DESCRIPTION PART NO.	COLOR EMITTED	INPUT VOLTAGE, V	CURRENT (A)	λ P nm



-PROPRIETARY-
 This document contains Proprietary information of LEDTRONICS, INC. It may not be copied, used or disclosed for any purpose without the prior express written consent of LEDTRONICS, INC.

.XXX ± .010 TOLERANCE PER ANSI-Y14.5 (UNLESS OTHERWISE STATED)
 .XX ± .025
 ANGLES ± 0°,30'
 FRACT. ± 1/32

TITLE PF312CX4-0001 (PF312CX4-125VAC/5-B/W18)					
DWG NO	SCALE	SHEET	DATE		
PF312-125VAC	1:1	1 OF 1	06-25-13		
CODE IDENT NO.	DWG BY	CHK BY	QA	MFG	R&D
8Z410	GP 06-25-13				BJ 06-25-13