



HID ignitors for series systems

SND 58 220-240V 50/60Hz

HID ignitors for series systems

Product data

General Information	
Application Code	58
Lamp Type	SON/CDM/MH/HPI/HPA
Number of Lamps	1 piece/unit
Operating and Electrical	
Input Voltage	220 to 240 V
Input Frequency	50 to 60 Hz
Igniton Type	Semi-Parallel
Ignition Attempts	3
Ignition Time (Max)	1185 s
Ignition Voltage (Max)	5.0 kV
Ignition Voltage (Min)	2.8 kV
Response Voltage	195 V
Mains Voltage Performance (AC)	-8% - +6%
Mains Voltage Safety (AC)	-10% - +10%
Power Losses (Nom)	1.0 W
Wiring	
Ballast Contact Wire Cross Section	0.70-2.50 mm ²
Connector Type	Screw
System characteristics	
Rated Ballast-Lamp Power	35-600 W

Temperature	
T-Ambient (Max)	85 °C
T-Ambient (Min)	-20 °C
T-Case Maximum (Max)	90 °C
Mechanical and Housing	
Housing	SNI-85
Approval and Application	
Approval Marks	CE marking ENEC certificate
Product Data	
Full product code	871150093068230
Order product name	SND 58 220-240V 50/60Hz
EAN/UPC - Product	8711500930682
Order code	913700185166
Numerator - Quantity Per Pack	1
Numerator - Packs per outer box	48
Material Nr. (12NC)	913700185166
Net Weight (Piece)	0.050 kg

HID ignitors for series systems

Dimensional drawing

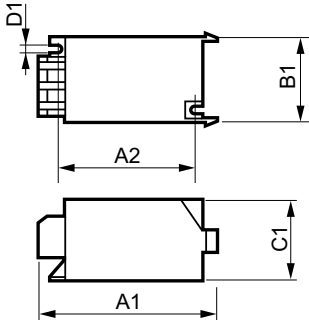

Product	D1	C1	A1	A2	B1
SND 58 220-240V 50/60Hz	4.3 mm	38.5 mm	84.5 mm	65.0 mm	41.5 mm

SND 58 220-240V 50/60Hz

