

JUNO[®]

Project: _____

Fixture Type: _____

Location: _____

Contact/Phone: _____

TRAC-MASTER[®]

 Avant Garde
CYLINDRA™ 15W LED

T254L G2

PRODUCT DESCRIPTION

The Cylindra™ 15W LED approximates the light output and distribution of 90W PAR30 halogen lamps in a PAR30 size fixture, utilizing approximately 1/6 of the energy and having a rated life of 50,000 hours. Available in 2700K, 3000K, 3500K and 4000K color temperatures with a minimum 80 CRI. Optional high CRI versions are available with a minimum 90 CRI and R9 greater than 50. There are also optional SpectralWhite color/white enhancing versions which offer minimum 90 CRI while rendering colors richly and making whites appear naturally brilliant. The contemporary styling of the Cylindra LED enables it to subtly enhance practically any decor without diverting attention from the surrounding environment. Soft curved surfaces combine with clean, crisp edges to provide a uniquely attractive aesthetic. Cylindra's integral, bayonet-mounted accessory holder accommodates up to two accessories if desired.



Cylindra 15W LED

Construction Die cast aluminum housing provides outstanding thermal management of LED, yielding 70% average lumen maintenance at 50,000 hours of operation • Fashionable, elegant design complements any decor • Available in white, black and silver painted finishes.

LED High performance LED array provides outstanding reliability, performance and color quality/ consistency • 2700K, 3000K, 3500K or 4000K white phosphor high performance LEDs • Chromaticity range within a 3-step MacAdam Ellipse • 80 CRI minimum on standard product • Optional high CRI versions offer 90 CRI minimum • Optional SpectralWhite color/white enhancing versions are available which make whites appear naturally brilliant and render colors more richly.

Driver Concealed in rear housing to minimize overall fixture footprint • Provides quiet operation with or without dimming • Dimmable using high quality, factory-approved reverse phase ELV dimmers – see [T254LG2-DIM](#) • Solid state electronic, Class 2 compliant • Integral overcurrent and short circuit protection • Designed for greater than 50,000 hour operating life • FCC Certified to Part 15 Class B EMI standards.

Optics Interchangeable computer-designed custom faceted reflectors available in three factory configured beam spreads • One reflector provided with fixture (as specified in catalog number) • Accessory reflectors available to enable beam changes in the field • Beam patterns can be altered as desired using a variety of available light control accessories.

Juno Universal Track Adapter Universally compatible with both Trac-Master 1-circuit or 2-circuit track, Trac-Lites track, monopoints and special mountings • Also UL Recognized for use on ConTech® LT Series track • Copper alloy contacts provide precise spring action - no arcing and will not take a set • True, positive electrical ground • On/off switch included • Patented embossed polarity arrows on bottom of adapter • Spring-loaded positive latch with embossed polarity arrows secures track fixture to track • Two-position power contact provided for two-circuit application.

Alternate TEK Track Adapter Compatible with Juno TEK track system • System specific and assembled to track fixture • Integrally polarized construction to prevent reverse installation – only allows insertion in proper orientation • Rotary circuit selector enables simple switching between circuits • Integral on/off switch enables individual fixtures to be switched for servicing.

Alternate GTYPE Track Adapter Compatible with track systems based on GES type track, including Lithonia LT Commercial Track (not LTS type) • System specific and assembled to track fixture • Consult factory for additional information.

Alternate HTYPE Track Adapter Compatible with track systems which use a H-type track adapter, including Lithonia LTS Decorative Track (not LT type) • System specific and assembled to track fixture • Two-position power contact provided for two-circuit application • Consult factory for additional information.

Alternate LTYPE Track Adapter Compatible with track systems which use a L-type track adapter • System specific and assembled to track fixture • Two-position power contact provided for two-circuit application • Consult factory for additional information.

Accessory Holder Integral to fixture design • Die cast aluminum construction • Precision bayonet mounting • Accommodates up to two accessories if desired.

Aiming 360° horizontal coverage • 105° vertical aiming capability.

Labels UL and C-UL Listed • ENERGY STAR® certified • DesignLights Consortium® qualified where noted in Performance Data • Union made • Assembled in U.S.A.

Buy American Act This product is assembled in the USA and meets the Buy America(n) government procurement requirements under FAR, DFARS and DOT regulations. Please refer to www.acuitybrands.com/buy-american for additional information.

Warranty 5-year limited warranty. This is the only warranty provided and no other statements in this specification sheet create any warranty of any kind. All other express and implied warranties are disclaimed. Complete warranty terms located at: www.acuitybrands.com/support/warranty/terms-and-conditions

Note: Actual performance may differ as a result of end-user environment and application. All values are design or typical values, measured under laboratory conditions at 25 °C. Specifications subject to change without notice.

ConTech is a registered trademark of ConTech Lighting.



One Lithonia Way • Conyers, GA 30012 • Phone 1-800-705-SERV (7378) • Visit us at www.acuitybrands.com/juno-trac
 Printed in U.S.A. © 2017-2023 Acuity Brands Lighting, Inc. Rev. 09/19/23

TRAC-MASTER®

Avant Garde
CYLINDRA™ 15W LED
T254L G2

ORDERING INFORMATION

Ordering Example: T254L G2 27K 90CRI PDIM SP BL

Series	Mounting Adapter Type	Generation	Color Temperature	Color Rendering Index	Dimming Compatibility	Distribution	Finish	
T254L 15W Cylindra LED	(Blank)	Juno Universal Track Adapter	G2 Gen 2	27K 2700K	80CRI 80 CRI 90CRI 90 CRI SPW ² SpectralWhite	PDIM Phase Dimmable	BL Black	
	TEK	TEK 120V Track Adapter		30K 3000K			NFL Narrow Flood	SL Silver
	GTYPE	G-Type Track Adapter		35K 3500K			FL Flood	WH White
	HTYPE	H-Type Track Adapter		40K 4000K				
	LTYPE	L-Type Track Adapter						

Accessories							
HCLBL 375	Hexcell Louver - Black	TBDR BLCK 375	Barn Doors - Black	DIFF 375	Diffusion Lens	TR2 SPT	Reflector – Spot
CCLBL 375	Cube Cell Louver - Black	CGF 375	Color Glass Filter	SOLITE 375	Uniformity Lens (Solite)	TR2 NFDL	Reflector – Narrow Flood
SNOOTBL 375	Snoot - Black	DGF 375	Dichroic Glass Filter	PRISM 375	Prismatic Spread Lens	TR2 FLD	Reflector – Flood
EYEBROWBL 375	Eyebrow - Black	UVF 375	UV Filter	LSPREAD 375	Linear Spread Lens		
				T40N ¹	Monopoint Canopy		

See specification sheet [D1.2.2](#) for details and color filter options.Other accessories can be found on specification sheet [D1.2.0](#).

Notes:

- 1 Add finish code to complete catalog number (Example: T40N WH).
- 2 3000K and 3500K only.

TRAC-MASTER®

Avant Garde
CYLINDRA™ 15W LED
T254L G2

DIMENSIONS

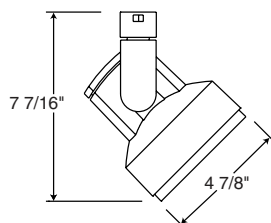

ELECTRICAL DATA

Input Voltage	120V
Input Current (max.)	0.13A
Power Factor	>0.92

PERFORMANCE DATA¹

Catalog Number	Voltage	Input Watts (Typical)	Lumens	Efficacy (LPW)	Rated Life (Hours)	DLC Standard	DLC Premium
T254L G2 27K 80CRI SP	120V	15.2	1429	94	50,000		x
T254L G2 27K 80CRI NFL	120V	15.2	1477	97	50,000		x
T254L G2 27K 80CRI FL	120V	15.2	1504	99	50,000		x
T254L G2 27K 90CRI SP	120V	15.2	1164	77	50,000	x	
T254L G2 27K 90CRI NFL	120V	15.2	1203	79	50,000	x	
T254L G2 27K 90CRI FL	120V	15.2	1225	81	50,000	x	
T254L G2 30K 80CRI SP	120V	15.2	1473	97	50,000		x
T254L G2 30K 80CRI NFL	120V	15.2	1523	100	50,000		x
T254L G2 30K 80CRI FL	120V	15.2	1551	102	50,000		x
T254L G2 30K 90CRI SP	120V	15.2	1208	79	50,000	x	
T254L G2 30K 90CRI NFL	120V	15.2	1249	82	50,000	x	
T254L G2 30K 90CRI FL	120V	15.2	1272	84	50,000	x	
T254L G2 30K SPW SP	120V	15.2	1282	84	50,000		
T254L G2 30K SPW NFL	120V	15.2	1325	87	50,000		
T254L G2 30K SPW FL	120V	15.2	1349	89	50,000		
T254L G2 35K 80CRI SP	120V	15.2	1517	100	50,000		x
T254L G2 35K 80CRI NFL	120V	15.2	1569	103	50,000		x
T254L G2 35K 80CRI FL	120V	15.2	1598	105	50,000		x
T254L G2 35K 90CRI SP	120V	15.2	1252	82	50,000	x	
T254L G2 35K 90CRI NFL	120V	15.2	1295	85	50,000	x	
T254L G2 35K 90CRI FL	120V	15.2	1318	87	50,000	x	
T254L G2 35K SPW SP	120V	15.2	1311	86	50,000		
T254L G2 35K SPW NFL	120V	15.2	1355	89	50,000		
T254L G2 35K SPW FL	120V	15.2	1380	91	50,000		
T254L G2 40K 80CRI SP	120V	15.2	1517	100	50,000		x
T254L G2 40K 80CRI NFL	120V	15.2	1569	103	50,000		x
T254L G2 40K 80CRI FL	120V	15.2	1598	105	50,000		x
T254L G2 40K 90CRI SP	120V	15.2	1282	84	50,000	x	
T254L G2 40K 90CRI NFL	120V	15.2	1325	87	50,000	x	
T254L G2 40K 90CRI FL	120V	15.2	1349	89	50,000	x	

Notes:

¹ Performance data, including Rated Life, is based on measurements of an individual fixture operating in a 25°C ambient.

TRAC-MASTER®

Avant Garde

CYLINDRA™ 15W LED

T254L G2

CBCP • Centerbeam candlepower
FC • Footcandles at beam center (aim point)

In vertical aiming applications, aim point (X) is determined by dividing distance from the wall (D) by the tangent of the desired aim angle (A) (0.5774 for 30°, 1.0 for 45°, 1.732 for 60°).

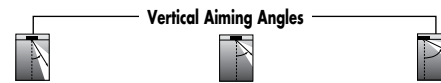
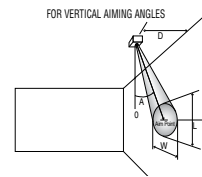
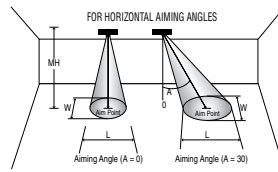

Lamp	Beam Type	Beam Spread°	Rated Life	CBCP	0°			30°			30°			45°			60°								
					MH	FC	L	W	FC	L	W	D	FC	X	L	W	FC	X	L	W	D	FC	X	L	W
Cylindra 15W LED 3000K, 80CRI Spot	SP	12°	50000	21510	10	215	2.0	2.0	140	2.7	2.3	4	168	6.9	3.3	1.6	475	4.0	1.6	1.1	8	218	4.6	2.2	1.9
					12	149	2.4	2.4	97	3.2	2.8	6	75	10.4	5.0	2.4	211	6.0	2.4	1.7	10	140	5.8	2.7	2.3
					14	110	2.8	2.8	71	3.8	3.3	8	42	13.9	6.6	3.2	119	8.0	3.3	2.3	12	97	6.9	3.2	2.8
					16	84	3.2	3.2	55	4.3	3.7	10	27	17.3	8.3	4.0	76	10.0	4.1	2.8	14	71	8.1	3.8	3.3
					18	66	3.6	3.6	43	4.8	4.2	12	19	20.8	10.0	4.8	53	12.0	4.9	3.4	16	55	9.2	4.3	3.7
Cylindra 15W LED 3000K, 80CRI Narrow Flood	NFL	24°	50000	5856	4	366	1.7	1.7	238	2.3	1.9	2	183	3.5	3.9	1.7	518	2.0	1.8	1.2	4	238	2.3	2.3	1.9
					6	163	2.5	2.5	106	3.4	2.9	3	81	5.2	5.8	2.5	230	3.0	2.6	1.8	5	152	2.9	2.8	2.4
					8	92	3.4	3.4	59	4.5	3.9	4	46	6.9	7.7	3.4	129	4.0	3.5	2.4	6	106	3.5	3.4	2.9
					10	59	4.2	4.2	38	5.7	4.8	5	29	8.7	9.7	4.2	83	5.0	4.4	3.0	7	78	4.0	4.0	3.4
					12	41	5.0	5.0	26	6.8	5.8	6	20	10.4	11.6	5.0	58	6.0	5.3	3.6	8	59	4.6	4.5	3.9
Cylindra 15W LED 3000K, 80CRI Flood	FL	44°	50000	2889	3	321	2.4	2.4	208	3.4	2.8	1	361	1.7	6.1	1.6	1021	1.0	1.9	1.1	3	208	1.7	3.4	2.8
					4	181	3.2	3.2	117	4.5	3.7	2	90	3.5	12.2	3.2	255	2.0	3.8	2.3	4	117	2.3	4.5	3.7
					5	116	4.0	4.0	75	5.6	4.6	3	40	5.2	18.3	4.8	113	3.0	5.7	3.4	5	75	2.9	5.6	4.6
					6	80	4.8	4.8	52	6.7	5.5	4	23	6.9	24.4	6.4	64	4.0	7.6	4.5	6	52	3.5	6.7	5.5
					7	59	5.6	5.6	38	7.9	6.4	5	14	8.7	**	8.0	41	5.0	9.5	5.6	7	38	4.0	7.9	6.4

For 27K 80CRI fixtures, use 0.97 multiplier; for 27K 90CRI fixtures, use 0.79 multiplier; for 30K 90CRI fixtures, use 0.82 multiplier; for 30K SPW fixtures, use 0.87 multiplier; for 35K 80CRI fixtures, use 1.03 multiplier; for 35K 90CRI fixtures, use 0.85 multiplier; for 35K SPW fixtures, use 0.89 multiplier; for 40K 80CRI fixtures, use 1.03 multiplier; for 40K 90CRI fixtures, use 0.87 multiplier.

**Due to steep aiming angle, length of beam extends beyond 25'.