



TRAC-MASTER®

Classics

43W FLAT BACK CYLINDER LED

Project: _____

Fixture Type: _____

Location: _____

Contact/Phone: _____



T286L

PRODUCT DESCRIPTION

With its integral driver, the cylindrical aesthetic of the T286L Series offers the simplest of form factors. It is designed with a unique, patented, precision optical system which produces the most uniform spot, narrow flood or flood beam distributions possible. The 43W T286L Series can deliver up to 3900 lumens, utilizing less than 1/3 of the energy of halogen equivalents and having a rated life of 50,000 hours. It is available in 2700K, 3000K, 3500K and 4000K color temperatures and 80 or 90 CRI versions. These fixtures also have an integral, bayonet-mounted optical system that enables quick conversion between beam spreads.



PRODUCT SPECIFICATIONS

Construction Die cast aluminum housing and vented concealed heat sink provides outstanding thermal management, yielding 70% average lumen maintenance at 50,000 hours of operation • Passively-cooled design – no moving parts to break or wear-out • Fashionable, elegant design complements any decor • Available in white, black or silver painted finishes.

LED High performance LED array provides outstanding reliability, performance and color quality/consistency • 2700K, 3000K, 3500K or 4000K white phosphor high performance LEDs • Chromaticity range within a 3-step MacAdam Ellipse • 80 CRI minimum on standard product • Optional high CRI versions offer 90 CRI minimum.

Driver Assembled into upper housing to visually integrate within fixture design • Insulating air gap between driver and LED light engine optimizes thermal operation • Provides quiet operation with or without dimming • 120V fixtures are dimmable using high quality reverse phase ELV dimmers approved by Juno - see [T286L-DIM](#) • Solid state electronic, Class 2 compliant • Integral overcurrent and short circuit protection • Class B FCC Part 15 rated.

Reflector Precision designed patented optical system provides either spot, narrow flood or flood beam distributions • Patented, multi-step optical system ensures a properly color-mixed beam • Accessory optical assemblies available to quickly and easily convert from one beam distribution to another in the field.

Accessories Filters and lenses may only be installed with Accessory Holder, Snoot or Barn Doors (order separately) • Louver may only be installed with Accessory Holder or Snoot (order separately) • Accessory Holder, Snoot or Barn Doors are externally mounted and attach to fixture using three set screws • Up to two of any combination of filters, lenses and louver may be installed simultaneously.

Juno Universal Track Adapter Universally compatible with both Trac-Master 1-circuit or 2-circuit track, Trac-Lites track, monopoints and special mountings • Also UL Recognized for use on ConTech® LT Series track • Copper alloy contacts provide precise spring action – no arcing and will not take a set • True, positive electrical ground • On/off switch included • Patented embossed polarity arrows on bottom of adapter • Spring-loaded positive latch with embossed polarity arrows secures track light to track • Two-position power contact provided for two-circuit application.

Alternate TEK/HTEK Track Adapter Compatible with either Juno TEK or HTEK track systems • System specific and assembled to track fixture • Integrally polarized construction to prevent reverse installation – only allows insertion in proper orientation • Rotary circuit selector enables simple switching between circuits • Integral on/off switch enables individual fixtures to be switched for servicing.

Alternate GTYPE Track Adapter Compatible with track systems based on GES type track, including Lithonia LT Commercial Track (not LTS type) • System specific and assembled to track fixture • Consult factory for additional information.

Alternate HTYPE Track Adapter Compatible with track systems which use a H-type track adapter, including Lithonia LTS Decorative Track (not LT type) • System specific and assembled to track fixture • Two-position power contact provided for two-circuit application • Consult factory for additional information.

Alternate LTYPE Track Adapter Compatible with track systems which use a L-type track adapter • System specific and assembled to track fixture • Two-position power contact provided for two-circuit application • Consult factory for additional information.

Aiming 360° horizontal coverage • Greater than 90° vertical aiming capability.

Labels UL and C-UL Listed • Union made • Assembled in U.S.A. • DesignLights Consortium® qualified where noted in Performance Data; HTEK option excluded.

Government Procurement

BAA – Buy America(n) Act: Product qualifies as a domestic end product under the Buy American Act as implemented in the FAR and DFARS. Product also qualifies as manufactured in the United States under DOT Buy America regulations.

BABA – Build America Buy America: Product qualifies as produced in the United States under the definitions of the Build America, Buy America Act.

Please refer to www.acuitybrands.com/buy-american for additional information.

Warranty 5-year limited warranty. This is the only warranty provided and no other statements in this specification sheet create any warranty of any kind. All other express and implied warranties are disclaimed. Complete warranty terms located at: www.acuitybrands.com/support/warranty/terms-and-conditions.

Note: Actual performance may differ as a result of end-user environment and application.

All values are design or typical values, measured under laboratory conditions at 25 °C.

Specifications subject to change without notice.

ConTech is a registered trademark of ConTech Lighting.



TRAC-MASTER®

Classics

43W FLAT BACK CYLINDER LED

T286L

ORDERING INFORMATION

Ordering Examples: T286L 30K 80CRI PDIM SP WH, T286L TEK 30K 90CRI PDIM SP BL

Series	Mounting Adapter Type	Color Temperature	Color Rendering Index	Dimming Compatibility
T286L 43W Flat Back Cylinder LED	(Blank) Juno Universal 120V Track Adapter	27K 2700K	80CRI 80 CRI	OFF ¹ On/Off (Non-Dimming) PDIM Phase Dimmable
	HTEK ¹ HTEK 277V Track Adapter	30K 3000K	90CRI 90 CRI	
	TEK TEK 120V Track Adapter	35K 3500K		
	GTYPE G-Type Track Adapter	40K 4000K		
	HTYPE H-Type Track Adapter			
	LTYPE L-Type Track Adapter			
See page 5 for Direct Canopy Mount Option (CPY) specifications.				

Distribution	Finish
SP Spot	BL Black
NFL Narrow Flood	SL Silver
FL Flood	WH White

Accessories (Order Separately)					
T770BL	4 ¹¹ / ₁₆ " Dia. Accessory Holder - Black	XBAFLBL 469 ²	Cross Baffle - Black	SOLITE 469 ²	Uniformity Lens (Solite)
T770SL	4 ¹¹ / ₁₆ " Dia. Accessory Holder - Silver	T5774BL 469	4 ¹¹ / ₁₆ " Dia. Barn Door Accessory - Black	PRISM 469 ²	Prismatic Spread Lens
T770WH	4 ¹¹ / ₁₆ " Dia. Accessory Holder - White	CGF 469 ²	Color Glass Filter	LSPREAD 469 ²	Linear Spread Lens
T5788BL 469	Snoot - Black	DGF 469 ²	Dichroic Glass Filter	TR10 SPT	Spot Optical Assembly
EYEBROWBL 469 ²	Eye Brow - Black	UVF 469 ²	UV Filter	TR10 NFLD	Narrow Flood Optical Assembly
HCLBL 469 ²	Hexcell Louver - Black	DIFF 469 ²	Diffusion Lens	TR10 FLD	Flood Optical Assembly
CCLBL 469 ²	Cube Cell Louver - Black			T40N ³	Monopoint Canopy

See specification sheet [D1.2.2](#) for details.Other accessories can be found on specification sheet [D1.2.0](#).

Notes:

- HTEK versions available with OFF option only, and OFF option only available with HTEK version only; HTEK option not qualified for DLC®.
- Accessory Holder, Snoot or Barn Doors required to install filters or lenses; Accessory Holder or Snoot required to install louver.
- Add finish code to complete catalog number (Example: T40N WH).

TRAC-MASTER®

Classics

43W FLAT BACK CYLINDER LED

T286L

DIMENSIONS

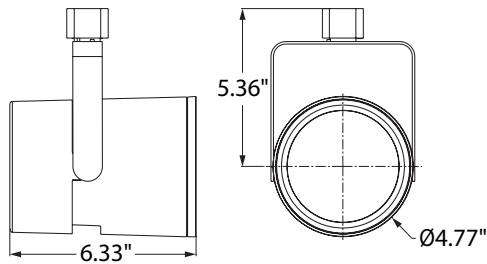

ELECTRICAL DATA

Input Voltage	120V	277V
Input Current (max.)	0.40A	0.17A
Power Factor	>0.99	>0.98
T.H.D.	<10%	<10%

PERFORMANCE DATA^{1,2}

Luminaire Catalog	Voltage	Input Wattage	Total Lumen Output	Lumens Per Watt	Rated Life	DLC
T286L G3 27K 80CRI SP	120V	42.8	3318	78	50,000	
T286L G3 27K 80CRI NFL	120V	42.8	3293	77	50,000	
T286L G3 27K 80CRI FL	120V	42.8	3586	84	50,000	X
T286L G3 27K 90CRI SP	120V	42.8	2930	68	50,000	
T286L G3 27K 90CRI NFL	120V	42.8	2908	68	50,000	
T286L G3 27K 90CRI FL	120V	42.8	3167	74	50,000	
T286L G3 30K 80CRI SP	120V	42.8	3435	80	50,000	X
T286L G3 30K 80CRI NFL	120V	42.8	3409	80	50,000	X
T286L G3 30K 80CRI FL	120V	42.8	3713	87	50,000	X
T286L G3 30K 90CRI SP	120V	42.8	3027	71	50,000	
T286L G3 30K 90CRI NFL	120V	42.8	3004	70	50,000	
T286L G3 30K 90CRI FL	120V	42.8	3271	76	50,000	
T286L G3 35K 80CRI SP	120V	42.8	3539	83	50,000	X
T286L G3 35K 80CRI NFL	120V	42.8	3512	82	50,000	X
T286L G3 35K 80CRI FL	120V	42.8	3825	89	50,000	X
T286L G3 35K 90CRI SP	120V	42.8	3124	73	50,000	
T286L G3 35K 90CRI NFL	120V	42.8	3100	72	50,000	
T286L G3 35K 90CRI FL	120V	42.8	3376	79	50,000	
T286L G3 40K 80CRI SP	120V	42.8	3609	84	50,000	X
T286L G3 40K 80CRI NFL	120V	42.8	3581	84	50,000	X
T286L G3 40K 80CRI FL	120V	42.8	3900	91	50,000	X
T286L G3 40K 90CRI SP	120V	42.8	3235	76	50,000	
T286L G3 40K 90CRI NFL	120V	42.8	3210	75	50,000	
T286L G3 40K 90CRI FL	120V	42.8	3496	82	50,000	X

Notes:

- Performance data, including Rated Life, is based on measurements of an individual fixture operating at 120V in a 25°C ambient.
- HTEK mounting option not qualified for DLC®.