

LTR	REVISION	DATE	APPD
A	052518-GP01: UPDATED TEST DATA	07-11-18	GP

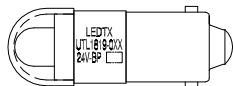

ACTUAL SIZE

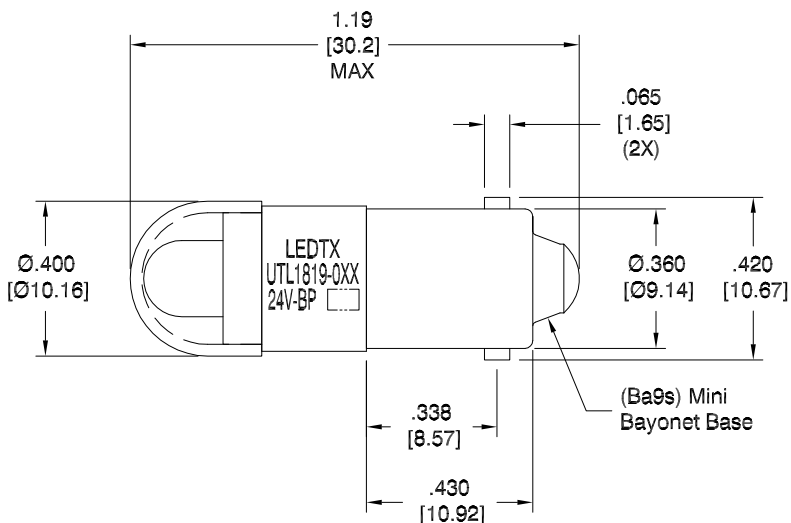

NOTES:

1. ALL DIMENSIONS ARE IN INCHES [MILLIMETERS].
2. LENS MATERIAL / COLOR: POLYCARBONATE-UV STABILIZED. (UL94V-2) / CLEAR
3. SLEEVE MATERIAL: GENERAL POLYMERS RYNITE FR530 (UL 94HB)
4. BASE MATERIAL: (BODY) BRASS & NICKEL PLATED BRASS (BARREL)

**FULL BEAM WIDTH @ 50% INTENSITY

REVISION NOTIFICATION	
<input type="checkbox"/>	DLC
<input type="checkbox"/>	UL/ETL
<input type="checkbox"/>	MADE IN USA
<input type="checkbox"/>	CUSTOMER _____
<input type="checkbox"/>	OTHER
REDLINE CHECKLIST	
<input type="checkbox"/>	REDLINE(YES)
<input type="checkbox"/>	DATE: _____
<input type="checkbox"/>	INITIATED BY: _____
<input type="checkbox"/>	ECR REQUIRED YES <input type="checkbox"/> NO <input type="checkbox"/>
<input type="checkbox"/>	WORK ORDER# _____

ELECTRICAL - OPTICAL CHARACTERISTICS (Ta = 25°C)

UTL1819-0AG	AQUA GREEN	24Vdc	0.31 W	0.013 A	7.150cd	522nm	26°
UTL1819-0CW	COOL WHITE	24Vdc	0.31 W	0.013 A	11.700cd	8000K	30°
UTL1819-0IW	WARM WHITE	24Vdc	0.31 W	0.013 A	5.200cd	3000K	37°
UTL1819-0UB	SUPER BLUE	24Vdc	0.31 W	0.013 A	1.950cd	463nm	25°
UTL1819-0UO	SUPER ORANGE	24Vdc	0.41 W	0.017 A	1.955cd	610nm	30°
UTL1819-0UR	SUPER RED	24Vdc	0.41 W	0.017 A	2.550cd	633nm	25°
UTL1819-0UY	SUPER YELLOW	24Vdc	0.41 W	0.017 A	4.420cd	593nm	20°
LEDTRONICS PART NO.	COLOR EMITTED	INPUT VOLTAGE, V	POWER (W)	CURRENT (A)	MAXIMUM CANDELA	VIEWING ANGLE**	
						λP nm	COLOR TEMP. (K)

 LEDTRONICS,™ INC. 23105 KASHIWA COURT TORRANCE, CA 90505	-PROPRIETARY- This document contains Proprietary information of LEDTRONICS,™ INC. It may not be copied, used or disclosed for any purpose without the prior express written consent of LEDTRONICS,™ INC.		TITLE UTL1819-0XX			
	.XXX ± .010 TOLERANCE PER ANSI-Y14.5 .XX ± .025 (UNLESS OTHERWISE STATED) ANGLES ± 0°,30' FRACT. ± 1/32		DWG NO	SCALE	SHEET	DATE
	UTL1819-CUST		2:1	1 OF 1	01-04-10	
CODE IDENT NO.	DWG BY GP	CHK BY	QA EE	MFG LD	R&D LUV	
8Z410	01-04-10		08-08-18	08-08-18	08-08-18	